

On-Line Sampling Valves for Process Equipment

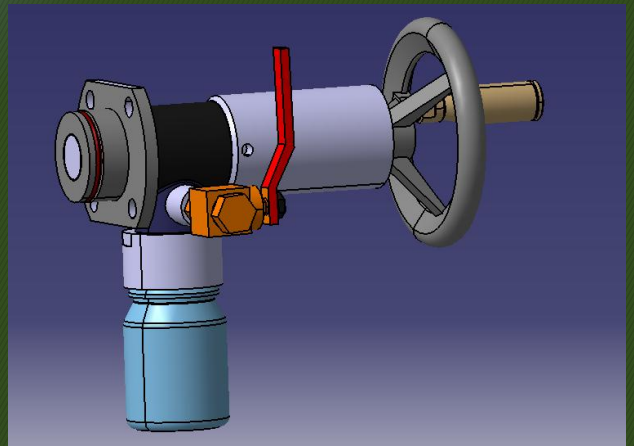
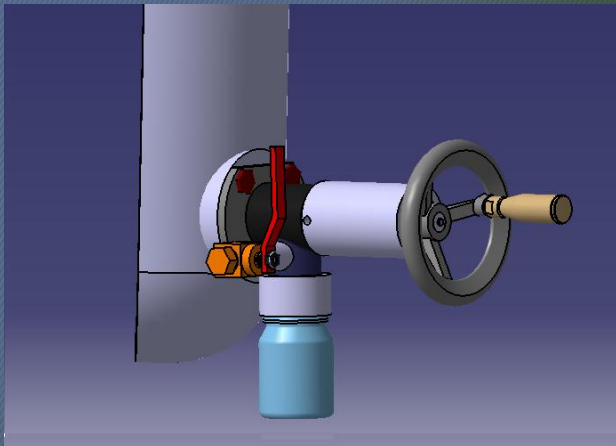

SEALWELL's in-house Designed & Developed ON-LINE Sampling Valve are suitable for use on all type of Mixers & Agitators viz. **Agitated Nutsche Filter Dryer (ANFD), Paddle Dryer (RVPD), Rotocone Dryer (RCVD), Nauta Dryer, etc.**

These valves can be used to draw Liquids, Powder & Paste from the Mixer/Agitator while it is in motion for testing & sampling.

These valves are designed mainly for Pharma Application suitable for Pressure ranging from F.V. to 8 Kg/Cm² & Temp.: -50 to 250 Deg. C.

They are available in MOC: SS 304, SS 304L, SS 316, SS 316L, HAST C-276 & HAST C-22.

Sealing Options available in FKM, PTFE, FEP(Viton), FEP (Silicon) & FFKM.

*****FDA Certificate can also be furnished for above sealing options on request.**

Apart from our Standard range we can also tailor make these valves to suit your design & application.

Sizes available are DN 25, DN 32, DN 40 & DN 50

****** To be discussed with us before placement of Order.***

Type: TSLV

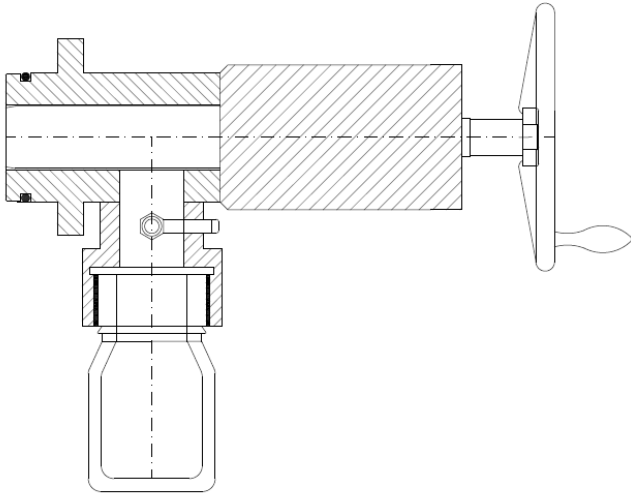

Purely suitable for liquid application where liquid flows freely in the Sampling Bottle by gravitational force. Very compact type of construction.

Type: YSLV

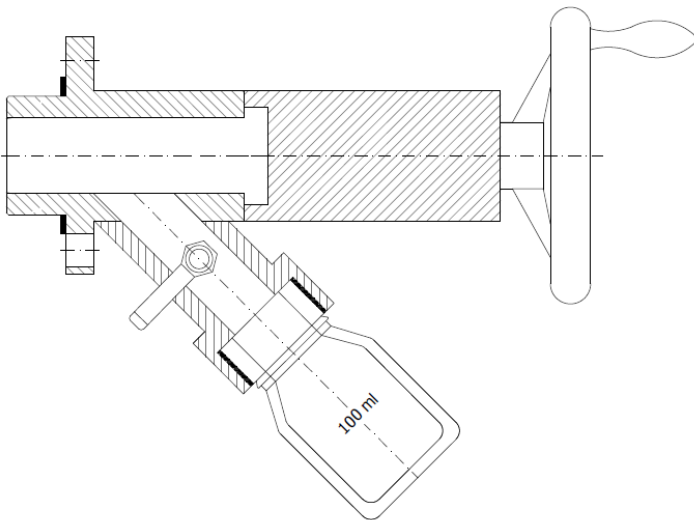

Most commonly used Sampling valve for Liquid/Powder. Sampling Bottle located at 45/60 Degree gives an added advantage for powder to flow freely in to the Sampling Bottle.

Apart from above types we also have Pneumatic Sampling Valves and PP Sampling Valves for corrosive application.

Please write to us on info@sealwellindia.net for more details.

Operation of Sampling Valve

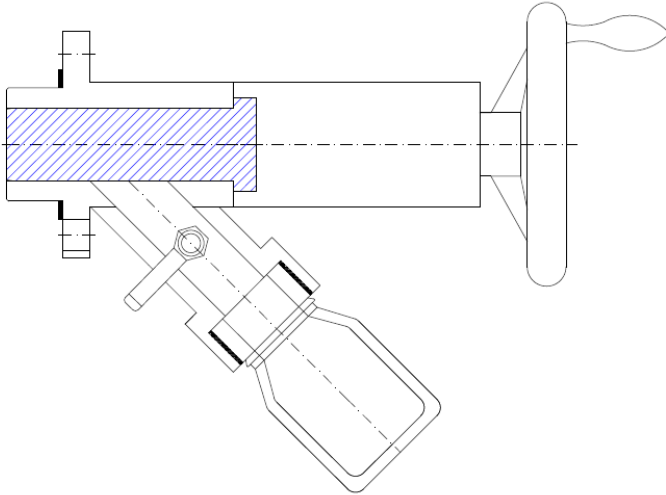

Closed Position:

The piston is a flush fit to the dryer leaving no dead space. A perfect seal is formed directly by the plunger against the body of the valve.

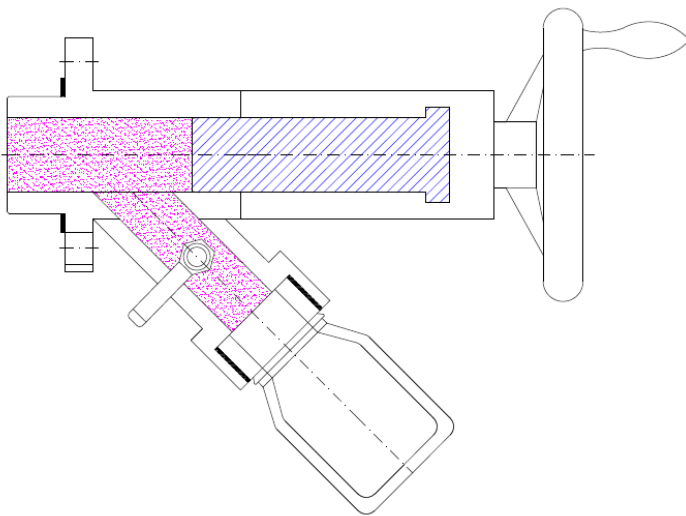

Sampling Position:

Turn the hand wheel counter clockwise to lower the plunger to its open position. While the product flows down through the discharge pipe by gravity or pressure, the operator can check the desired quantity of flow by adjusting the handle.

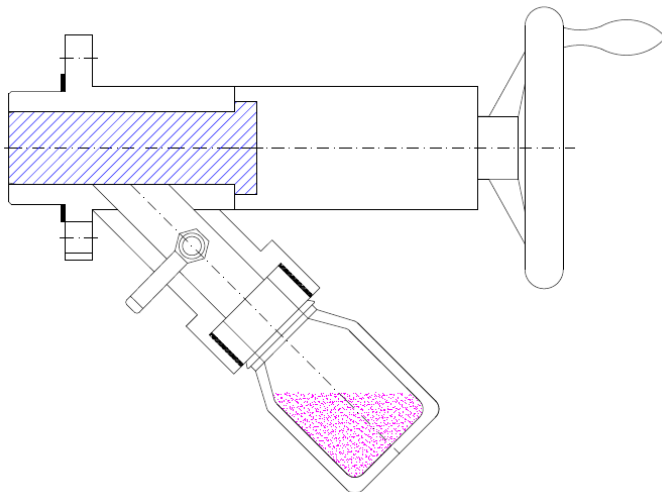

Closed Position:

Turn the hand wheel clockwise to bring back the plunger in its closed position. A firm final turn of the hand wheel will give reliable sealing and no dead space