

Silent Check Valve Bronze Seat & SS Seat

FIG. 5104
FIG. 5105

Specifications

- The design is for liquid service and offers many obvious advantages when compared with conventional swing check valve.
- Spring automatically closes disc at zero flow before flow reversal occurs. This prevents surge and water hammer.
- Completely guided disc both top and bottom.
- Perfect tightness soft sealed even at low differential pressure.
- Flanged and Drilling comply with EN1092-2 PN10/16, ANSI B 16.1 Class125 .
- Rated Working Pressure 16 bar, 250 psi.

Corrosion Protection

- Fusion Bonded Coating Interior and Exterior.

Material Specifications

Part	Material	EN Specification	ASTM Specification
Body	Gray Cast Iron	EN 1561 EN-GJL-250	A126 Class B
Seat	Stainless Steel	EN 10088 X5CrNi18-10	A351 Grade CF8
	Bronze	EN 1982 CuSn5Zn5Pb5	B62 C83600
Disc	Stainless Steel	EN 10088 X5CrNi18-10	A351 Grade CF8
	Bronze	EN 1982 CuSn5Zn5Pb5	B62 C83600
Spring	Stainless Steel	EN 10088 X5CrNi18-10	A276 Grade 304
Bushing	Bronze	EN 1982 CuSn5Zn5Pb5	B62 C83600
Seat O-Ring	Rubber	EN 681 EPDM/NBR	D2000 EPDM/NBR

- Valve Bodies of 25 bar / 300 psi, DN350 and larger sizes are Ductile Iron.

Options

- 25 bar /300 psi available.
- Ductile Iron Body.

Main Dimensions (mm)

Size	DN50	DN65	DN80	DN100	DN125	DN150	DN200	DN250	DN300	DN350	DN400
L	133	140	152	185	216	248	318	393	362	400	446

Schematic

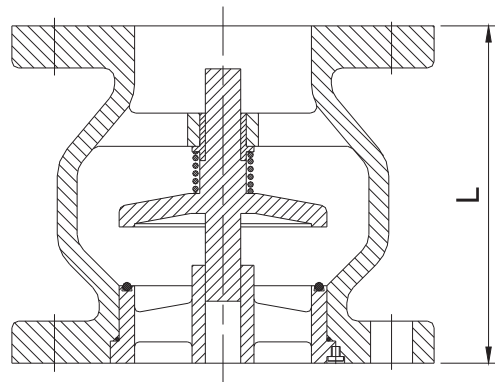
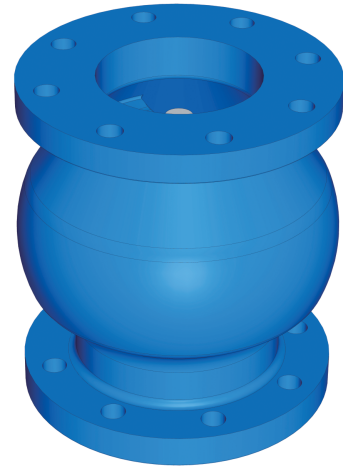

Notes

- Designs, materials and specifications shown are subject to change without notice due to the continuous development of our products.