

# WALWORTH PRESSURE SEAL GLOBE VALVES

Following table shows the most common bill of materials for a pressure seal globe valve. There are many other combinations of base material and trim, please refer to other sections of this catalog for additional information.

Regular Bill of Materials

No.	Description	1 1/4 % Chrome
1	"T" pattern body	ASTM A217 GR. WC6
2	Body inlay	SS-309
3	Segmental thrust ring	AISI 410
4	Spacer ring	AISI 410
5	Bonnet retainer	ASTM A-515 GR. 70
6	Seat ring	ASTM A-217 GR. WC6 & Co-Cr-W overlay
7	Bonnet	ASTM A-217 GR. WC6 or ASTM A182 GR. F11
8	Bonnet back seat	Integral (not shown)
9	Gasket	Mild steel (100 HB) silver plated
10	Packing	Flexible graphite intermediate rings / anti extrusion rings on top and bottom side of the packing chamber.
11	Gland bushing	ASTM A-276 GR. 410
12	Glang flange	ASTM A-216 GR. WCB
13	Guided plug	ASTM A-217 GR. WC6 or ASTM A182 GR. F11 & Co-Cr-W overlay
14	Disc nut	ASTM A 276-410
15	Yoke	ASTM A-216 GR. WCB
16	Stem	ASTM A-182 GR. F6A CL2
17	Stem guide	ASTM A-515 GR. 70
18	Stem nut	ASTM B-148 C95600
19	Gland flange stud	ASTM A-193 GR. B7
20	Gland flange nut	ASTM A-194 GR. 2H
21	Bonnet studs	ASTM A-193 GR. B16 (not shown)
22	Stud nuts	ASTM A-194 GR. 7 (not shown)
23	Bearings	Commercial
24	Bearing cover	ASTM A-515 GR. 70
25	Bearing cover stud	ASTM A-193 GR. B7
26	Bearing cover stud nut	ASTM A-194 GR. 2H (not shown)
27	Yoke bolt	ASTM A-193 GR. B7
28	Yoke nuts	ASTM A-194 GR. 2H
29	Handwheel	Commercial
30	Handwheel nut	ASTM A-515 GR. 70

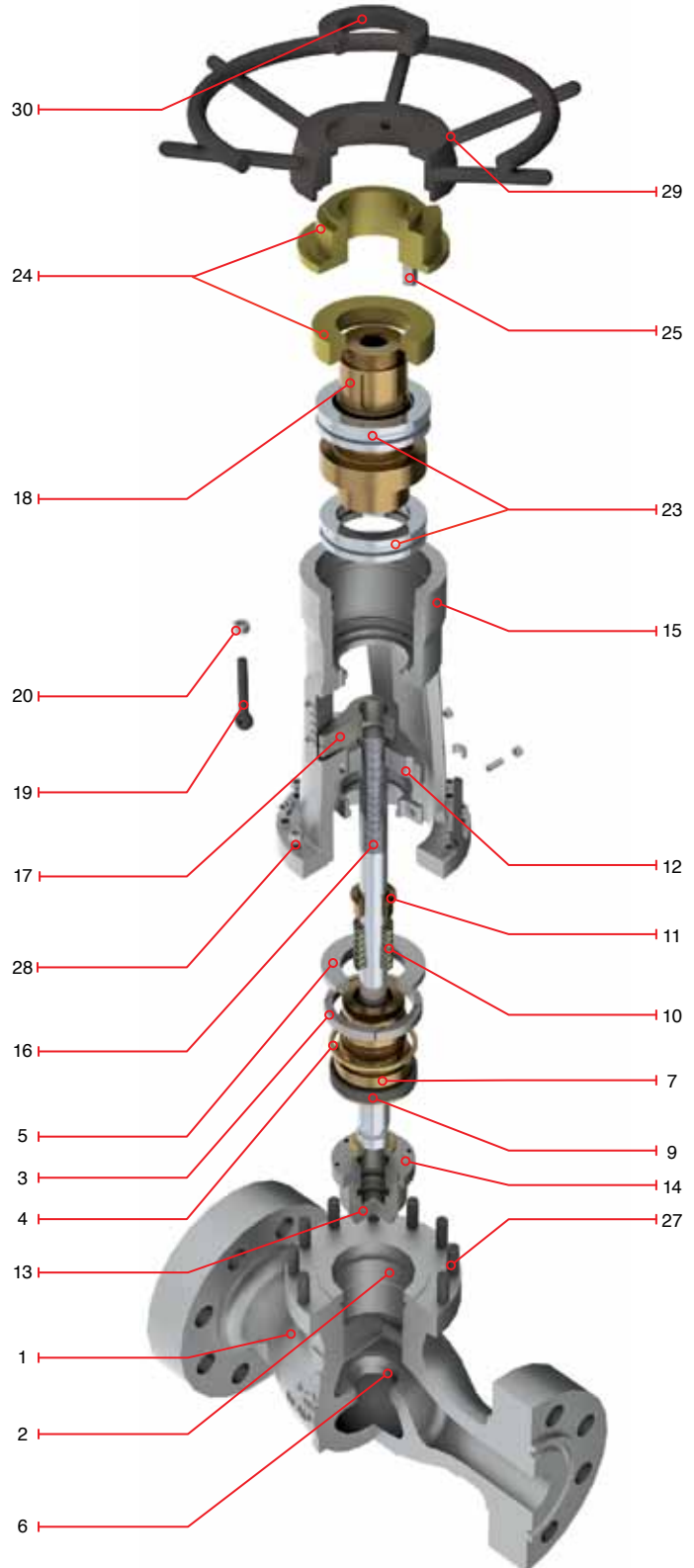

# WALWORTH PRESSURE SEAL GLOBE VALVES CLASS 600 (HANDWHEEL OPERATED)

## Design Features

- Design in accordance with ASME B16.34.
- WE short pattern; RF & RTJ long pattern as per ASME B16.10.
- Rising Stem.
- Guided plug type disc.
- From 2" to 3" handwheel operated.
- From 4" to 10" Impactor handwheel operated.
- End to end dimensions as per ASME B16.10.
- Flange dimensions as per ASME B16.5.
- Weld end dimensions as per ASME B16.25.



Catalog figure No.	ID plant figure No.	Type of ends
5295PSWE	5295PSWE	Buttweld
5295PSRF	5295PSF	Flanged raised face
5295PSRTJ	5295PSRJ	Flanged ring type joint

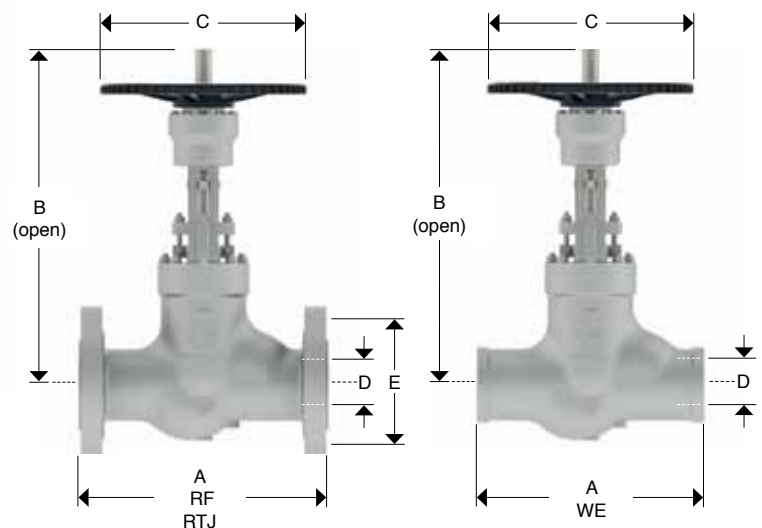

## Dimensions and Weights

D Nominal diameter		in	2	2.5	3	4	6	8	10
		mm	51	63	76	102	152	203	254
A	End to end WE	in	7	8.5	10	12	18	23	28
		mm	178	216	254	305	457	584	711
A	Face to face RF	in	11.5	13	14	17	22	26	31
		mm	292	330	356	432	559	660	787
A	Face to face RTJ	in	11.62	13.12	14.12	17.12	22.12	26.12	31.12
		mm	295	333	359	435	562	663	790
B	Center to top	in	23	23	25	28	33.5	44	49
		mm	584	584	635	711	851	1118	1245
C	Handwheel	in	12	12	12	14	18	20	24
		mm	305	305	305	356	457	508	610
WE	Weight	lbs	85.8	94.6	101.2	189.2	382.8	695.2	1174.8
		Kg	39	43	46	86	174	316	534
RF or RTJ	Weight	lbs	103.4	121	134.2	264	543.4	924	1529
		Kg	47	55	61	120	247	420	695
Cv	Flow coefficient		49.5	78.3	114.3	208.8	427.5	754.2	1174.5

# WALWORTH PRESSURE SEAL GLOBE VALVES CLASS 600 (GEAR OPERATED)



## Design Features

- Design in accordance with ASME B16.34.
- WE short pattern; RF & RTJ long pattern as per ASME B16.10.
- Rising Stem.
- Guided plug type disc.
- From 12" and up Gear Operated. operated.
- End to end dimensions as per ASME B16.10.
- Flange dimensions as per ASME B16.5.
- Weld end dimensions as per ASME B16.25.

Catalog figure No.	ID plant figure No.	Type of ends
5295PSWE	5295PSWE	Buttweld
5295PSRF	5295PSF	Flanged raised face
5295PSRTJ	5295PSRJ	Flanged ring type joint

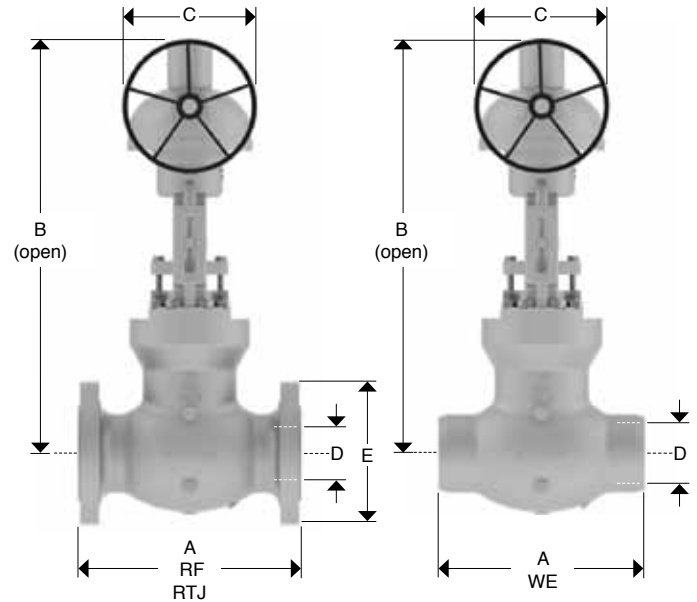

## Dimensions and Weights

D Nominal diameter		in	12	14	16	18	20	24
		mm	305	356	406	457	508	607
A	End to end WE	in	32	35	39	43	47	55
		mm	813	889	991	1092	1194	1397
A	Face to face RF	in	33	35	39	43	47	55
		mm	838	889	991	1092	1194	1397
A	Face to face RTJ	in	33.12	35.12	39.12	43.12	47.25	55.38
		mm	841	892	994	1095	1200	1407
B	Center to top (open)	in	53	62	70	78	85	93
		mm	1346	1575	1778	1981	2159	2362
C	Handwheel	in	30	30	34	34	38	38
		mm	762	762	864	864	965	965
WE	Weight	lbs	1885.4	2754.4	3546.4	4155.8	5816.8	7053.2
		Kg	857	1252	1612	1889	2644	3206
RF or RTJ	Weight	lbs	2314.4	3271.4	4276.8	5106.2	7040	8802.2
		Kg	1052	1487	1944	2321	3200	4001
Cv	Flow coefficient		1731.6	2096.1	PCR	PCR	PCR	PCR

PCR = Per customer request.

# WALWORTH PRESSURE SEAL GLOBE VALVES CLASS 900 (HANDWHEEL OPERATED)

## Design Features

- Design in accordance with ASME B16.34.
- WE short pattern; RF & RTJ long pattern as per ASME B16.10.
- Rising Stem.
- Guided plug type disc.
- From 2" to 3" handwheel operated.
- From 4" to 10" Impactor handwheel operated.
- End to end dimensions as per ASME B16.10.
- Flange dimensions as per ASME B16.5.
- Weld end dimensions as per ASME B16.25.



Catalog figure No.	ID plant figure No.	Type of ends
5301PSWE	5301PSWE	Buttweld
5301PSRF	5301PSF	Flanged raised face
5301PSRTJ	5301PSRJ	Flanged ring type joint

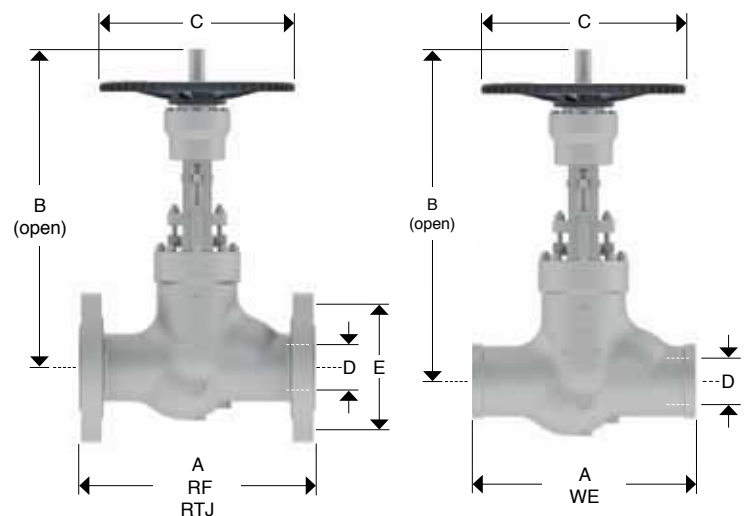

## Dimensions and Weights

D Nominal diameter		in	2	2.5	3	4	6	8	10
		mm	51	63	76	102	152	203	254
A	End to end WE	in	10	10	12	14	20	26	31
		mm	254	254	305	356	508	660	787
A	Face to face RF	in	14.5	16.5	15	18	24	29	33
		mm	368	419	381	457	610	737	838
A	Face to face RTJ	in	14.62	16.62	15.12	18.12	24.12	29.12	33.12
		mm	371	422	384	460	613	740	841
B	Center to top (open)	in	23	24	28	31	37	46	51
		mm	584	610	711	787	940	1168	1295
C	Handwheel	in	12	14	14	18	20	24	30
		mm	305	356	356	457	508	610	762
WE	Weight	lbs	96.8	125.4	136.4	228.8	677.6	1144	1650
		Kg	44	57	62	104	308	520	750
RF or RTJ	Weight	lbs	140.8	187	209	334.4	897.6	1487.2	2138.4
		Kg	64	85	95	152	408	676	972
Cv	Flow coefficient		41	63	93	173	392	681	1084

# WALWORTH PRESSURE SEAL GLOBE VALVES CLASS 900 (GEAR OPERATED)

## Design Features

- Design in accordance with ASME B16.34.
- WE short pattern; RF & RTJ long pattern as per ASME B16.10.
- Rising Stem.
- Guided plug type disc.
- From 12" and up Gear Operated. operated.
- End to end dimensions as per ASME B16.10.
- Flange dimensions as per ASME B16.5.
- Weld end dimensions as per ASME B16.25.



Catalog figure No.	ID plant figure No.	Type of ends
5301PSWE	5301PSWE	Buttweld
5301PSRF	5301PSF	Flanged raised face
5301PSRTJ	5301PSRJ	Flanged ring type joint

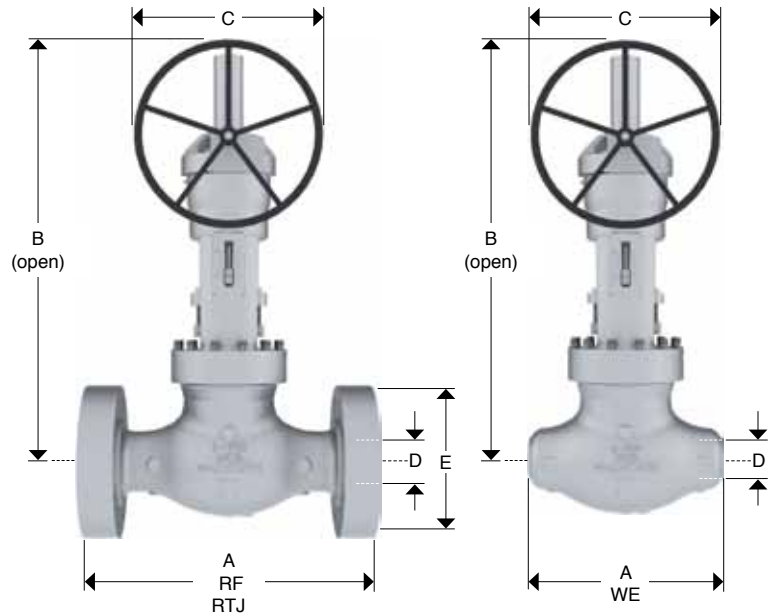

## Dimensions and Weights

D Nominal diameter		in	12	14	16	18	20	24
		mm	305	356	406	457	508	607
A	End to end WE	in	36	39	43	48	52	61
		mm	914	991	1092	1219	1321	1549
A	Face to face RF	in	38	40.5	44.5	48	52	61
		mm	965	1029	1130	1219	1321	1549
A	Face to face RTJ	in	38.12	40.88	44.88	48.5	52.5	61.75
		mm	968	1038	1140	1232	1334	1568
B	Center to top (open)	in	55	65	76	80	88	95
		mm	1397	1651	1930	2032	2235	2413
C	Handwheel	in	30	30	30	38	38	38
		mm	762	762	762	965	965	965
WE	Weight	lbs	2457.4	3418.8	4221.8	5176.6	7636.2	10289.4
		Kg	1117	1554	1919	2353	3471	4677
RF or RTJ	Weight	lbs	3108.6	4217.4	5139.2	6468	9218	13246.2
		Kg	1413	1917	2336	2940	4190	6021
Cv	Flow coefficient		1548	1890	PCR	PCR	PCR	PCR

PCR = Per customer request.



# WALWORTH PRESSURE SEAL GLOBE VALVES CLASS 1500 (HANDWHEEL)



## Design Features

- Design in accordance with ASME B16.34.
- WE short pattern; RF & RTJ long pattern as per ASME B16.10.
- Rising Stem.
- Guided plug type disc.
- From 2" to 3" handwheel operated.
- From 4" to 10" Impactor handwheel operated.
- End to end dimensions as per ASME B16.10.
- Flange dimensions as per ASME B16.5.
- Weld end dimensions as per ASME B16.25.

Catalog figure No.	ID plant figure No.	Type of ends
5308PSWE	5308PSWE	Buttweld
5308PSRF	5308PSF	Flanged raised face
5308PSRTJ	5308PSRJ	Flanged ring type joint

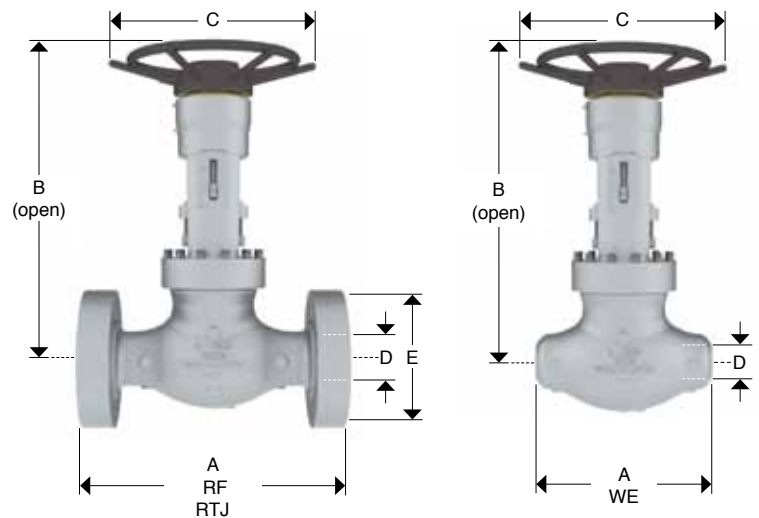

## Dimensions and Weights

D Nominal diameter		in	2	2.5	3	4	6	8	10
		mm	51	63	76	102	152	203	254
A	End to end WE	in	8.5	10	12	16	22	28	34
		mm	216	254	305	406	559	711	864
A	Face to face RF	in	14.5	16.5	18.5	21.5	27.75	32.75	39
		mm	368	419	470	546	705	832	991
A	Face to face RTJ	in	14.62	16.62	18.62	21.62	28	33.12	39.38
		mm	371	422	473	549	711	841	1000
B	Center to top (open)	in	23	24	28	31	37	47	52
		mm	584	610	711	787	940	1194	1321
C	Handwheel	in	12	14	14	18	20	24	30
		mm	305	356	356	457	508	610	762
WE	Weight	lbs	182.6	198	198	341	974.6	1623.6	3091
		Kg	83	90	90	155	443	738	1405
RF or RTJ	Weight	lbs	233.2	270.6	294.8	486.2	1304.6	2142.8	3962.2
		Kg	106	123	134	221	593	974	1801
Cv	Flow coefficient		41	59	85	151	342	589	938

# WALWORTH PRESSURE SEAL GLOBE VALVES CLASS 1500 (GEAR OPERATED)

## Design Features

- Design in accordance with ASME B16.34.
- WE short pattern; RF & RTJ long pattern as per ASME B16.10.
- Rising Stem.
- Guided plug type disc.
- From 12" and up Gear Operated. operated.
- End to end dimensions as per ASME B16.10.
- Flange dimensions as per ASME B16.5.
- Weld end dimensions as per ASME B16.25.



Catalog figure No.	ID plant figure No.	Type of ends
5308PSWE	5308PSWE	Buttweld
5308PSRF	5308PSF	Flanged raised face
5308PSRTJ	5308PSRJ	Flanged ring type joint

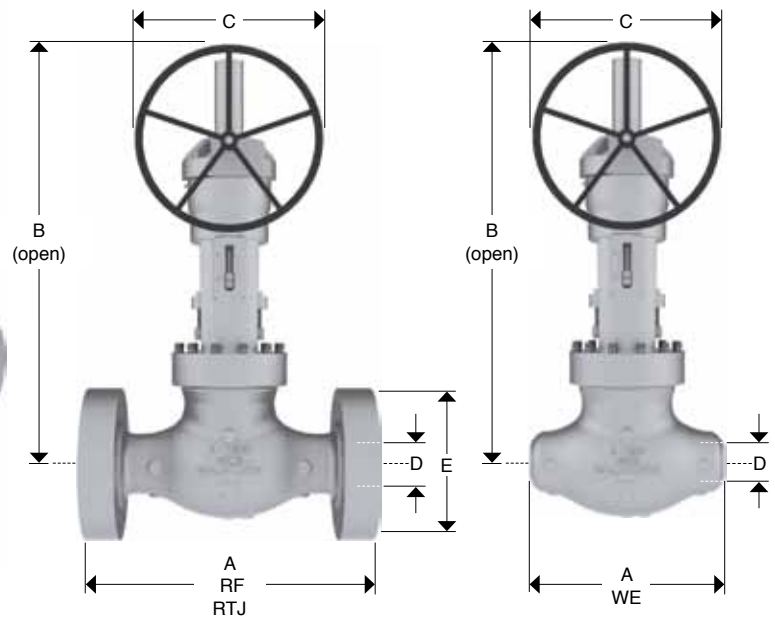

## Dimensions and Weights

D Nominal diameter		in	12	14	16	18	20	24
		mm	305	356	406	457	508	607
A	End to end WE	in	39	42	47	53	58	58
		mm	991	1067	1194	1346	1473	1473
A	Face to face RF	in	44.5	49.5	PCR	PCR	PCR	PCR
		mm	1130	1257	PCR	PCR	PCR	PCR
A	Face to face RTJ	in	45.12	50.25	PCR	PCR	PCR	PCR
		mm	1146	1276	PCR	PCR	PCR	PCR
B	Center to top (open)	in	58	65	76	80	88	95
		mm	1473	1651	1930	2032	2235	2413
C	Handwheel	in	30	30	38	38	38	38
		mm	762	762	965	965	965	965
WE	Weight	lbs	4741	6465.8	9446.8	11429	13745.6	17529.6
		Kg	2155	2939	4294	5195	6248	7968
RF or RTJ	Weight	lbs	6074.2	8344.6	11943.8	14676.2	17839.8	23172.6
		Kg	2761	3793	5429	6671	8109	10533
Cv	Flow coefficient		1339	PCR	PCR	PCR	PCR	PCR

PCR = Per customer request.

# WALWORTH PRESSURE SEAL GLOBE VALVES CLASS 2500 (GEAR OPERATED)



## Design Features

- in accordance with ASME B16.34.
- WE short pattern; RF & RTJ long pattern as per ASME B16.10.
- Rising Stem.
- Guided plug type disc.
- From 2" and up Gear Operated. operated.
- End to end dimensions as per ASME B16.10.
- Flange dimensions as per ASME B16.5.
- Weld end dimensions as per ASME B16.25.

Catalog figure No.	ID plant figure No.	Type of ends
5563PSWE	5563PSWE	Buttweld
5563PSRF	5563PSF	Flanged raised face
5563PSRTJ	5563PSRJ	Flanged ring type joint

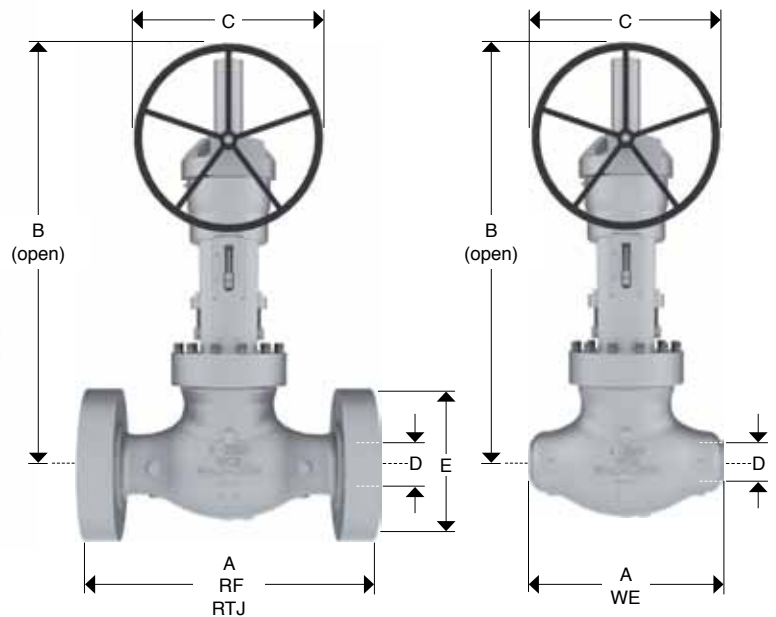

## Dimensions and Weights

D Nominal diameter		in	2	2.5	3	4	6	8	10	12	14	16	18	20	24
		mm	51	63	76	102	152	203	254	305	356	406	457	508	607
A	End to end WE	in	11	13	14.5	18	24	30	36	41	44	49	55	58	58
		mm	279	330	368	457	610	762	914	1041	1118	1245	1397	1473	1473
A	Face to face RF	in	17.75	20	22.75	26.5	36	40.25	50	56	PCR	PCR	PCR	PCR	PCR
		mm	451	508	578	673	914	1022	1270	1422	PCR	PCR	PCR	PCR	PCR
A	Face to face RTJ	in	17.87	20.25	23	26.88	36.5	40.87	50.88	56.88	PCR	PCR	PCR	PCR	PCR
		mm	454	514	584	683	927	1038	1292	1445	PCR	PCR	PCR	PCR	PCR
B	CENTER TO TOP	in	24	26	26	33	39	51	53	61	70	79	87	96	105
		mm	610	660	660	838	991	1295	1346	1549	1778	2007	2210	2438	2667
C	Handwheel	in	14	18	18	20	24	30	30	30	30	38	38	38	38
		mm	356	457	457	508	610	762	762	762	762	965	965	965	965
WE	Weight	lbs	255.2	514.8	514.8	629.2	1086.8	1601.6	2717	4061.2	7293	8294	10124.4	12058.2	15930.2
		Kg	116	234	234	286	494	728	1235	1846	3315	3770	4602	5481	7241
RF or RTJ	Weight	lbs	331.1	624.8	679.8	882.2	1507	2246.2	3685	5909.2	9889	PCR	PCR	PCR	PCR
		Kg	151	284	309	401	685	1021	1675	2686	4495	PCR	PCR	PCR	PCR
Cv	Flow coefficient		25	41	56	92	222	392	635	909	PCR	PCR	PCR	PCR	PCR

PCR = Per customer request.