

**INTEGRAL
FLANGED VALVES**

Typical gate valve shown.
Forged steel, outside screw
and yoke (OS&Y), rising
stem, non-rising handwheel.
Full or standard port. Bolted
or welded bonnet joint.
Integral backseat
Integral end flanges.

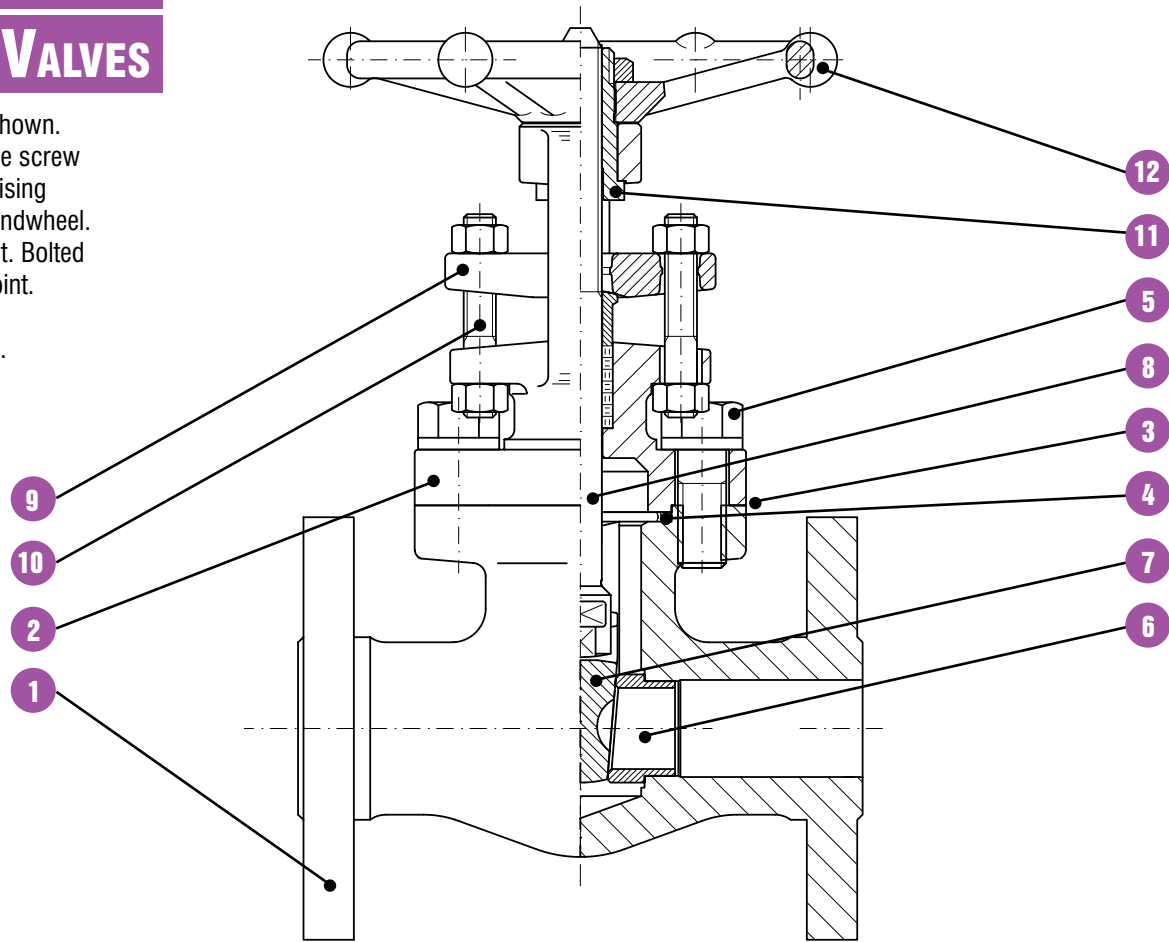

- 1. BODY.** The body is forged steel and designed to the basic dimensional requirements of the applicable specifications such as API 602, ASME B16.34, ASME B16.10 and ASME B16.5. The body is available in both the full or standard port design. End flanges are forged integral with the body.
- 2. BONNET.** The bonnet is forged steel, has an integral backseat and incorporates the stuffing box, which has dimensions per the applicable specifications such as API 602.
- 3. BODY-BONNET JOINT.** Two different bonnet joint designs are available. These are either the bolted bonnet or the threaded and seal welded type.
- 4. GASKET.** The bolted bonnet joint design valve uses a contained, controlled compression, spiral wound type gasket.
- 5. BONNET BOLTING.** The bonnet bolting is manufactured of alloy steel in accordance with the requirements of the applicable specifications such as API 602 and ASME B16.34.
- 6. SEAT RINGS.** The seat rings are steel and make up part of the valve trim. They are pressed into the valve body and wedged into place, forming a seal with the body. The seating surfaces are ground and lapped.
- 7. WEDGE.** The wedge, which is a solid design, is forged or investment cast steel and is part of the valve trim. The seating surfaces are ground and lapped.

- 8. STEM.** The stem is forged steel and part of the valve trim. It contains an integral back seat shoulder, which mates with the integral backseat of the bonnet. The stem is designed to the basic dimensional requirements of the applicable specifications such as API 602.
- 9. GLAND AND FLANGE.** The gland, gland flange assembly utilizes a separate, two piece design. This self aligning design allows the flange to be unevenly tightened while the gland maintains its parallel alignment with the stem and stuffing box.
- 10. GLAND BOLTS AND NUTS.** The steel/stainless steel gland bolt and nut assembly is a stud, double nut arrangement. This design allows complete removal from the valve when service is required. The use of industry standard thread full length studs and nuts also allows easy replacement should these items be lost or in need of replacement.
- 11. YOKE SLEEVE.** The yoke sleeve is of forged stainless steel material having a high melting point and is resistant to wear and corrosion.
- 12. HANDWHEEL.** The handwheel is forged carbon steel of an open spoke design. This robust construction along with appropriate sizing allows for ease of operation.

150 LB.
300 LB.

Design construction:
API 602 - ASME B16.34 - BS 5352
Testing according to API 598
Marking MSS SP25
Outside Screw and Yoke (OS&Y)
Self aligning two piece packing gland
Spiral-wound gasket
Integral backseat
Integral body flanges
Face to face according to ASME B16.10
Flanges according to ASME B16.5
Ratings:
-carbon steel class 150 285 psig@ 100°F
20 bar + 38°C
-carbon steel class 300 740 psig@ 100°F
51 bar + 38°C

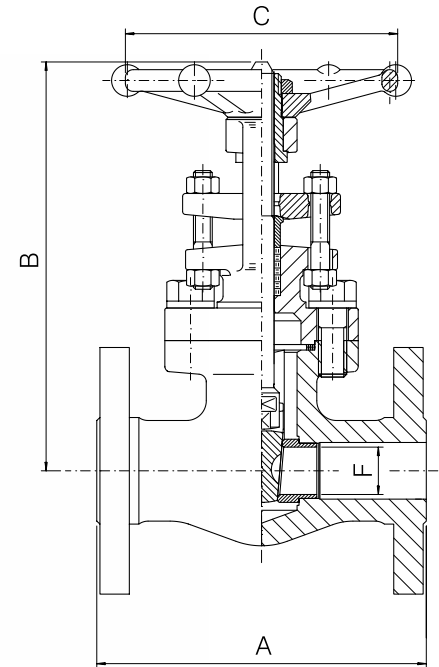

		FULL PORT – FIG. 1 10					
SIZE	inch	1/2	3/4	1	1 1/2	2	
	mm	15	20	25	40	50	
A	inch	4.25	4.62	5	6.50	7	
	mm	108	117,5	127	165	178	
B open	inch	6.88	8.26	9.05	11.41	13.39	
	mm	175	210	230	290	340	
C	inch	3.46	3.82	5.43	5.43	6.77	
	mm	88	97	138	138	172	
F	inch	.55	.71	.94	1.44	1.89	
	mm	14	18	24	36,6	48	
Weight	lb.	7	10.25	13.25	25	39.5	
	kg	3,2	4,7	6,1	11,4	18	
PACKING		BH2	BH4	BH5	BY5	BY7	
GASKET		G2	G3	G4	G7	G8	

		STANDARD PORT – FIG. L1 10						
SIZE	inch	1/2	3/4	1	1 1/2	2	3	
	mm	15	20	25	40	50	75	
A	inch	4.25	4.62	5	6.50	7	8	
	mm	108	117,5	127	165	178	203	
B open	inch	6.88	7.16	8.35	10.04	11.41	13.58	
	mm	175	182	212	255	290	345	
C	inch	3.46	3.46	3.82	5.43	5.43	6.77	
	mm	88	88	97	138	138	172	
F	inch	.38	.55	.71	1.18	1.44	1.89	
	mm	9,6	14	18	30	36,6	48	
Weight	lb.	6.25	8	11.25	21	29	46.75	
	kg	2,9	3,7	5,2	9,6	13,2	21,2	
PACKING		BH2	BH2	BH4	BH6	BY5	BH8	
GASKET		G2	G2	G3	G5	G7	G8	

		FULL PORT – FIG. 3 10					
SIZE	inch	1/2	3/4	1	1 1/2	2	
	mm	15	20	25	40	50	
A	inch	5.51	6	6.50	7.51	8.50	
	mm	140	152,5	165	191	216	
B open	inch	6.89	8.26	9.05	11.42	13.39	
	mm	175	210	230	290	340	
C	inch	3.46	3.82	5.43	5.43	6.77	
	mm	88	97	138	138	172	
F	inch	.55	.71	.94	1.44	1.89	
	mm	14	18	24	36,6	48	
Weight	lb.	8.25	12.25	15.5	29.75	41.75	
	kg	3,8	5,6	7,1	13,5	19	
PACKING		BH2	BH4	BH5	BY5	BY7	
GASKET		G2	G3	G4	G7	G8	

		STANDARD PORT – FIG. L3 10						
SIZE	inch	1/2	3/4	1	1 1/2	2		
	mm	15	20	25	40	50		
A	inch	5.51	6	6.50	7.51	8.5		
	mm	140	152,5	165	191	216		
B open	inch	6.89	7.17	8.35	9.84	11.42		
	mm	175	182	212	250	290		
C	inch	3.46	3.46	3.82	5.43	5.43		
	mm	88	88	97	138	138		
F	inch	.38	.55	.71	1.18	1.44		
	mm	9,6	14	18	30	36,6		
Weight	lb.	7.75	11.25	14.75	28.5	33.5		
	kg	3,6	5,2	6,7	13	15,3		
PACKING		BH2	BH2	BH4	BH6	BY5		
GASKET		G2	G2	G3	G5	G7		



INTEGRAL FLANGED VALVES- GATE TYPE- BOLTED BONNET- FULL & STANDARD PORT

600 LB.

Design construction:
 API 602 - ASME B16.34 - BS 5352
 Testing according to API 598
 Marking MSS SP25
 Outside Screw and Yoke (OS&Y)
 Self aligning two piece packing gland
 Spiral-wound gasket
 Integral backseat
 Integral body flanges
 Face to face according to ASME B16.10
 Flanges according to ASME B16.5
 Ratings:
 - carbon steel class 600 1480 psig @ 100°F
 102 bar + 38°C

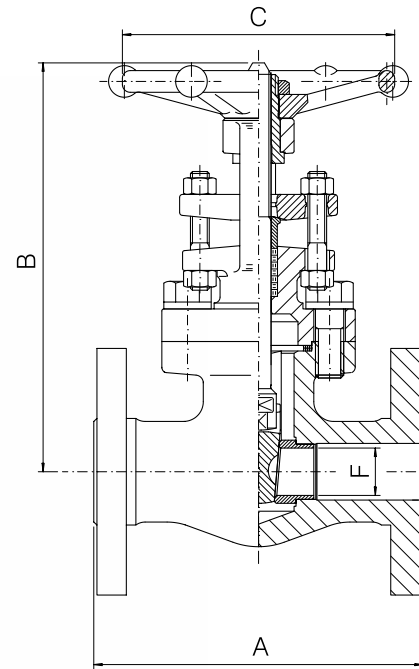

INTEGRAL FLANGED VALVES- GATE TYPE- BOLTED BONNET- FULL PORT

1500 LB.

Design construction:
 ASME B16.34 - BS 5352
 Full port type
 Testing according to API 598
 Marking MSS SP25
 Outside Screw and Yoke (OS&Y)
 Self aligning two piece packing gland
 Spiral wound gasket
 Integral backseat
 Integral body flanges
 Face to face according to ASME B16.10
 Flanges according to ASME B16.5
 Ring joint type gasket available on request
 Ratings:
 - carbon steel class 1500 3705 psig @ 100°F
 255 bar + 38°C

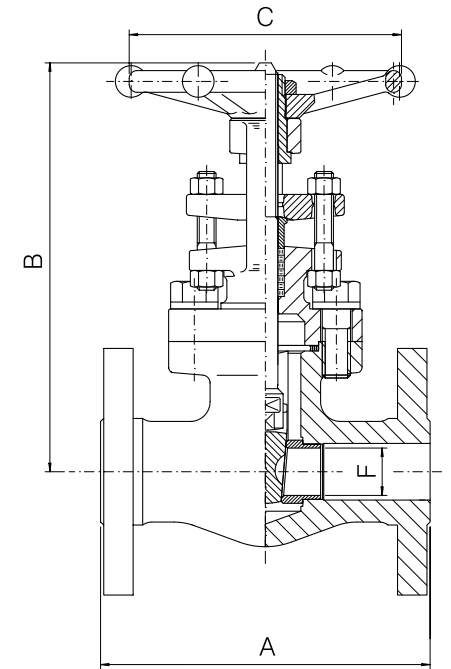

600 LB. FULL PORT – FIG. 6 10						
SIZE	inch mm	1/2 15	3/4 20	1 25	1 1/2 40	2 50
A	inch mm	6.50 165	7.51 191	8.50 216	9.50 241	11.50 292
B open	inch mm	6.89 175	8.46 215	9.45 240	11.62 295	14.17 360
C	inch mm	3.46 88	3.82 97	5.43 138	5.43 138	6.77 172
F	inch mm	.55 14	.71 18	.94 24	1.44 36.6	1.88 48
Weight	lb. kg	9.25 4.3	15.25 7	22 10	39.5 18	63.5 28
PACKING		BH2	BH4	BH5	BY5	BH8
GASKET		G2	G3	G4	G7	G9

600 LB. STANDARD PORT – FIG. L6 10						
SIZE	inch mm	1/2 15	3/4 20	1 25	1 1/2 40	2 50
A	inch mm	6.50 165	7.51 191	8.50 216	9.50 241	11.50 292
B open	inch mm	6.65 169	7.28 185	8.46 215	10.04 255	12.01 305
C	inch mm	3.46 88	3.46 88	3.82 97	5.43 138	5.43 138
F	inch mm	.38 9.6	.55 14	.71 18	1.18 30	1.44 36.6
Weight	lb. kg	9.25 4.3	15.25 7	22 10	39.5 18	63.5 28
PACKING		BH2	BH2	BH4	BH6	BY5
GASKET		G2	G2	G3	G6	G7

1500 LB. FULL PORT – FIG. 15F 10						
SIZE	inch mm	1/2 15	3/4 20	1 25	1 1/2 40	2 50
A	inch mm	8.50 216	9.02 229	10 254	12.01 305	14.5 368.5
B open	inch mm	8.46 215	9.84 250	10.63 270	13.78 350	17.52 445
C	inch mm	3.82 97	5.43 138	5.43 138	6.77 172	9.21 234
F	inch mm	.55 14	.71 18	.94 24	1.44 36.6	1.89 48
Weight	lb. kg	18 8.2	28.5 13	35.5 16.2	63.75 29	121.25 55
PACKING		BH5	BH6	2B4	BH8	9B8
GASKET		G2	G3	G4	G7	G8

B[®] INTEGRAL FLANGED VALVES- GATE TYPE- BOLTED BONNET- FULL PORT

BONNEY FORGE

2500 LB.

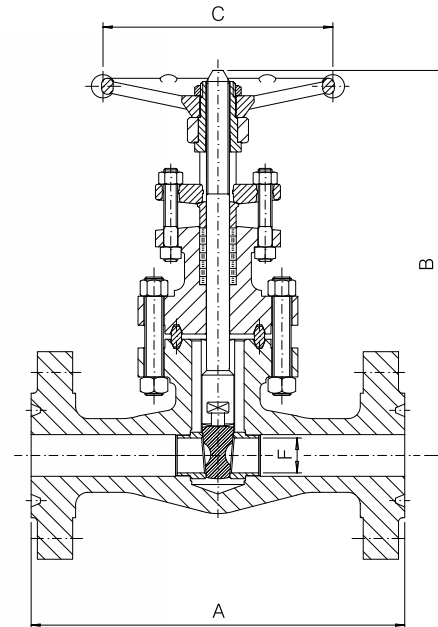

Design construction:
 ASME B16.34 - BS 5352
 Full port type
 Testing according to API 598
 Marking MSS SP25
 Outside Screw and Yoke (OS&Y)
 Self aligning two piece packing gland
 Body Bonnet Gasket ring joint type
 Spiral wound type gasket on request
 Integral backseat
 Integral body flanges
 Face to face according to ASME B16.10
 Flanges according to ASME B16.5
Ratings:
 - carbon steel class 2500 6170 psig @ 100°F
 425 bar + 38°C

B[®] INTEGRAL FLANGED VALVES- GLOBE TYPE- BOLTED BONNET- FULL & STANDARD PORT

BONNEY FORGE

150 LB.

300 LB.

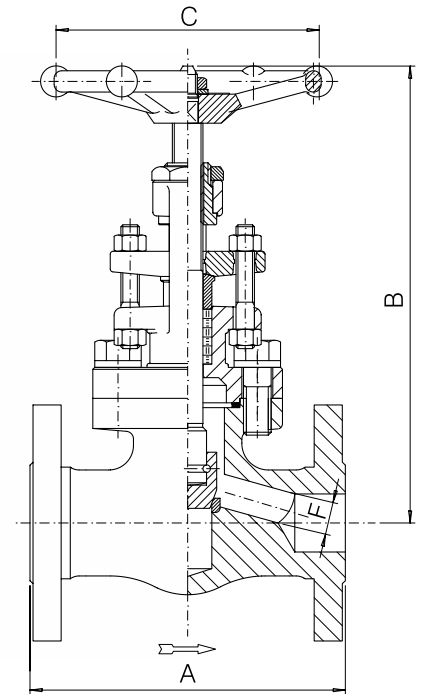

Design construction:
 ASME B16.34 - BS 5352
 Testing according to API 598
 Marking MSS SP25
 Outside Screw and Yoke (OS&Y)
 Loose disc stem assembly
 Self aligning two piece packing gland
 Spiral wound gasket
 Integral backseat
 Integral body flanges
 Face to face according to ASME B16.10
 Flanges according to ASME B16.5
Ratings:
 - carbon steel class 150 285 psig @ 100°F
 20 bar + 38°C
 - carbon steel class 300 740 psig @ 100°F
 51 bar + 38°C

FULL PORT - FIG. 25RR 10						
SIZE	inch	1/2	3/4	1	1 1/2	2
	mm	15	20	25	40	50
A	inch	10.39	10.75	12.13	15.25	17.87
	mm	264	273	308	387.5	454
B open	inch	11.10	11.42	13.19	15.98	16.34
	mm	282	290	335	406	415
C	inch	5.43	5.43	6.77	9.21	12.60
	mm	138	138	172	234	320
F	inch	.45	.59	.76	1.10	1.50
	mm	11.5	15	19.5	28	38
Weight	lb.	35.5	38.75	63.75	132.25	143.25
	kg	16.2	17.6	29	60	65
PACKING		2B4	2B4	BH8	2B8	25B8
GASKET		R16	R16	R16	R19	R22

FULL PORT - FIG. 130						
SIZE	inch	1/2	3/4	1	1 1/2	2
	mm	15	20	25	40	50
A	inch	4.25	4.62	5	6.50	8
	mm	108	117.5	127	165	203
B open	inch	7.72	9.05	10.55	12.40	13.19
	mm	196	230	268	315	335
C	inch	3.46	3.82	5.43	6.77	6.77
	mm	88	97	138	172	172
F	inch	.51	.68	.88	1.38	1.77
	mm	13	17.5	22.5	35	45
Weight	lb.	8.25	14	19	36.25	55
	kg	3.8	6.4	8.7	16.5	25
PACKING		BH3	BH5	BY5	BY7	BY7
GASKET		G2	G3	G4	G7	G8

STANDARD PORT - FIG. L1 30						
SIZE	inch	1/2	3/4	1	1 1/2	2
	mm	15	20	25	40	50
A	inch	4.25	4.62	5	6.50	8
	mm	108	117.5	127	165	203
B open	inch	7.72	7.72	8.90	10.75	11.81
	mm	196	196	226	273	300
C	inch	3.46	3.46	3.82	5.43	6.77
	mm	88	88	97	138	172
F	inch	.35	.51	.68	1.16	1.38
	mm	9	13	17.5	29.5	35
Weight	lb.	6.5	8.25	12	22.5	34.75
	kg	3	3.8	5.5	10.3	15.8
PACKING		BH3	BH3	BH5	BY5	BY7
GASKET		G2	G2	G3	G5	G8

FULL PORT - FIG. 330						
SIZE	inch	1/2	3/4	1	1 1/2	2
	mm	15	20	25	40	50
A	inch	6	7	8	9.02	10.51
	mm	152.5	178	203	229	267
B open	inch	7.72	9.05	10.55	12.40	13.19
	mm	196	230	268	315	335
C	inch	3.46	3.82	5.43	6.77	6.77
	mm	88	97	138	172	172
F	inch	.51	.68	.88	1.38	1.77
	mm	13	17.5	22.5	35	45
Weight	lb.	9	15.25	21.25	40.75	61.5
	kg	4.1	7	9.7	18.5	28
PACKING		BH3	BH5	BY5	BY7	BH8
GASKET		G2	G3	G4	G7	G9

STANDARD PORT - FIG. L3 30						
SIZE	inch	1/2	3/4	1	1 1/2	2
	mm	15	20	25	40	50
A	inch	6	7	8	9.02	10.51
	mm	152.5	178	203	229	267
B open	inch	7.72	7.95	8.90	10.63	12.64
	mm	196	202	226	270	321
C	inch	3.46	3.46	3.82	5.43	6.77
	mm	88	88	97	138	172
F	inch	.35	.51	.68	1.16	1.38
	mm	9	13	17.5	29.5	35
Weight	lb.	9	13	18.25	36.25	47.25
	kg	4.1	6	8.3	15.5	21.5
PACKING		BH3	BH3	BH5	BY5	BY7
GASKET		G2	G2	G3	G6	G7

B INTEGRAL FLANGED VALVES- GLOBE TYPE- BOLTED BONNET-
FULL & STANDARD PORT
BONNEY FORGE

600 LB.

Design construction:
ASME B16.34 - BS 5352
Testing according to API 598
Marking MSS SP25
Loose disc stem assembly
Outside Screw and Yoke (OS&Y)
Self aligning two piece packing gland
Spiral wound gasket
Integral backseat
Integral body flanges
Face to face according to ASME B16.10
Flanges according to ASME B16.5
Ratings:
- carbon steel class 600 1480 psig @ 100°F
102 bar + 38°C

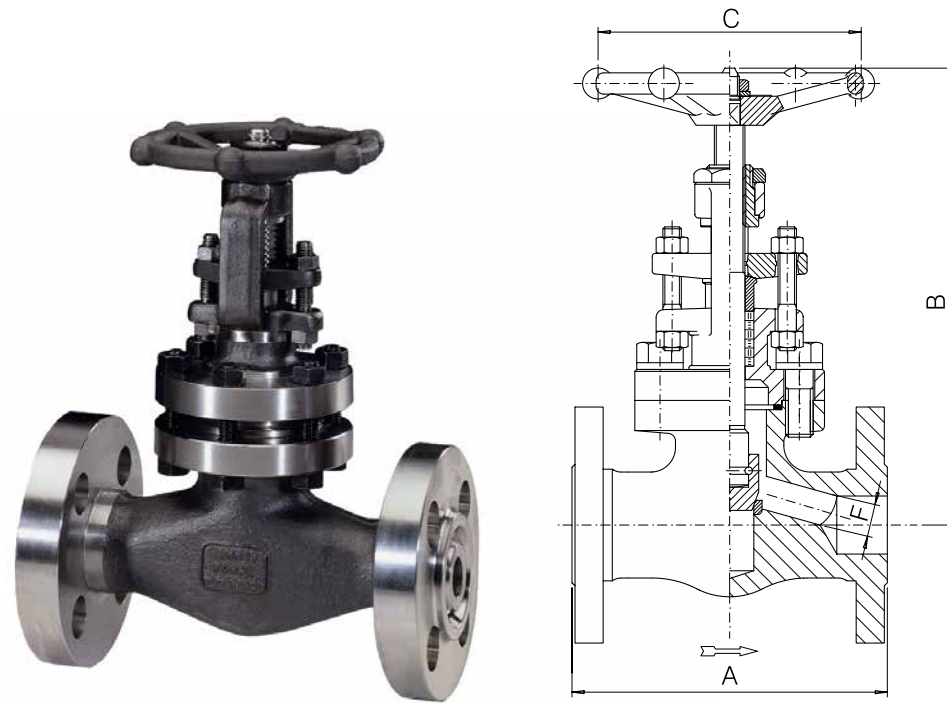

B INTEGRAL FLANGED VALVES- GLOBE TYPE- BOLTED BONNET-
FULL PORT
BONNEY FORGE

1500 LB.

Design construction:
ASME B16.34 - BS 5352
Full port type
Testing according to API 598
Marking MSS SP25
Outside Screw and Yoke (OS&Y)
Loose Disc Stem Assembly
Ring joint type gasket available on request
Self aligning two piece packing gland
Spiral wound gasket
Integral backseat
Integral body flanges
Face to face according to ASME B16.10
Flanges according to ASME B16.5
Ratings:
- carbon steel class 1500 3705 psig @ 100°F
255 bar + 38°C

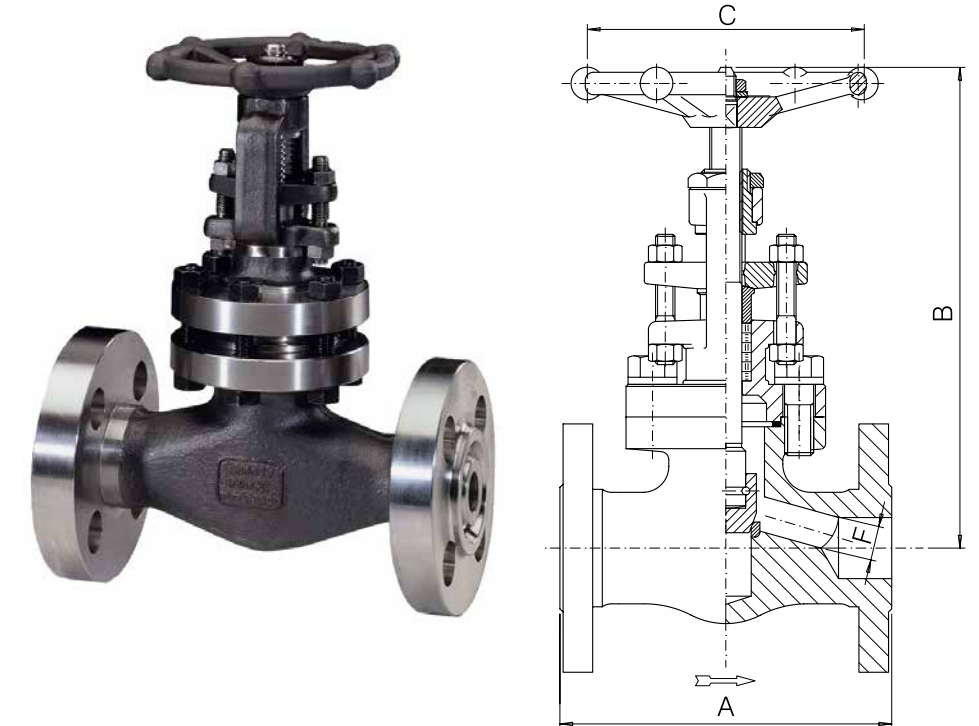

600 LB. FULL PORT – FIG. 6 30						
SIZE	inch mm	1/2 15	3/4 20	1 25	1 1/2 40	2 50
A	inch mm	6.50 165	7.51 191	8.50 216	9.50 241	11.50 292
B open	inch mm	7.72 196	9.06 230	10.55 268	12.40 315	14.57 370
C	inch mm	3.46 88	3.82 97	5.43 138	6.77 172	6.77 172
F	inch mm	.51 13	.68 17.5	.88 22.5	1.38 35	1.77 45
Weight	lb. kg	13 5.9	17.5 8	23 10.5	43 19.5	62.75 28.5
PACKING		BH3	BH5	BY5	BY7	BH8
GASKET		G2	G3	G4	G7	G9

600 LB. STANDARD PORT – FIG. L6 30						
SIZE	inch mm	1/2 15	3/4 20	1 25	1 1/2 40	2 50
A	inch mm	6.50 165	7.51 191	8.50 216	9.50 241	11.50 292
B open	inch mm	7.72 196	7.95 202	9.21 234	10.63 270	12.64 321
C	inch mm	3.46 88	3.46 88	3.82 97	5.43 138	6.77 172
F	inch mm	.35 9	.51 13	.67 17.5	1.16 29.5	1.38 35
Weight	lb. kg	9.5 4.4	13.5 6.2	19 8.7	36.25 16.5	52 23.6
PACKING		BH3	BH3	BH5	BY5	BY7
GASKET		G2	G2	G3	G6	G7

1500 LB. FULL PORT – FIG. 15F 30						
SIZE	inch mm	1/2 15	3/4 20	1 25	1 1/2 40	2 50
A	inch mm	8.50 216	9.02 229	10 254	12.01 305	14.51 368.5
B open	inch mm	9.45 240	11.02 280	11.61 295	14.57 370	18.31 465
C	inch mm	3.82 97	5.43 138	6.77 172	6.77 172	9.21 234
F	inch mm	.47 12	.57 14.5	.75 19	1.22 31	1.57 40
Weight	lb. kg	18.5 8.5	28.25 12.9	37.25 17	66 30	127.75 58
PACKING		BH5	2B4	2B4	BH8	9B8
GASKET		G2	G3	G4	G7	G8

B INTEGRAL FLANGED VALVES- GLOBE TYPE- BOLTED BONNET- FULL PORT

BONNEY FORGE

2500 LB.

Design construction:
 ASME B16.34 - BS 5352
 Full port type
 Testing according to API 598
 Marking MSS SP25
 Outside Screw and Yoke (OS&Y)
 Loose Disc Stem Assembly
 Body Bonnet Gasket ring joint type
 Spiral wound type gasket on request
 Self aligning two piece packing gland
 Integral backseat
 Integral body flanges
 Face to face according to ASME B16.10
 Flanges according to ASME B16.5
 Ratings:
 - carbon steel class 2500 6170 psig @ 100°F
 425 bar + 38°C

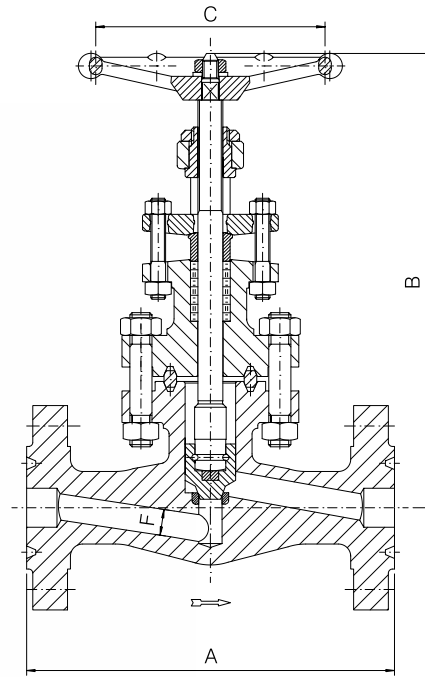

FULL PORT - FIG. 25FR 30						
SIZE	inch	1/2	3/4	1	1 1/2	2
	mm	15	20	25	40	50
A	inch	10.39	10.75	12.13	15.25	17.87
	mm	264	273	308	387.5	454
B open	inch	12.20	12.40	13.78	17.72	18.11
	mm	310	315	350	450	460
C	inch	5.43	5.43	6.77	9.21	12.6
	mm	138	138	172	234	320
F	inch	.43	.57	.75	1.10	1.38
	mm	11	14.5	19	28	35
Weight	lb.	36.25	40.75	66	135.5	147.5
	kg	16.5	18.5	30	61.5	67
PACKING		2B4	2B4	BH8	9B8	4B8
GASKET		R16	R16	R16	R19	R20

B INTEGRAL FLANGED VALVES- CHECKTYPE- BOLTED BONNET- FULL & STANDARD PORT

BONNEY FORGE

150 LB.

300 LB.

Design construction:
 ASME B16.34 - BS 5352
 Testing according to API 598
 Marking MSS SP25
 Spring available on request for Piston and Ball Check Valves
 Spiral wound gasket
 Integral body flanges
 Face to face according to ASME B16.10
 Flanges according to ASME B16.5
 Ratings:
 - carbon steel class 150 285 psig @ 100°F
 20 bar + 38°C
 - carbon steel class 300 740 psig @ 100°F
 51 bar + 38°C

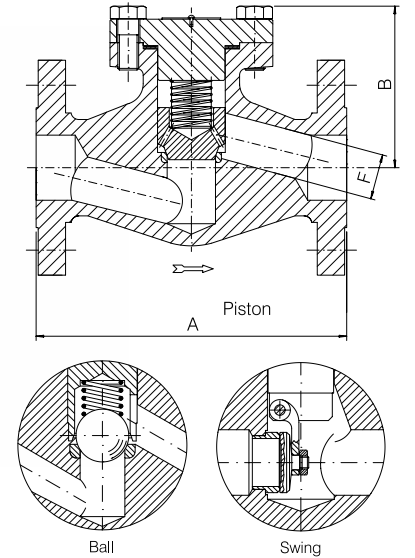

FULL PORT - FIG. 1 40, 1 50, 1 60						
SIZE	inch	1/2	3/4	1	1 1/2	2
	mm	15	20	25	40	50
A	inch	4.25	4.62	5	6.50	8
	mm	108	117.5	127	165	203
B	inch	2.95	3.35	3.94	4.92	5.51
	mm	75	85	100	125	140
F Piston/ F Ball	inch	.51	.68	.88	1.38	1.77
	mm	13	17.5	22.5	35	45
F Swing	inch	.55	.71	.94	1.46	1.89
	mm	14	18	24	36.6	48
Weight	lb.	6	7.75	11.25	22	35.25
	kg	2.8	3.6	5.2	10	16
GASKET		G2	G3	G4	G7	G8

STANDARD PORT - FIG. L1 40, L1 50, L1 60						
SIZE	inch	1/2	3/4	1	1 1/2	2
	mm	15	20	25	40	50
A	inch	4.25	4.62	5	6.50	8
	mm	108	117.5	127	165	203
B	inch	2.95	2.95	3.35	4.33	4.92
	mm	75	75	85	110	125
F Piston/ F Ball	inch	.35	.51	.68	1.16	1.38
	mm	9	13	17.5	29.5	35
F Swing	inch	.39	.55	.68	1.16	1.46
	mm	9.6	14	17.5	29.5	36.6
Weight Piston/ Weight Ball	lb.	5	6.75	9.75	18.5	30.75
	kg	2.3	3.1	4.5	8.4	14
Weight Swing	lb.	4.75	6.75	9.5	18.25	28.5
	kg	2.2	3.1	4.4	8.3	13
GASKET		G2	G2	G3	G5	G8

FULL PORT - FIG. 3 40, 3 50, 3 60						
SIZE	inch	1/2	3/4	1	1 1/2	2
	mm	15	20	25	40	50
A	inch	6	7	8*	9.02*	10.51
	mm	152.5	178	203*	229*	267
B	inch	2.95	3.54	3.94	4.72	5.91
	mm	75	90	100	120	150
F Piston/ F Ball	inch	.51	.68	.88	1.38	1.77
	mm	13	17.5	22.5	35	45
F Swing	inch	.55	.71	.94	1.46	1.89
	mm	14	18	24	36.6	48
Weight	lb.	7.75	14	18	33	46.25
	kg	3.6	6.4	8.2	15	21
GASKET		G2	G3	G4	G7	G9

STANDARD PORT - FIG. L3 40, L3 50, L3 60						
SIZE	inch	1/2	3/4	1	1 1/2	2
	mm	15	20	25	40	50
A	inch	6	7	8*	9.02*	10.51
	mm	152.5	178	203*	229*	267
B	inch	2.95	3.15	3.46	4.53	5.12
	mm	75	80	88	115	130
F Piston/ F Ball	inch	.35	.51	.68	1.16	1.38
	mm	9	13	17.5	29.5	35
F Swing	inch	.39	.55	.68	1.16	1.46
	mm	9.6	14	17.5	29.5	36.6
Weight Piston/ Weight Ball	lb.	7.5	11.5	16.5	30.75	41.75
	kg	3.4	5.3	7.5	14	19
Weight Swing	lb.	7.25	11.25	16.25	29.75	39.5
	kg	3.3	5.2	7.4	13.5	18
GASKET		G2	G2	G3	G6	G7

* A - dimensions for Swing Check Valves only are 8.5 in. / 216 mm and 9.5 in. / 241 mm respectively

B[®] INTEGRAL FLANGED VALVES- CHECK TYPE- BOLTED BONNET- FULL & STANDARD PORT

BONNEY FORGE

600 LB.

Design construction:
 ASME B16.34 - BS 5352
 Testing according to API 598
 Marking MSS SP25
 Spring available on request for Piston
 and Ball Check Valves
 Spiral wound gasket
 Integral body flanges
 Face to face according to ASME B16.10
 Flanges according to ASME B16.5
 Ratings:
 - carbon steel class 600 1480 psig @ 100°F
 102 bar + 38°C

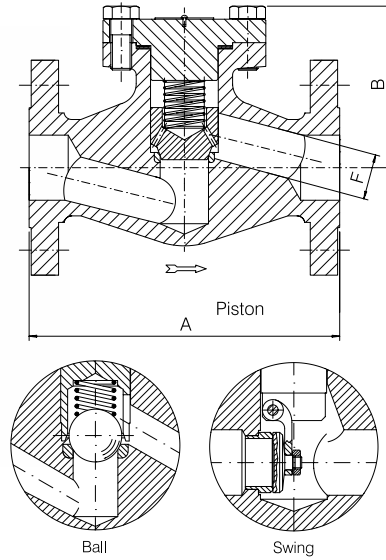

B[®] INTEGRAL FLANGED VALVES- CHECK TYPE- BOLTED BONNET- FULL PORT

BONNEY FORGE

1500 LB.

Design construction:
 ASME B16.34 - BS 5352
 Full Port Type
 Testing according to API 598
 Marking MSS SP25
 Spring available on request for Piston
 and Ball Check Valves
 Ring joint type gasket available on request
 Spiral wound gasket
 Integral body flanges
 Face to face according to ASME B16.10
 Flanges according to ASME B16.5
 Ratings:
 - carbon steel class 1500 3705 psig @ 100°F
 255 bar + 38°C

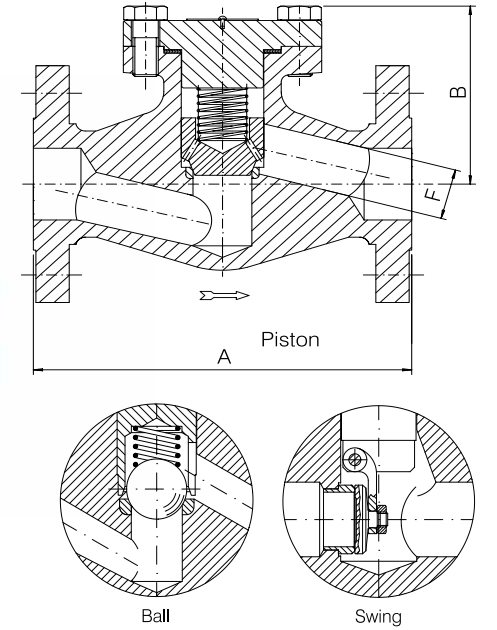

600 LB. FULL PORT — FIG. 6 40, 6 50, 6 60						
SIZE	inch mm	1/2 15	3/4 20	1 25	1 1/2 40	2 50
A	inch mm	6.50 165	7.51 191	8.50 216	9.50 241	11.50 292
B	inch mm	2.95 75	3.54 90	3.94 100	4.72 120	5.91 150
F Piston/ F Ball	inch mm	.51 13	.68 17.5	.88 22.5	1.38 35	1.77 45
F Swing	inch mm	.55 14	.71 18	.94 24	1.46 36.6	1.89 48
Weight	lb. kg	8.25 3,8	14.25 6,5	18.5 8,5	35.25 16	50.5 23
GASKET		G2	G3	G4	G7	G9

600 LB. STANDARD PORT — FIG. L6 40, L6 50, L6 60						
SIZE	inch mm	1/2 15	3/4 20	1 25	1 1/2 40	2 50
A	inch mm	6.50 165	7.51 191	8.50 216	9.50 241	11.50 292
B	inch mm	2.83 72	3.15 80	3.35 85	4.53 115	5.12 130
F Piston/ F Ball	inch mm	.35 9	.51 13	.68 17.5	1.16 29.5	1.38 35
F Swing	inch mm	.39 9.6	.55 14	.68 17.5	1.16 29.5	1.46 36.6
Weight	lb. kg	7.5 3,5	12.5 5,7	17.5 8	31.75 14,5	43 19,5
GASKET		G2	G2	G3	G6	G7

1500 LB. FULL PORT — FIG. 15F 40, 15F 50, 15F 60						
SIZE	inch mm	1/2 15	3/4 20	1 25	1 1/2 40	2 50
A	inch mm	8.50 216	9.02 229	10 254	12.01 305	14.50 368,5
B	inch mm	4.13 105	4.92 125	5.31 135	6.10 155	7.68 195
F Piston/ F Ball	inch mm	.47 12	.57 14,5	.75 19	1.22 31	1.57 40
F Swing	inch mm	.55 14	.71 18	.94 24	1.46 36,6	1.89 48
Weight	lb. kg	16.5 7,5	24.5 11,2	31.75 14,5	58.25 26,5	110 50
GASKET		G2	G3	G4	G7	G8

B INTEGRAL FLANGED VALVES- CHECK TYPE- BOLTED BONNET- FULL PORT

2500 LB.

Design construction:
 ASME B16.34 - BS 5352
 Full Port Type
 Testing according to API 598
 Marking MSS SP25
 Body Bonnet Gasket ring joint type
 Spiral wound type gasket on request
 Spring available on request for Piston
 and Ball Check Valves
 Integral body flanges
 Face to face according to ASME B16.10
 Flanges according to ASME B16.5
 Ratings:
 - carbon steel class 2500 6170 psig @ 100°F
 425 bar + 38°C

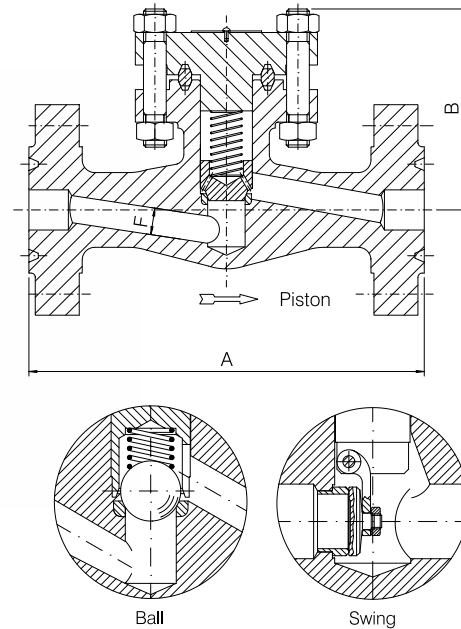

FULL PORT – FIG. 25FR 40, 25FR 50, 25FR 60						
SIZE	inch	1/2	3/4	1	1 1/2	2
	mm	15	20	25	40	50
A	inch	10.39	10.75	12.13	15.25	17.87
	mm	264	273	308	387.5	454
B	inch	5.04	5.12	5.98	7.40	7.48
	mm	128	130	152	188	190
F Piston/ F Ball	inch	.43	.57	.75	1.10	1.38
	mm	11	14.5	19	28	35
F Swing	inch	.45	.59	.76	1.10	1.38
	mm	11.5	15	19.5	28	35
Weight	lb.	31.5	35.25	57.75	119	123.25
	kg	14.3	16	26.3	54	56
GASKET		R16	R16	R16	R19	R20*

Materials and trim specifications Page 91

*R22 for 2" Swing only.

Overview56

Gate Type- Bolted & Welded Bonnet-
800 lb. & 1500 lb. valves57

Gate Type- Welded Bonnet-
2500 lb. valves58

Globe Type- Bolted & Welded Bonnet-
800 lb. & 1500 lb. valves59

BELLOWS SEALED VALVES

