

B[®] CHECK VALVES- BOLTED BONNET- FULL & REDUCED PORT

BONNEY FORGE

800 LB.

1500 LB.

Design construction:

- ASME B16.34 - BS 5352
- Testing according to API 598
- Marking MSS SP25
- Spring on request only
- Spiral-wound gasket
- Socket Weld Ends to ASME B16.11
- Screwed Ends (NPT) to ASME B1.20.1
- Butt Welding Ends to ASME B16.25

Ratings:

- carbon steel class 800 1975 psig @ 100°F
138 bar + 38°C
- carbon steel class 1500 3705 psig @ 100°F
255 bar + 38°C

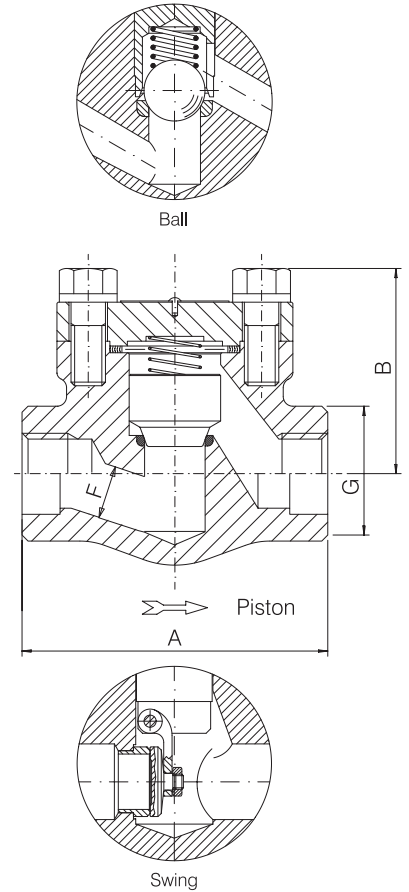

800 LB.		FULL PORT - FIG. H 40 - H 50 - H 60								
		SIZE	inch mm	1/4 6	3/8 10	1/2 15	3/4 20	1 25	1 1/4 32	1 1/2 40
A	inch mm	3.15 80*	3.15 80	3.54 90	4.33 110	5 127	5.91 150	7.09 180	8.27 210	
B	inch mm	2.17 55	2.17 55	2.36 60	3.07 78	3.46 88	3.62 92	4.25 108	5.71 145	
F Piston/ F Ball	inch mm	.28 7	.35 9	.51 13	.69 17.5	.89 22.5	1.16 29.5	1.38 35	1.77 45	
F Swing	inch mm	.31 8	.38 9.6	.55 14	.71 18	.94 24	1.18 30	1.44 36.6	1.89 48	
G	inch mm	1.26 32	1.26 32	1.50 38	1.89 48	2.20 56	2.52 64	3.07 78	3.35 85	
Weight	lb. kg	3 1.4	3 1.4	3.5 1.6	6.5 3	9.5 4.3	12.25 5.6	22 10	35.25 16	
GASKET		G2	G2	G2	G3	G4	G6	G7	G9	

800 LB.		REDUCED PORT - FIG. HL 40 - HL 50 - HL 60					
		SIZE	inch mm	1/2 15	3/4 20	1 25	1 1/2 40
A	inch mm	3.15 80	3.54 90	4.33 110	5.91 150	7.09 180	
B	inch mm	2.17 55	2.36 60	3.07 78	3.62 92	4.25 108	
F Piston/ F Ball	inch mm	.35 9	.51 13	.69 17.5	1.16 29.5	1.38 35	
F Swing	inch mm	.38 9.6	.55 14	.71 18	1.18 30	1.44 36.6	
G	inch mm	1.26 32	1.5 38	1.89 48	2.52 64	3.07 78	
Weight	lb. kg	2.75 1.3	3.5 1.6	6.25 2.8	12.25 5.6	19.75 9.0	
GASKET		G2	G2	G3	G6	G7	

*For swing type only A=90mm 3.54inch

1500 LB.		FULL PORT - FIG. 9H 40 - 9H 50 - 9H 60								
		SIZE	inch mm	1/4 6	3/8 10	1/2 15	3/4 20	1 25	1 1/4 32	1 1/2 40
A	inch mm	3.54 90	3.54 90	4.33 110	5 127	5.91 150	7.09 180	8.27 210	8.27 210	
B	inch mm	2.36 60	2.36 60	3.07 78	3.46 88	3.62 92	4.25 108	5.71 145	5.91 150	
F Piston/ F Ball	inch mm	.28 7	.35 9	.47 12	.59 15	.79 20	1.06 27	1.26 32	1.57 40	
F Swing	inch mm	-	-	.55 14	.71 18	.94 24	1.18 30	1.44 36.6	1.89 48	
G	inch mm	1.5 38	1.5 38	1.89 48	2.20 56	2.52 64	3.07 78	3.35 85	3.74 95	
Weight	lb. kg	3.75 1.7	3.75 1.7	6.75 3.1	10 4.6	14.25 6.5	23.25 10.6	41.75 19	41.75 19	
GASKET		G1	G1	G2	G3	G4	G5	G7	G8	

1500 LB.		REDUCED PORT - FIG. 9HL 40 - 9HL 50 - 9HL 60					
		SIZE	inch mm	1/2 15	3/4 20	1 25	1 1/2 40
A	inch mm	3.54 90	4.33 110	5 127	7.09 180	8.27 210	
B	inch mm	2.36 60	3.07 78	3.46 88	4.25 108	5.71 145	
F Piston/ F Ball	inch mm	.35 9	.47 12	.59 15	1.06 27	1.26 32	
F Swing	inch mm	.38 9.6	.55 14	.71 18	1.18 30	1.44 36.6	
G	inch mm	1.5 38	1.89 48	2.20 56	3.07 78	3.35 85	
Weight	lb. kg	3.75 1.7	6.5 3	9.75 4.4	22 10	39.5 18	
GASKET		G1	G2	G3	G5	G7	

B[®] CHECK VALVES- BOLTED BONNET- FULL PORT

BONNEY FORGE

1500 LB.

2500 LB.

Design construction:

- ASME B16.34 - BS 5352
- Testing according to API 598
- Marking MSS SP25
- Spring on request only
- Oval ring joint gasket
- Socket Weld Ends to ASME B16.11
- Screwed Ends (NPT) to ASME B1.20.1
- Butt Welding Ends to ASME B16.25
- Ratings standard class:
 - carbon steel class 1500 3705 psig @ 100°F
255 bar + 38°C
 - carbon steel class 2500 6170 psig @ 100°F
425 bar + 38°C

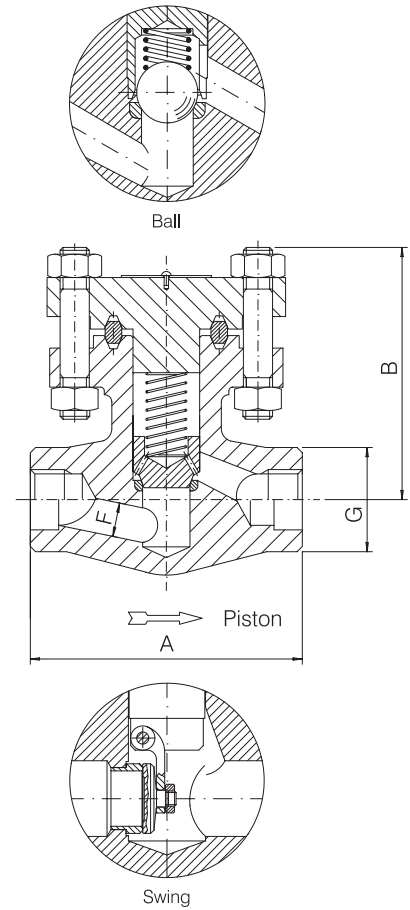

FULL PORT – FIG. H9R 40 - H9R 50 - H9R 60						
SIZE	inch mm	1/2 15	3/4 20	1 25	1 1/2 40	2 50
A	inch mm	4.33 110	5.91 150	5.91 150	8.27 210	9.06 230
B	inch mm	3.78 96	5.04 128	5.04 128	6.10 155	7.68 195
F Piston/ F Ball	inch mm	.47 12	.59 15	.75 19	1.26 32	1.5 38
F Swing	inch mm	.55 14	.71 18	.94 24	1.44 36,6	1.89 48
G	inch mm	1.5 38	2.17 55	2.17 55	2.95 75	3.62 92
Weight	lb. kg	7 3,2	16 7,3	16 7,3	37,5 17	63,75 29
GASKET		R12	R17	R17	R20	R24

FULL PORT – FIG. 25HR 40 - 25HR 50 - 25HR 60						
SIZE	inch mm	1/2 15	3/4 20	1 25	1 1/2 40	2 50
A	inch mm	5.91 150	5.91 150	8.27 210	9.06 230	9.06 230
B	inch mm	5.04 128	5.04 128	5.98 152	7.48 190	7.48 190
F Piston/ F Ball	inch mm	.43 11	.57 14,5	.75 19	1.10 28	1.38 35
F Swing	inch mm	.45 11,5	.59 15	.77 19,5	1.10 28	1.38 35
G	inch mm	2.17 55	2.17 55	2.95 75	3.74 95	3.74 95
Weight	lb. kg	16,5 7,5	16,5 7,5	40,75 18,5	66 30	66 30
GASKET		R16	R16	R17	R20	R20

B CHECK VALVES- WELDED BONNET- FULL & REDUCED PORT

BONNEY FORGE

800 LB.

1500 LB.

Design construction:

ASME B16.34 - BS 5352
 Testing according to API 598
 Marking MSS SP25
 Spring on request only
 Body bonnet weld to ASME IX
 Socket Weld Ends to ASME B16.11
 Screwed Ends (NPT) to ASME B1.20.1
 Butt Welding Ends to ASME B16.25
 Ratings:

- carbon steel class 800 1975 psig @ 100°F
 138 bar + 38°C
- carbon steel class 1500 3705 psig @ 100°F
 255 bar + 38°C

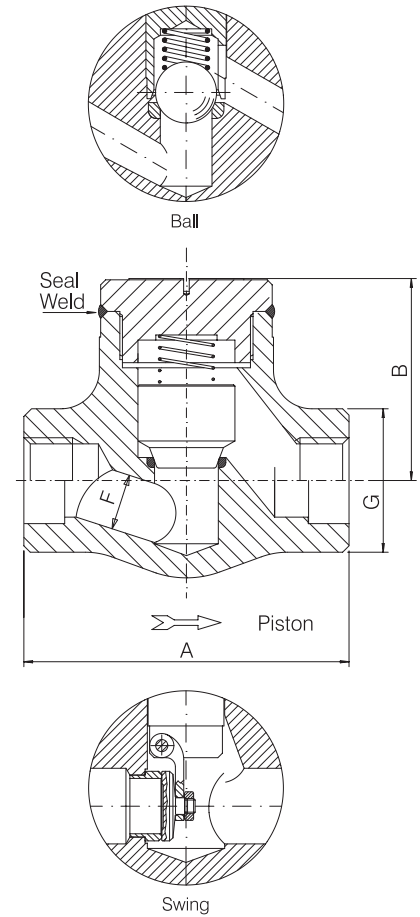

		FULL PORT – FIG. W 40 - W 50 - W 60								
SIZE	inch mm	1/4	3/8	1/2	3/4	1	1 1/4	1 1/2	2	
		6	10	15	20	25	32	40	50	
A	inch mm	3.15 80	3.15 80	3.54 90	4.33 110	5 127	5.91 150	7.09 180	8.27 210	
B	inch mm	2.17 55	2.17 55	2.36 60	3.07 78	3.46 88	3.62 92	4.33 110	5.91 150	
F Piston/ F Ball	inch mm	.28 7	.35 9	.51 13	.69 17.5	.89 22.5	1.16 29.5	1.38 35	1.77 45	
F Swing	inch mm	.31 8	.38 9.6	.55 14	.71 18	.94 24	1.18 30	1.44 36.6	1.89 48	
G	inch mm	1.26 32	1.26 32	1.50 38	1.89 48	2.20 56	2.52 64	3.07 78	3.35 85	
Weight	lb. kg	2 1	2 1	2.5 1.2	5 2.3	7.25 3.3	11.5 5.2	19 8.7	30.75 14	

		REDUCED PORT – FIG. WL 40 - WL 50 - WL 60					
SIZE	inch mm	1/2	3/4	1	1 1/2	2	
		15	20	25	40	50	
A	inch mm	3.15 80	3.54 90	4.33 110	5.91 150	7.09 180	
B	inch mm	2.13 54	2.36 60	3 76	3.62 92	4.33 110	
F Piston/ F Ball	inch mm	.35 9	.51 13	.69 17.5	1.16 29.5	1.38 35	
F Swing	inch mm	.38 9.6	.55 14	.71 18	1.18 30	1.44 36.6	
G	inch mm	1.26 32	1.50 38	1.89 48	2.52 64	3.07 78	
Weight	lb. kg	1.75 0.9	2.25 1.1	5 2.3	11 5	18.25 8.3	

		FULL PORT – FIG. 9W 40 - 9W 50 - 9W 60								
SIZE	inch mm	1/4	3/8	1/2	3/4	1	1 1/4	1 1/2	2	
		6	10	15	20	25	32	40	50	
A	inch mm	3.54 90	3.54 90	4.33 110	5 127	5.91 150	7.09 180	8.27 210	9.06 230	
B	inch mm	2.17 55	2.17 55	3 76	3.31 84	3.54 90	4.33 110	5.91 150	9.06 230	
F Piston/ F Ball	inch mm	.28 7	.35 9	.47 12	.59 15	.79 20	1.06 27	1.26 32	1.57 40	
F Swing	inch mm	.31 8	.38 9.6	.55 14	.71 18	.94 24	1.18 30	1.44 36.6	1.89 48	
G	inch mm	1.50 38	1.50 38	1.89 48	2.20 56	2.52 64	3.07 78	3.35 85	3.74 95	
Weight	lb. kg	3 1.4	3 1.4	5.5 2.5	8 3.7	13.25 6	22 10	34.25 15.5	48.5 22	

		REDUCED PORT – FIG. 9WL 40 - 9WL 50 - 9WL 60					
SIZE	inch mm	1/2	3/4	1	1 1/2	2	
		15	20	25	40	50	
A	inch mm	3.54 90	4.33 110	5 127	7.09 180	8.27 210	
B	inch mm	2.13 54	3 76	3.39 86	4.33 110	5.91 150	
F Piston/ F Ball	inch mm	.35 9	.47 12	.59 15	1.06 27	1.26 32	
F Swing	inch mm	.38 9.6	.55 14	.71 18	1.18 30	1.44 36.6	
G	inch mm	1.5 38	1.89 48	2.20 56	3.07 78	3.35 85	
Weight	lb. kg	3 1.4	4.75 2.2	6.5 3	21 9.6	35.25 16	

B[®] CHECK VALVES- WELDED BONNET- FULL PORT

BONNEY FORGE

2500 LTD.

4500 LTD.

Design construction:

ASME B16.34 Limited Class
 Testing according to API 598
 Marking MSS SP25
 Spring on request only
 Body bonnet weld to ASME IX
 Socket Weld Ends to ASME B16.11
 Screwed Ends (NPT) to ASME B1.20.1
 Butt Welding Ends to ASME B16.25

Ratings:

- carbon steel class 2500 6250 psig @ 100°F
 431 bar + 38°C
 - carbon steel class 4500 11250 psig @ 100°F
 776 bar + 38°C

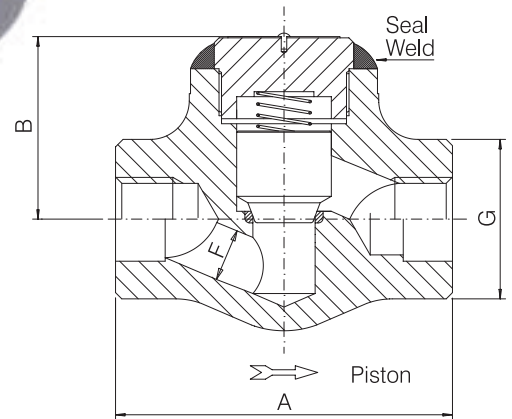
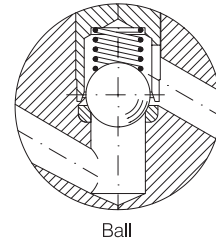

		FULL PORT – FIG. 25W 40 - 25W 50							
		SIZE	inch mm	1/4 6	3/8 10	1/2 15	3/4 20	1 25	1 1/2 40
2500 LTD.	A	inch mm	4.33 110	4.33 110	5 127	5.91 150	7.09 180	8.27 210	9.06 230
	B	inch mm	2.76 70	2.76 70	3.39 86	3.62 92	4.33 110	5.91 150	7.09 180
	F	inch mm	.28 7	.35 9	.43 11	.57 14.5	.75 19	1.10 28	1.38 35
	G	inch mm	1.89 48	1.89 48	2.20 56	2.52 64	3.07 78	3.35 85	3.74 95
	Weight	lb. kg	7 3.2	7 3.2	8.25 3.8	12.25 5.6	22 10	35.25 16	46.25 21

		FULL PORT – FIG. 45W 40 - 45W 50							
		SIZE	inch mm	1/4 6	3/8 10	1/2 15	3/4 20	1 25	1 1/2 40
4500 LTD.	A	inch mm	5 127	5 127	5 127	7.09 180	7.09 180	9.06 230	9.06 230
	B	inch mm	3.54 90	3.54 90	3.54 90	4.33 110	4.33 110	7.09 180	7.68 195
	F	inch mm	.28 7	.28 7	.31 8	.43 11	.55 14	.98 25	1.26 32
	G	inch mm	2.20 56	2.20 56	2.20 56	3.07 78	3.07 78	3.74 95	4.72 120
	Weight	lb. kg	8.5 3.9	8.5 3.9	8.5 3.9	23 10.5	23 10.5	55.5 25.2	59.5 27

Available with Socket Weld or Butt-Weld Ends only.

Materials and trim specifications Page 91