

Discontinue



Pilot operated 2 port solenoid valve for air blow: Normally closed

PILOT OPERATED SOLENOID VALVE FOR COMPRESSED AIR FAD SERIES

- Diaphragm structure
- Port size : Rc1/4, Rc3/8, Rc1/2

JIS symbol

- Normally closed

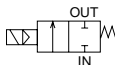

Specifications

Descriptions	FAD-8A	FAD-10A	FAD-L10A	FAD-15A
Working fluid	Compressed air			
Min. working pressure dif.MPa	0.1			
Max. working pressure dif.MPa	0.7			
Max. working pressure MPa	0.7			
Withstanding pressure (water)MPa	1.4			
Fluid temperature °C	-10 to 60 (no freezing)			
Ambient temperature°C	-10 to 60			
Atmosphere	No corrosive gas, flammable and splash			
Valve structure	Pilot operated diaphragm structure			
Valve seat leakage cm ³ /min	10 or less			
Installation attitude	Free			
Port size	Rc1/4	Rc3/8	Rc3/8	Rc1/2
Orifice mm	10 mm	10 mm	15mm	15mm
Effective sectional area mm ²	45	50	88	98
Mass kg	0.27		0.44	
Electrical specifications				
Rated voltage	AC100V50/60Hz, AC200V50/60Hz, DC24V, DC12V			
Apparent power VA	50Hz	5.3		7.5
	60Hz	3.7		5.5
Power consumption W	50Hz	2.7		4.0
	60Hz	2.0		3.4
	DC	4.0		6.5
Insulation class	Class B			



CAD DATA AVAILABLE.

How to order

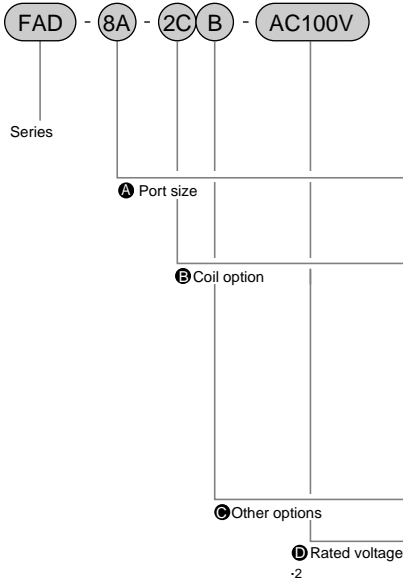

Symbol		Descriptions	Series			
			FAD15A	FAD10A	FAD8A	FAD15A
A Port size	8A	Rc1/4	●			
	10A	Rc3/8		●		
	L10A	Rc3/8			●	
	15A	Rc1/2				●
B Coil option	2C	STD Grommet lead wire	●			●
	2CS	Grommet lead wire + surge suppressor		●		●
	2G	Small terminal box	● Pg9			● Pg11
	2HS	Small terminal box + light, surge suppressor	● Pg9			● Pg11
	2CG	Conduit CTC19				●
	2CH	Conduit G1/2				●
	3T	T terminal box G1/2				●
C Other options	3RS	T terminal box G1/2 + light, surge suppressor				●
	Blank	STD No option	●	●	●	●
	B	Opt on Mounting plate	●	●	●	●
D Rated voltage	AC100V	AC100V50/60Hz, AC110V60Hz	●	●	●	●
	AC200V	AC200V50/60Hz, AC220V60Hz	●	●	●	●
	DC 24V	DC 24V	●	●	●	●
	DC 12V	DC 12V	●	●	●	●

-1: ● shows availability.
-2: Consult with CKD about other optional voltage.

<Example of model number>

FAD-10A-2CB-AC100V

Series : Air blow valve FAD

A Port size : Rc3/8

B Coil option : Grommet lead wire

C Other options : With mounting plate

D Rated voltage : AC100V 50/60Hz, AC110V 60Hz

Internal structure and main parts materials

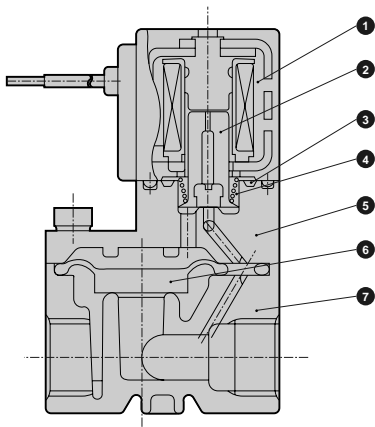

No.	Parts name	Material
1	Coil assembly	Class B molded coil
2	Plunger assembly	SUS, NBR Stainless steel, nitrile rubber
3	O ring	NBR Nitrile rubber
4	Spring	SUS Stainless steel
5	Stuffing	ADC Aluminum alloy die-casting
6	Diaphragm	U Urethane rubber resin
7	Body	ADC Aluminum alloy die-casting

Dimensions

• Grommet lead wire type

FAD-8A/10A/L10A/15A-2C



(File name : Page 330 or Ending 27)

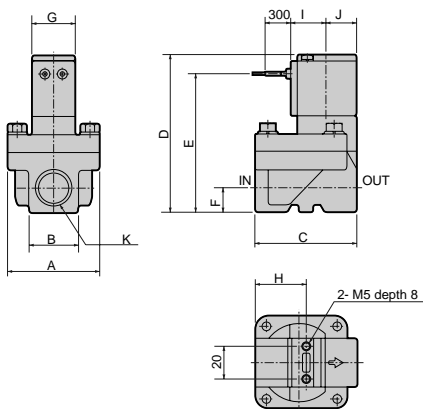

Model	A	B	C	D	E	F	G	H	I	J	K
FAD-8A-2C	45	24	50	82	71	12	22	25	19.5	15.5	Rc1/4 or Rc3/8
FAD-10A-2C											
FAD-L10A-2C	57	30	63	97	85	15	28	31.5	22.5	18.5	Rc3/8 or Rc1/2
FAD-15A-2C											

Optional dimensions

• Grommet lead wire + surge suppressor  (File name : Page 330 or Ending 27)
 FAD-8A/10A-2CS

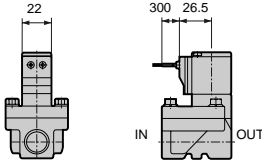

• Grommet lead wire + surge suppressor  (File name : Page 330 or Ending 27)
 FAD-L10A/15A-2CS

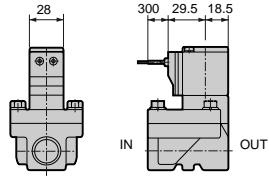

• Small terminal (Pg9)  (File name : Page 330 or Ending 27)
 FAD-8A/10A-2G
2HS

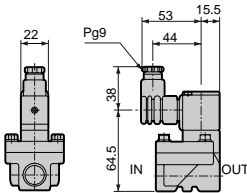

• Small terminal box (Pg11)  (File name : Page 330 or Ending 27)
 FAD-L10A/15A-2G
2HS

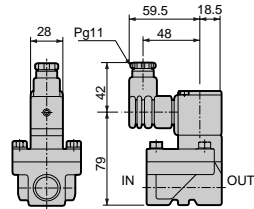

• Conduit (CTC19/G1/2)  (File name : Page 330 or Ending 27)
 FAD-L10A/15A-2CG
2CH

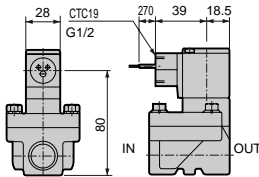

• T type terminal box  (File name : Page 330 or Ending 27)
 FAD-L10A/15A-3T
3RS

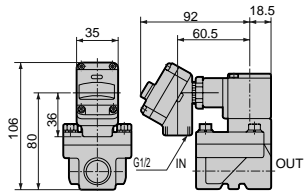

• Mounting plate  (File name : Page 330 or Ending 27)
 FAD-8A/10A- * B

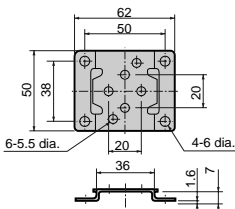

• Mounting plate  (File name : Page 330 or Ending 27)
 FAD-L10A/15A- * B

