

# Kerotest Needle and Gauge Valves

## N28 Soft Seated Needle Valve



### Product Brief

A rugged, forged construction delivers dependable, leak-free performance at high and low pressures. Designed to measure and regulate flow in processing plants and oil and gas production applications, these valves perform in tight spaces and resist low-level corrosiveness. With optional trim, they also resist sour fluid environments, caustic liquids and corrosive media.

### Features/Benefits

- **Maximum operating pressure:** 10,000 psi @ 100° F (38° C).
- **Operation:** Bubble-tight shutoff for liquids or gas from 6,000 psi to 10,000 psi.
- **Temperature limits:** Maximum temperature 275° F (135° C).
- **Stem material:** Precision-machined, heat-treated stem prevents sulfide stress cracking.
- **Handle:** Two-prong or easy-grip T-handles.
- **Connection:** Female pipe ends per ANSI B1.20.1, socket weld ends per ANSI B16.11.
- **Finish:** Stainless steel and clear zinc plating.
- **Assembly:** Replaceable seat assembly.
- **Safety:** Integral back-seated stem prevents accidental removal.



*An Employee-Owned Company*

# Kerotest Needle and Gauge Valves

## N28 Soft Seated Needle Valve

### Product Description

Description	Carbon Steel
Body	ASTM-A108 Gr. 1213 ①
Stem	ASTM-A582 Type 416
Packing Nut	ASTM-A108 Gr. 1213 ①
Panel Mount Nut	ASTM-A582 Type 303
Packing Washer	AISI-C1010 ①
Packing	Virgin Teflon®
Handle	Carbon Steel ②
Handle Nut	Plated Steel

#### Notes

- ① Zinc plated.
- ② Yellow zinc plated.

### Ordering Code/Specifications

Size	Catalog Number	Inlet Size Outlet Size	Body Material	Stem Material	Max. Temp.	Bonnet Type	Approx. Weight (lbs)
1/4"	P-0N28-49-002-A01	1/4" Female NPT	ASTM-A108 AISI 1045 Carbon Steel	ASTM-A582 416 Stainless Steel	275° F 135° C	Integral	0.81
3/8"	P-0N28-49-003-A01	3/8" Female NPT					1.16
1/2"	P-0N28-49-004-A01	1/2" Female NPT					1.16
3/4"	P-0N28-49-006-A01	3/4" Female NPT					1.83
1"	P-0N28-49-008-A01	1" Female NPT					3.12

### Dimensions

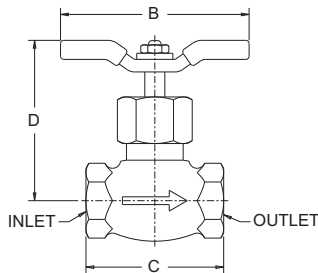

Note: Approximate dimensions in Inches (mm).

Size	A Width	B Handle Width	C End-to-End	D CL-to-Top (Open)	E Hex Flat-to-Flat
1/4"	1.07 (27.2)	3.00 (76.2)	2.06 (52.3)	2.56 (65.1)	1.00 (25.4)
3/8"	1.25 (31.8)	3.00 (76.2)	2.50 (63.5)	2.69 (68.3)	1.25 (31.8)
1/2"	1.25 (31.8)	3.00 (76.2)	2.50 (63.5)	2.69 (68.3)	1.25 (31.8)
3/4"	1.38 (35.1)	4.00 (101.6)	3.00 (76.2)	3.03 (77.0)	1.50 (38.1)
1"	1.88 (47.8)	4.00 (101.6)	3.75 (95.3)	3.22 (81.8)	2.00 (50.8)

All product names referenced herein are trademarks of their respective companies.



#### Kerotest Manufacturing Corp.

5500 Second Avenue • Pittsburgh, PA 15207  
 412.521.7688 • Fax: 412.521.5990  
 www.Kerotest.com • Sales@Kerotest.com