

Kerotest Needle and Gauge Valves

N28 Integral Union Bonnet Needle Valve



Product Brief

A rugged, forged construction delivers dependable, leak-free performance at high and low pressures. Designed to measure and regulate flow in processing plants and oil and gas production applications, these valves perform in tight spaces and resist low-level corrosiveness. With optional trim, they also resist sour fluid environments, caustic liquids and corrosive media.

Features/Benefits

- **Maximum operating pressure:** 10,000 psi @ 100° F (38° C).
- **Operation:** Bubble-tight shutoff for liquids or gas from 6,000 psi to 10,000 psi.
- **Temperature limits:** Maximum temperature 500° F (260° C).
- **Stem material:** Precision-machined, heat-treated stem prevents sulfide stress cracking.
- **Handle:** Two-prong or easy-grip T-handles.
- **Connection:** Female pipe ends per ANSI B1.20.1, socket weld ends per ANSI B16.11.
- **Finish:** Stainless steel and clear zinc plating.
- **Assembly:** Replaceable seat assembly.
- **Safety:** Integral back-seated stem prevents accidental removal.



An Employee-Owned Company

Kerotest Needle and Gauge Valves N28 Integral Union Bonnet Needle Valve

Product Description

Description	Carbon Steel	Stainless Steel
Body	ASTM-A108 Gr. 1213 ①	ASTM-A182 Type 316
Stem	ASTM-A582 Type 416	ASTM-A582 Type 303
Packing Nut	ASTM-A108 Gr. 1213 ①	ASTM-A582 Type 303
Panel Mount Nut	ASTM-A582 Type 303	N/A
Packing Washer	AISI-C1010 ①	18-8 Stainless Steel
Packing	Virgin Teflon®	Virgin Teflon®
Handle	Carbon Steel ②	Carbon Steel ②
Handle Nut	Plated Steel	Plated Steel

Notes

- ① Zinc plated.
- ② Yellow zinc plated.

Ordering Code/Specifications

Size	Catalog Number	Inlet Size Outlet Size	Body Material	Stem Material	Max. Temp.	Bonnet Type	Approx. Weight (lbs)
1/4"	P-ON28-49-002	1/4" Female NPT	ASTM-A108 AISI 1045 Carbon Steel	ASTM-A582 416 Stainless Steel	500° F 260° C	Integral	0.81
	T-ON28-49-002		ASTM-A182 316 Stainless Steel	ASTM-A582 303 Stainless Steel			0.81
	P-ON28-96-002	1/4" Socket Weld	ASTM-A108 AISI 1045 Carbon Steel	ASTM-A582 416 Stainless Steel	0.81		
3/8"	P-ON28-49-003	3/8" Female NPT	ASTM-A108 AISI 1045 Carbon Steel	ASTM-A582 416 Stainless Steel	500° F 260° C	Integral	1.16
	T-ON28-49-003		ASTM-A182 316 Stainless Steel	ASTM-A582 303 Stainless Steel			1.16
1/2"	P-ON28-49-004	1/2" Female NPT	ASTM-A108 AISI 1045 Carbon Steel	ASTM-A582 416 Stainless Steel	500° F 260° C	Integral	1.16
	T-ON28-49-004		ASTM-A182 316 Stainless Steel	ASTM-A582 303 Stainless Steel			1.16
	P-ON28-96-004	1/2" Socket Weld	ASTM-A108 AISI 1045 Carbon Steel	ASTM-A582 416 Stainless Steel	1.16		
	T-ON28-96-004		ASTM-A182 316 Stainless Steel	ASTM-A582 303 Stainless Steel	1.16		
3/4"	P-ON28-49-006	3/4" Female NPT	ASTM-A108 AISI 1045 Carbon Steel	ASTM-A582 416 Stainless Steel	500° F 260° C	Integral	1.83
	T-ON28-49-006		ASTM-A182 316 Stainless Steel	ASTM-A582 303 Stainless Steel			1.83
	P-ON28-96-006	3/4" Socket Weld	ASTM-A108 AISI 1045 Carbon Steel	ASTM-A582 416 Stainless Steel	1.83		
	T-ON28-96-006		ASTM-A182 316 Stainless Steel	ASTM-A582 303 Stainless Steel	1.83		
1"	P-ON28-49-008	1" Female NPT	ASTM-A108 AISI 1045 Carbon Steel	ASTM-A582 416 Stainless Steel	500° F 260° C	Integral	3.12
	T-ON28-49-008		ASTM-A182 316 Stainless Steel	ASTM-A582 303 Stainless Steel			3.12
	P-ON28-96-008	1" Socket Weld	ASTM-A108 AISI 1045 Carbon Steel	ASTM-A582 416 Stainless Steel	3.12		
	T-ON28-96-008		ASTM-A182 316 Stainless Steel	ASTM-A582 303 Stainless Steel	3.12		

Dimensions

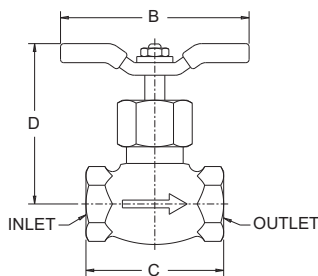

Note: Approximate dimensions in Inches (mm).

Size	A Width	B Handle Width	C End-to-End	D CL-to-Top (Open)	E Hex Flat-to-Flat
1/4"	1.07 (27.2)	3.00 (76.2)	2.06 (52.3)	2.56 (65.1)	1.00 (25.4)
3/8"	1.25 (31.8)	3.00 (76.2)	2.50 (63.5)	2.69 (68.3)	1.25 (31.8)
1/2"	1.25 (31.8)	3.00 (76.2)	2.50 (63.5)	2.69 (68.3)	1.25 (31.8)
3/4"	1.38 (35.1)	4.00 (101.6)	3.00 (76.2)	3.03 (77.0)	1.50 (38.1)
1"	1.88 (47.8)	4.00 (101.6)	3.75 (95.3)	3.22 (81.8)	2.00 (50.8)

All product names referenced herein are trademarks of their respective companies.



Kerotest Manufacturing Corp.

5500 Second Avenue • Pittsburgh, PA 15207
412.521.7688 • Fax: 412.521.5990
www.Kerotest.com • Sales@Kerotest.com