

W

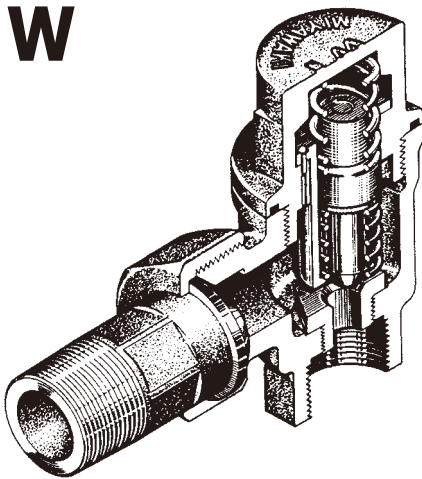

W1



W2

Capacity Chart W1, W2, W3

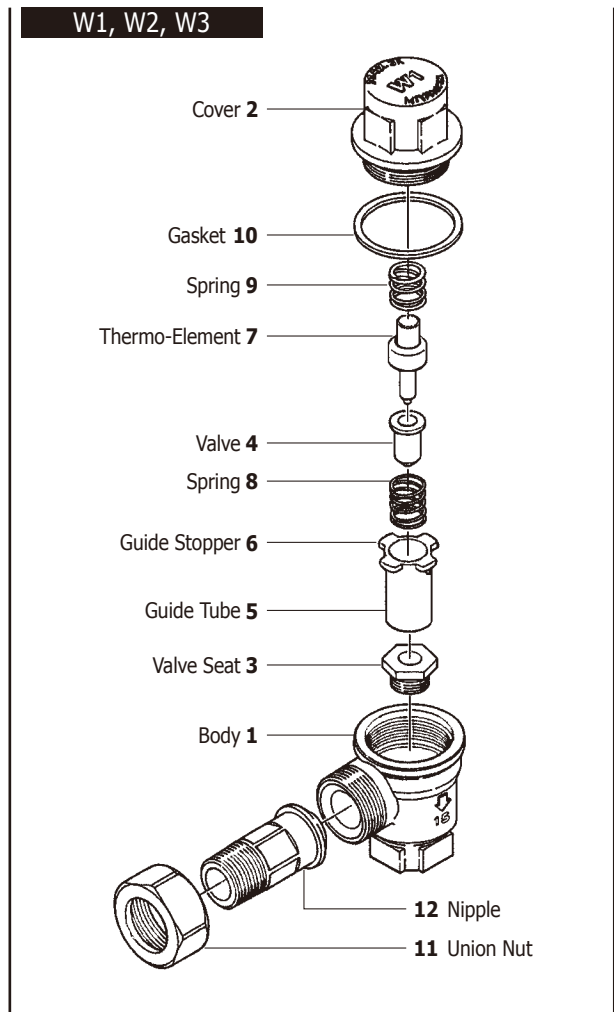
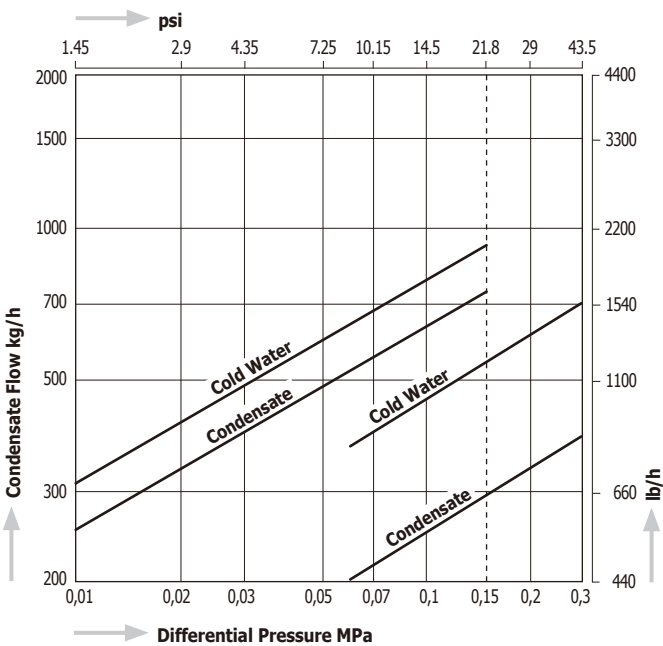

The opening temperature of the valve is preset
 - at about 97°C (207° F) for W1-1,5, W2-1,5 and W3-1,5
 - at about 115°C (239° F) for W1-3, W2-3 and W3-3

Dimensions

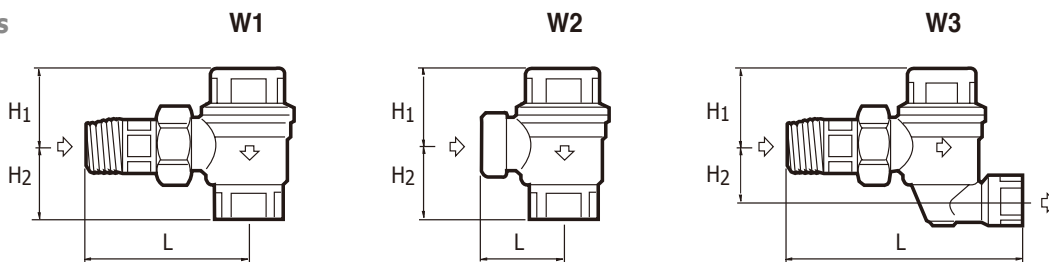

Model	Connections	Size	Max. Operating Pressure		Max. Operating Temperature		Dimensions (mm)			Dimensions (in)			Body Material	Weight	
			MPa	psig	°C	°F	L	H ₁	H ₂	L	H ₁	H ₂		kg	lb
W1-1,5	Screwed Rc, NPT	1/2"	0,15	21.8	150	302	80	35	3.1	1.4	Brass C3771	0,5	1.1		
		3/4"					87					41	3.4	0,6	1.3
1/2"		0,3	43.5	80			35					3.1	0,5	1.1	
3/4"				87									41	3.4	0,6
W2-1,5	Screwed Rc, NPT	1/2"	0,15	21.8	150	302	35	42	1.4	1.7	Brass C3771	0,4	0.9		
		3/4"					35					41	1.6	0,5	1.1
1/2"		0,3	43.5	35			35					1.4	0,4	0.9	
3/4"				41									1.6	0,5	1.1
W3-1,5	Screwed Rc, NPT	1/2"	0,15	21.8	150	302	123	28	4.8	1.1	Brass C3771	0,6	1.3		
		3/4"					135					34	5.3	0,7	1.5
1/2"		0,3	43.5	123			28					4.8	0,6	1.3	
3/4"				135									34	5.3	0,7