



®

CORPORATION

ELECTRICALLY ACTUATED DRIP TRAP

MODEL 8490

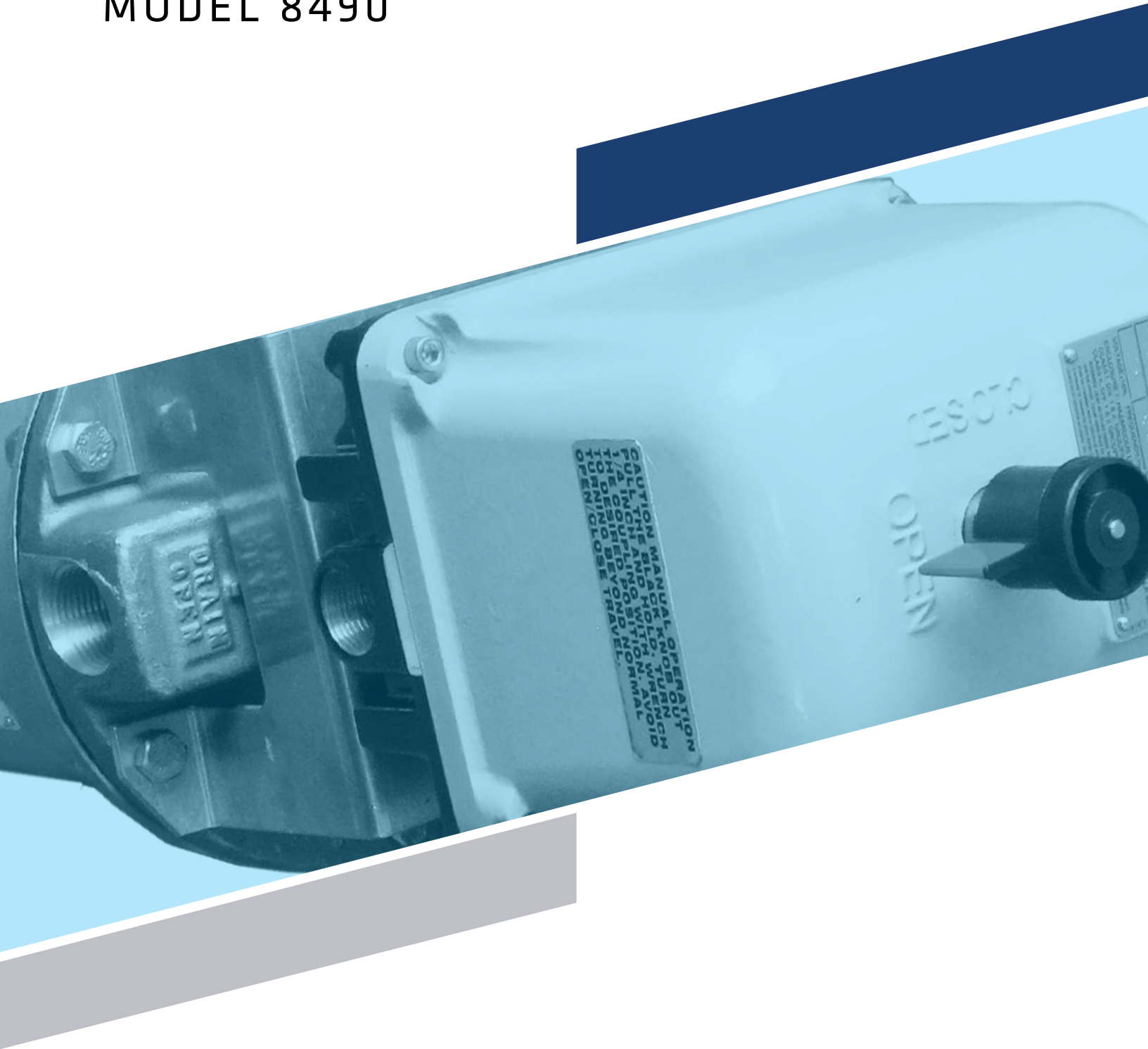

MODEL 8490

The Groth Model 8490 electrically operated drip trap combines the reliability of a rotating disc manual drip trap with the convenience of an automatic drip trap. It can be controlled by an integral cycle timer, a Groth remote sequence controller, or the owner's master control system.

Technical Details

- Pressure: 5 or 60 PSI pressure rating
- 3 or 6 quart bowl
- NEMA 7 Explosion-proof actuator housing
- Aluminum construction

Features

- Reliable, low maintenance rotating disc drip trap
- Heavy duty electric actuator
- Visual position indicator
- Electronic contacts for remote position indication
- Override for manual operation

Options

- Integral cycle timer
- Remote control panel
- Insulating jacket
- Actuator heater



SPECIFICATIONS

Size Qt (liters)	A Height Inches (mm)	B Width Inches (mm)	Approx Ship. Weight Aluminum Lbs. (kg)
3 (2.8)	21.32 (541.5)	8.38 (212.8)	28.61 (12.98)
6 (5.7)	22.44 (570.0)	8.38 (212.8)	31.97 (14.50)

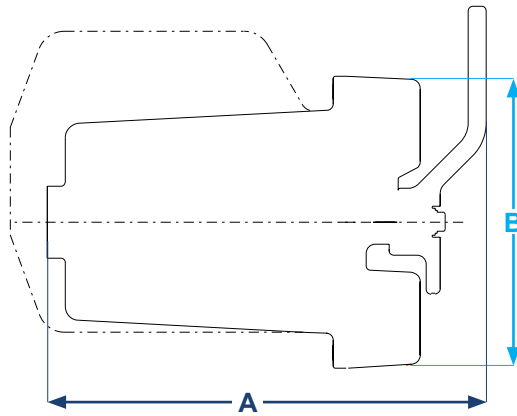

HOW TO ORDER

For easy ordering, select proper model numbers

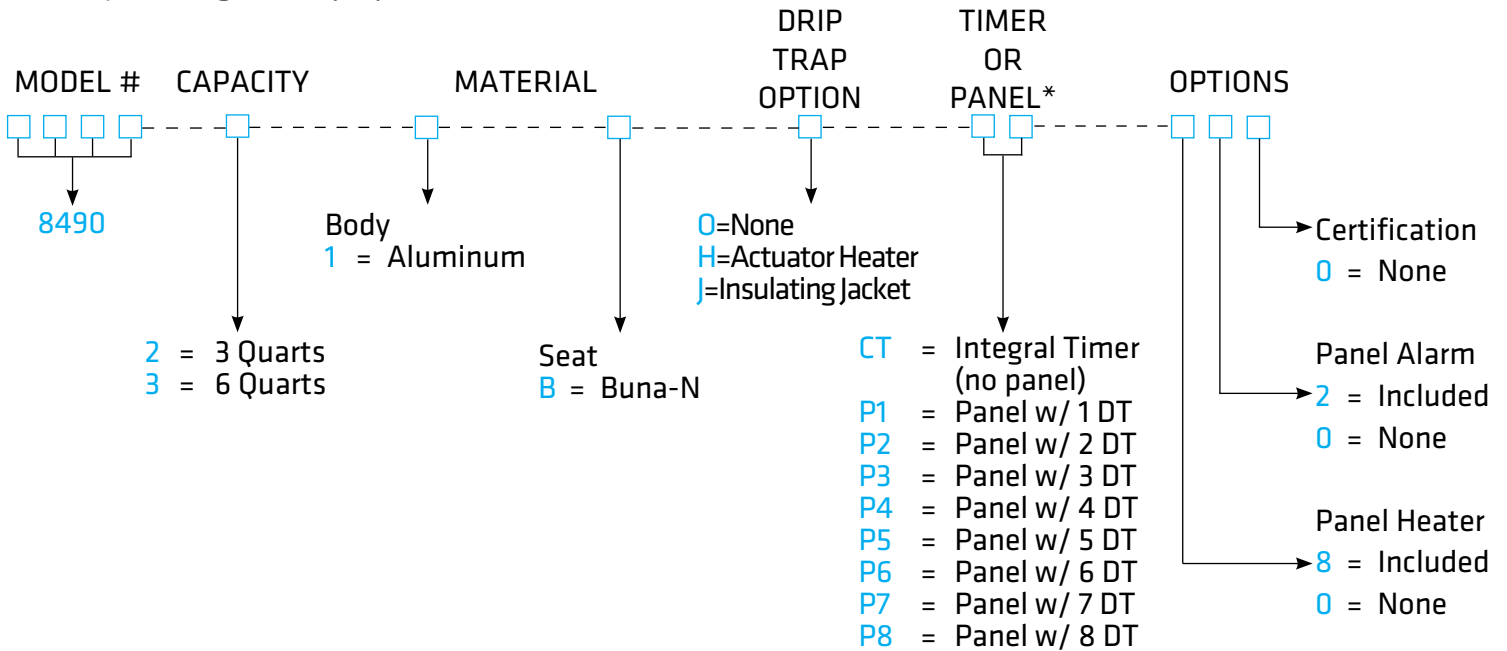

NOTES

- *IMPORTANT - Please choose the correct model number when ordering a single control panel and multiple drip traps to ensure the correct quantity of panels and traps are selected
- For special options, consult factory

EXAMPLE

8 4 9 0 — 2 — 1 — B — O — C T — 0 0 0

Indicates a 3 quart Electrically Actuated Drip Trap with Aluminum body, Buna-N seal and Integral Cycle Timer.



GROTHCORP.COM