

# Buttweld End with Access

## Type BWA

Buttweld End design with top bonnet access for inspection purposes. For direct welding into a piping system. Can be provided with transition and/or pup pieces.

### Retainerless

- Retainerless is standard in Goodwin Check Valves
- No screwed body plugs  
Note: Bolted bonnet for inspection

### API 594

- Designed in accordance with API 594 / API 6D
- Face-to-face dimensions to Goodwin standard

### Unique Plate Design

- Pressure sensitive plate
- Improved flow efficiencies
- Total Life Cycle Costs reduced
- Superior metal-to-metal sealing
- High degree of shut-off

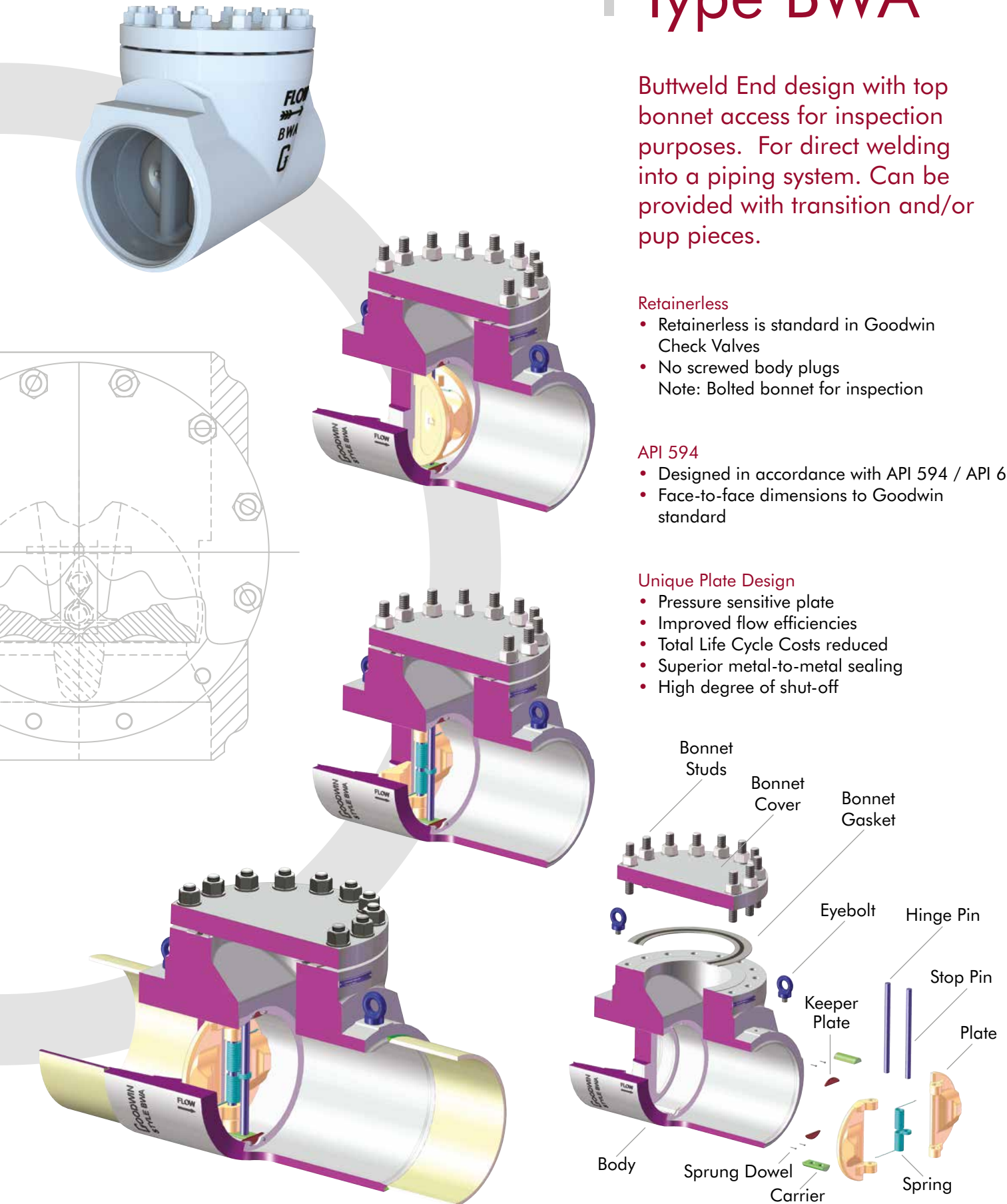

# Type BWA

## Installation Dimensions

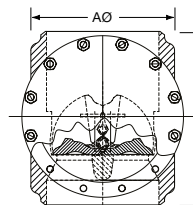

Size mm	Pressure Rating ASME	A mm	B mm	Δ Valve Weight kg
4 (100mm)	150	129.5	305	23
	300	129.5	305	25
	600	135.6	356	28
	900	146.7	356	41
	1500	155.1	406	53
6 (150mm)	150	168.3	406	51
	300	168.3	406	51
	600	171.9	508	62
	900	228.8	508	91
	1500	228.8	559	130
8 (200mm)	150	226.5	457	79
	300	226.5	457	89
	600	239.5	610	153
	900	252.2	660	208
	1500	284.2	711	298
10 (250mm)	150	270.6	533	138
	300	270.6	533	138
	600	289.4	737	274
	900	305.7	787	347
	1500	346.5	864	525
12 (300mm)	150	329.5	610	195
	300	329.5	610	214
	600	351.8	813	421
	900	372.6	914	591
	1500	419.2	991	860
14 (350mm)	150	380.0	686	301
	300	380.0	686	334
	600	381.8	889	656
	900	381.8	991	834
	1500	429.6	1067	1016
16 (400mm)	150	425.3	737	401
	300	425.3	737	451
	600	441.0	991	861
	900	469.5	1092	1118
	1500	493.8	1194	1540

Size mm	Pressure Rating ASME	A mm	B mm	Δ Valve Weight kg
18 (450mm)	150	475.4	813	521
	300	475.4	813	591
	600	487.5	1092	1046
	900	519.5	1194	1474
	1500	555.4	1295	2081
20 (500mm)	150	526.7	864	684
	300	526.7	864	782
	600	539.9	1168	1423
	900	578.0	1321	1981
	1500	621.7	1372	2834
24 (600mm)	150	609.6	1067	1140
	300	609.6	1067	1228
	600	635.4	1295	2132
	900	680.1	1346	3065
	1500	738.5	1422	4089
28 (700mm)	150	711.2	1118	1382
	300	727.1	1118	1657
	600	774.3	1397	3152
	900	822.1	1448	4281
	1500	882.1	1549	5834
30 (750mm)	150	762.0	1168	1908
	300	768.4	1168	2093
	600	819.2	1448	3806
	900	868.9	1499	5103
	1500	930.2	1599	7037
32 (800mm)	150	812.8	1219	1997
	300	833.0	1219	2423
	600	887.3	1473	4604
	900	940.2	1524	6037
	1500	1003.2	1549	7174
36 (900mm)	150	914.4	1372	3054
	300	914.4	1372	3301
	600	944.8	1499	5555
	900	1003.2	1549	7174
	1500	1076.2	1549	8417
40 (1000mm)	150	1016.0	1422	4012
	300	1016.0	1422	4379
	600	1057.8	1524	7297
	900	1121.8	1575	9449
	1500	1206.8	1575	11944
42 (1050mm)	150	1066.8	1422	5042
	300	1066.8	1422	5440
	600	1109.6	1524	8327
	900	1175.6	1600	10630
	1500	1266.6	1600	13444
48 (1200mm)	150	1219.2	1524	6240
	300	1219.2	1524	8923
	600	1219.2	1626	11120
	900	1266.6	1700	14257
	1500	1366.6	1700	17944

Δ Weights are for valve only and exclude pup or transition pieces. Weight will vary according to corrosion allowance specification.

### PIPE SCHEDULE

Customer must state pipe schedule at time of enquiry as this may necessitate transition pieces. The nominal bore of the valve will be determined by the pipe schedule selected by the customer and be in accordance with ASME B16.25