



Cat.no.:E-PS



Cat.no.:E-GGC



Cat.no.:E-TMBV



Cat.no.:E-FBV



Cat.no.:E-DOV

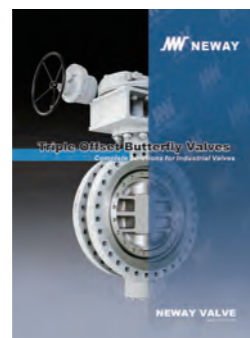

Cat.no.:E-TOV



Cat.no.:E-PLV

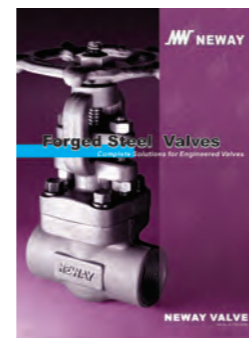

Cat.no.:E-FSV



Cat.no.:E-DAV



Cat.no.:E-CPS

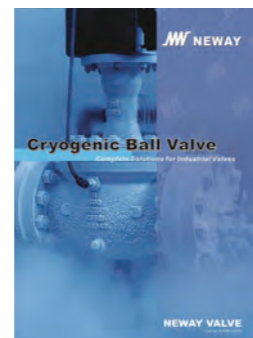

Cat.no.:E-CBV



Cat.no.:E-PV

JW NEWAY
NEWAY VALVE (SUZHOU) CO., LTD.

No.666 Taishan Road, Suzhou New District, P.R. China
Post Code:215129
Tel: 86-512-666-51365
Fax: 86-512-666-18930-2102
E-mail: overseas.sales@neway.com.cn
<http://www.newayvalve.com>

Distributed by:

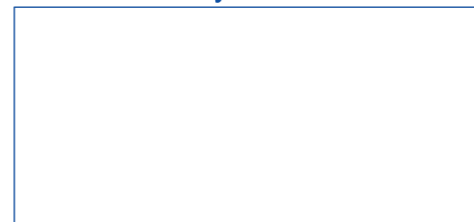

Cat.no.:E-MMBV-2020

JW NEWAY

Metal-Seated Ball Valve

Complete Solutions for Industrial Valves

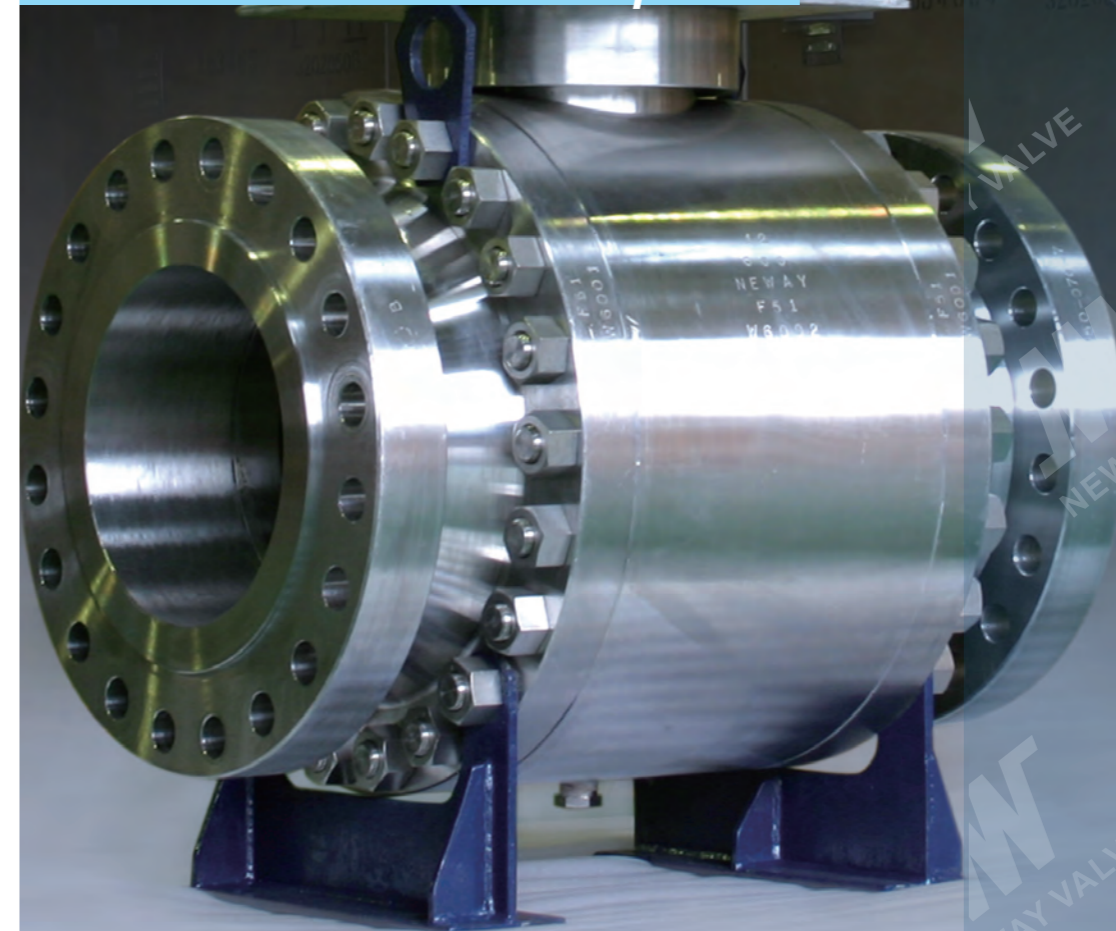

NEWAY VALVE

Cat.no.:E-MMBV-2020

Table of Contents

Introduction

1 Quality Commitment

2~3 How To Order

Metal-Seated Floating Ball Valve

4 Design Feature

5~6 Parts&Material

7~10 Dimension&Weight

Metal-Seated Trunnion Mounted Ball Valve

11 Design Feature

12~13 BSM Series Trunnion Mounted Ball Valve Parts & Material

14~15 BSK Series Trunnion Mounted Ball Valve Parts & Material

16~21 Dimension&Weight

22 Additional Feature Hardening Treatment FEA (finite element analysis)

23 Engineering Data (Torque Value)

24 Neway Factory



Complete Solutions for Industrial Valves

As a global leader of valve manufacturing, Neway(SSE:603699) is dedicated to the production, research, and development of industrial valves. Neway is committed to providing complete valve solutions to all industries through advanced engineering and innovation.

Neway's product line includes Ball, Butterfly, Gate, Globe, Check, Nuclear, Control, Subsea and Safety valves. Our high quality standards and innovative ability are recognized by many global end users and EPCs. Neway valves are utilized in a wide variety of industries and working conditions such as Refining, Chemical, Coal Chemical, Offshore(including subsea), Air Separation, LNG, Nuclear Power, Power Generation, and Pipeline Transmission applications.

Global Facilities & Service

Neway has developed a sophisticated multi-plant management system operating one valve assembly plant, one API6A valve plant, three foundries, and one R&D center. Our Largest assembly plant was expanded in 2013, and it now covers 230,000 square meters.

Advanced software (ANSYS, FE-Safe, CF-Design, Siemens PLM and NX) is applied here at Neway for the Research & Development of products. We use SAP to control the traceability and status of all products during the manufacturing process. In order to ensure the safety, eco-friendliness, and reliability of our products, we use the most advanced fire-safe, cryogenic, high pressure, and fugitive emission test equipment.

As part of Neway's global strategy, to provide better service to our customers, we have established our overseas subsidiaries in USA, Netherlands, Italy, Singapore and Dubai along with over 80 agents and distributors worldwide.

High Quality, High Value

Neway is dedicated to the pursuit of "Zero Defect". We maintain a quality management system that encompasses our entire operation from order entry, to final inspection. Through Neway's continuous efforts, our products have achieved industrial certificates including ISO 9001, API 6A, API 6D, CE/PED, ASME N & NPT, TA-Luft, ABS, CU-TR and Fire-Safe approvals.



NORSOK



TA Luft



CE/PED



ABS



AD2000



Fire Safe Test Certificate

Neway recognizes the importance of valve quality for the safety and protection of personnel health and property. It is our quality commitment to focus our resources to provide our customers with first class products at a competitive price, designed, manufactured, inspected and tested in accordance with our customers specifications and complying with all international standards. Current industrial standards do not always take into consideration the likelihood and consequences of possible deterioration in service, related to specific service fluids or the external environments in which they operate. Therefore we request that our customers communicate with our engineering department. Our valve optimization program continuously strives to provide valves that withstand deterioration in service, and ensure safety over the valves expected lifetime.

How To Order



Neway part numbers are designed to cover essential features. When ordering, Please show the figure numbers and detailed description to avoid misunderstanding of your requirements.

Following descriptions provide a basic guideline in valve specification:

① Valve Size

Full bore

in	1/2	3/4	1	1-1/2	2	2-1/2	3	4	6	8	10	12
mm	15	20	25	40	50	65	80	100	150	200	250	300
in	14	16	18	20	24	26	28	30	32	34	36	40
mm	350	400	450	500	600	650	700	750	800	850	900	1000

Reduced bore

in	1/2x3/8	3/4x1/2	1x3/4	1-1/2x1	2x1-1/2	2-1/2x2	3x2	4x3	6x4	8x6	10x8	12x10
mm	15x10	20x15	25x20	40x25	50x40	65x50	80x50	100x80	150x100	200x150	250x200	300x250
in	14x12	16x14	18x16	20x18	24x20	26x24	28x24	30x24	32x30	34x30	36x30	40x36
mm	350x300	400x350	450x400	500x450	600x500	650x600	700x600	750x600	800x750	850x750	900x750	1000x900

② Valve type

Symbol	Valve type	Symbol	Valve type
BM	2-pcs casting floating type metal seat	BSM	3-pcs forging trunnion mounted type metal seat
BBM	2-pcs forging floating type metal seat	BSK	2-pcs forging trunnion mounted type(O-ring) metal seat

③ Class & Pressure

Code	Class	Pressure (Mpa)	Code	Class	Pressure (Mpa)
1	150	2	8	800	14
3	300	5	9	900	15
4	400	6.8	15	1500	25
6	600	10	25	2500	42

④ End Connection

Symbol	End	Symbol	End	Symbol	End
R	Raised face flanged end	B	Butt-weld end	N	Screwed end
J	RTJ flanged end	S	Socket weld end	SN	Socket weld/Screwed end

⑤ Operator

Symbol	Description	SSymbol	Description
	Lever	BS	Bare shaft
G	Gear operator	H	Hydraulic actuator
M	Electric actuator	L	Gas over oil actuator
P	Pneumatic actuator	D	Electric over oil actuator

⑥ Body Materials

Classification Steel	Forged Material		Cast Material		Recommended Temperature Limits (°C)
Carbon Steel	A105N	C40	A216 Grade WCB	C00	-29~425
Carbon Steel	A350 Grade LF2	L70	A352 Grade LCB	L20	-46~350
Carbon Steel	A350 Grade LF2	L70	A352 Grade LCC	L21	-46~350
Duplex Stainless Steel	A182 Grade F51	D40	A995 Grade 4A	D03	-51~315
Duplex Stainless Steel	A182 Grade F53	D41	A995 Grade 5A	D10	-51~315
Austenitic Stainless Steel	A182 Grade F304	S40	A351 Grade CF8	S00	-196~815
Austenitic Stainless Steel	A182 Grade F316	S41	A351 Grade CF8M	S01	-196~815
Low Carbon Stainless Steel	A182 Grade F304L	S42	A351 Grade CF3	S02	-196~815
Low Carbon Stainless Steel	A182 Grade F316L	S43	A351 Grade CF3M	S03	-196~815

⑦ Trim Codes

Seat Insert		Packing/O-ring		Stem		Ball		Seat	
Code	Material	Code	Material	Code	Material	Code	Material	Code	Material
4	Ball-WC Seat-WC	1	NBR	1	F6a	1	F6a	1	F6a
6	Ball-NI60 Seat-NI55	2	VITON A	2	F304	2	F304	2	F304
9	Ball-WC Seat-NI55	3	VITON AED	3	A105N/ENP	3	A105N/ENP	3	A105N/ENP
E	Ball -Cr3C2-NiCr	4	VITON B	4	17-4PH	4	17-4PH	4	17-4PH
	Seat -Cr3C2-NiCr	6	HNBR	5	AISI 4140/ENP	5	AISI 4140/ENP	5	AISI 4140/ENP
F	Ball-WC Seat-NI60	8	VITON GLT	6	F316	6	F316	6	F316
		B	EPDM	7	F304L	7	F304L	7	F304L
				8	F316L	8	F316L	8	F316L
				9	LF2/ENP	9	LF2/ENP	9	LF2/ENP
				A	F51	A	F51	A	F51

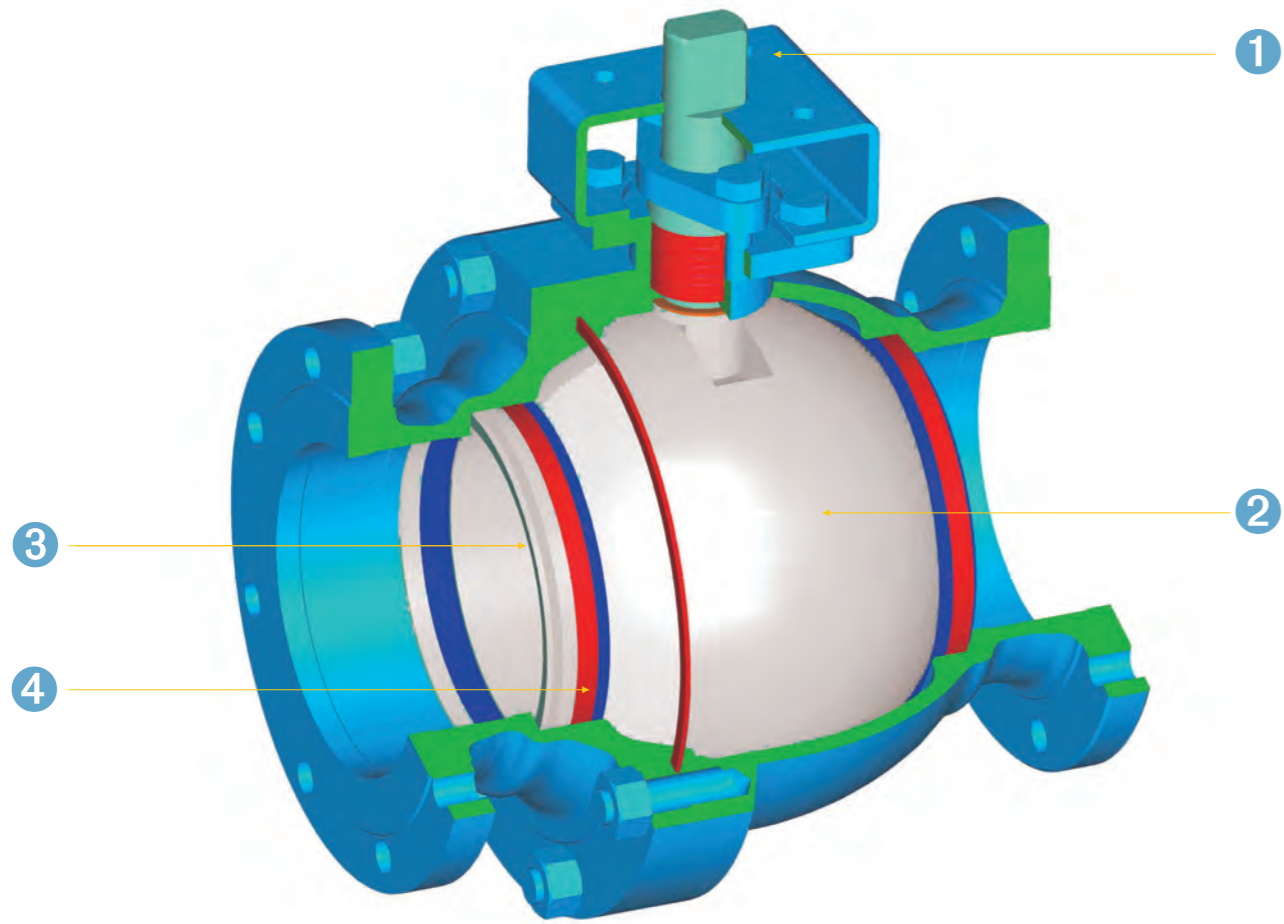

- 1 Top flange design as per ISO 5211, optional actuators of gearbox, electric actuator and pneumatic actuator are available.
- 2 Hard faced ball and the seat to satisfy the requirement of high hardness, high temperature resistance, wear resistance.
- 3 With the help of the pre-loaded spring, the seat is able to maintain seal even in low operating pressure.
- 4 Several designs of the seat to choose from, among which the dust proof seat design is available.

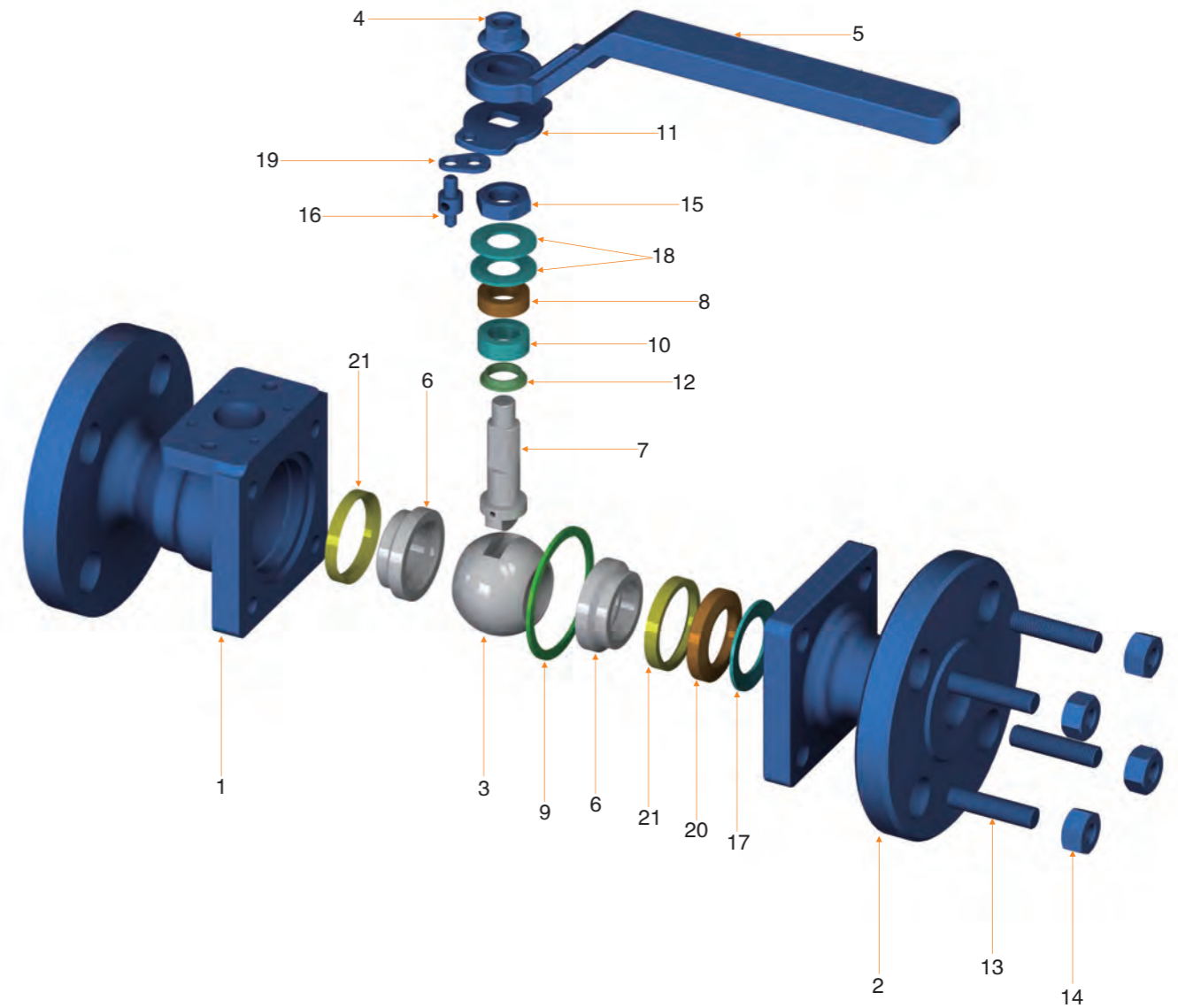

序号	英文名称	标准材料	酸性环境	不锈钢	低温环境
1	BODY	ASTM A105N	ASTM A105N	ASTM A182 F316	ASTM A350 LF2
2	BONNET	ASTM A105N	ASTM A105N	ASTM A182 F316	ASTM A350 LF2
3	BALL	ASTM A182 F316+WC	ASTM A182 F316+WC	ASTM A182 F316+WC	ASTM A182 F316+WC
4	LEVER	AISI 1045	AISI 1045	ASTM A276 304	ASTM A276 304
5	GLAND FLANGE	AISI 1035	AISI 1035	ASTM A276 304	ASTM A276 304
6	SEAT RING	ASTM A182 F316+WC	ASTM A182 F316+WC	ASTM A182 F316+WC	ASTM A182 F316+WC
7	SEAT GLAND	ASTM A182 F316	ASTM A182 F316	ASTM A182 F316	ASTM A182 F316
8	STEM	17-4PH	17-4PH	17-4PH	17-4PH
9	GLAND	ASTM A182 F304L	ASTM A182 F304L	ASTM A182 F304L	ASTM A182 F304L
10	THRUST WASHER	ASTM A182 F316L+N2	ASTM A182 F316L+N2	ASTM A182 F316L+N2	ASTM A182 F316L+N2
11	GASKET	316+GRAPHITE	316+GRAPHITE	316+GRAPHITE	316+GRAPHITE
12	PACKING	GRAPHITE	GRAPHITE	GRAPHITE	GRAPHITE
13	GASKET	GRAPHITE	GRAPHITE	GRAPHITE	GRAPHITE
14	BOLT	ASTM A193 B7	ASTM A193 B7M	ASTM A193 B8	ASTM A320 L7M
15	SPRING	INCONEL X-750	INCONEL X-750	INCONEL X-750	INCONEL X-750
16	STUD	ASTM A193 B7	ASTM A193 B7M	ASTM A193 B8	ASTM A320 L7M
17	NUT	ASTM A194 2H	ASTM A194 2HM	ASTM A194 8	ASTM A194 7M
18	COVER FLANGE	ASTM A216 WCB	ASTM A216 WCB	ASTM A182 F316	ASTM A350 LF2
19	PIN	ASTM A276 420	ASTM A276 420	ASTM A276 420	ASTM A276 420
20	GASKET	316+GRAPHITE	316+GRAPHITE	316+GRAPHITE	316+GRAPHITE
21	STOP PLATE	AISI 1045	AISI 1045	ASTM A276 420	ASTM A276 420
22	RETAINER	AISI 1066	AISI 1066	ASTM A276 304	ASTM A276 304
23	BOLT	AISI 1035	AISI 1035	ASTM A276 304	ASTM A276 304
24	WASHER	AISI 1035	AISI 1035	ASTM A276 304	ASTM A276 304
25	PIN	AISI 1035	AISI 1035	ASTM A276 304	ASTM A276 304
26	SCREW	AISI 1035	AISI 1035	ASTM A276 304	ASTM A276 304
27	LOCK PLATE	ASTM A276 304	ASTM A276 304	ASTM A276 304	ASTM A276 304
28	PIN	AISI 1035	AISI 1035	ASTM A276 304	ASTM A276 304

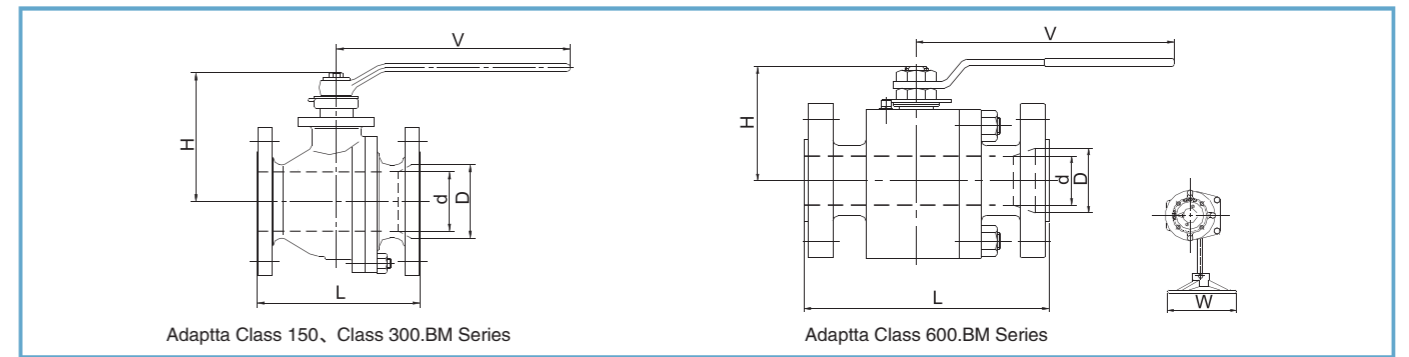

Class 150 Full bore (Floating)

Size		D		L				H		W		V		Weight	
in	mm	in	mm	RF		BW		in	mm	in	mm	in	mm	lb	Kg
1/2	15	0.51	13	4.25	108	5.49	139.5	2.23	56.6			5.51	140	4.41	2
3/4	20	0.75	19	4.61	117	6.00	152.5	2.32	59			5.51	140	6.61	3
1	25	0.98	25	5.00	127	6.50	165	3.29	83.5			8.46	215	8.82	4
1-1/2	40	1.50	38	6.50	165	7.52	191	4.63	117.5			10.43	265	17.64	8
2	50	2.01	51	7.01	178	8.50	216	5.15	130.8			16.93	430	22.05	10
3	80	2.99	76	7.99	203	11.14	283	6.90	175.3			41.73	1060	35.27	16
4	100	4.02	102	9.02	229	12.01	305	7.65	194.3			41.73	1060	88.18	40

Class 150 Reduced bore (Floating)

Size		D		d	L				H		W		V		Weight		
in	mm	in	mm	in	mm	RF		BW		in	mm	in	mm	in	mm	lb	Kg
1/2*3/8	15*10	0.51	13	0.28	7	4.25	108	5.49	139.5	1.93	49			5.51	140	3.31	1.5
3/4*1/2	20*15	0.75	19	0.51	13	4.61	117	6.00	152.5	2.23	56.6			5.51	140	4.41	2
1*3/4	25*20	0.98	25	0.75	19	5.00	127	6.50	165	2.32	59			5.51	140	6.61	3
1-1/2*1	40*25	1.50	38	0.98	25	6.50	165	7.52	191	3.29	83.5			8.46	215	15.43	7
2*1-1/2	50*40	2.01	51	1.50	38	7.01	178	8.50	216	4.63	117.5			10.43	265	17.64	8
3*2	80*50	2.99	76	2.01	51	7.99	203	11.14	283	5.15	130.8			10.43	265	30.86	14
4*3	100*80	4.02	102	2.99	76	9.02	229	12.01	305	6.90	175.3			16.93	430	79.37	36

Class 300 Full bore (Floating)

Size		D		L				H		W		V		Weight	
in	mm	in	mm	RF		BW		in	mm	in	mm	in	mm	lb	Kg
1/2	15	0.51	13	5.51	140	5.51	140	2.23	56.6			5.51	140	6.61	3
3/4	20	0.75	19	5.98	152	5.98	152	2.32	59			5.51	140	8.82	4
1	25	0.98	25	6.50	165	6.50	165	3.29	83.5			8.46	215	13.23	6
1-1/2	40	1.50	38	7.52	191	7.52	191	4.63	117.5			10.43	265	24.25	11
2	50	2.01	51	8.50	216	8.50	216	5.15	130.8			16.93	430	33.07	15
3	80	2.99	76	11.14	283	11.14	283	6.90	175.3			41.73	1060	103.62	47
4	100	4.02	102	12.01	305	12.01	305	10.04	255	11.81	300			149.91	68

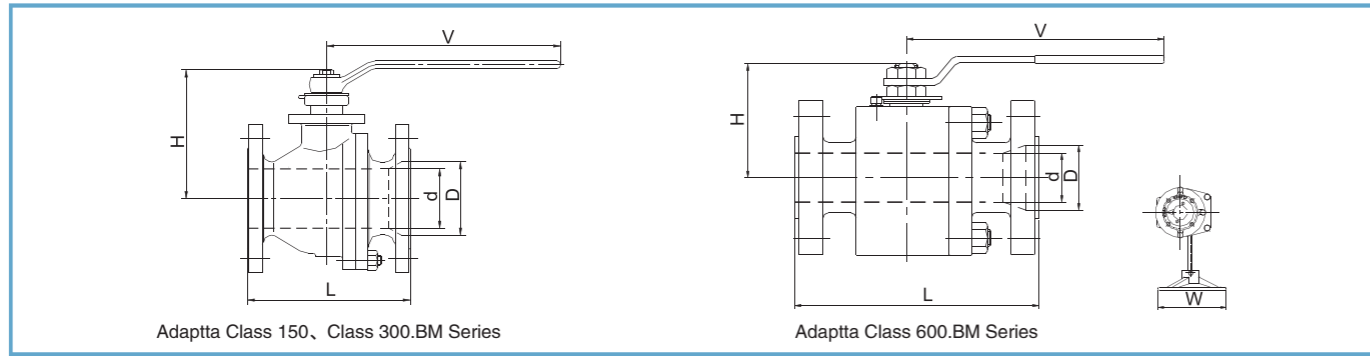

Class 1500 Full bore (Floating)

Size		D		L						H		W		V		Weight	
				RF		BW		RTJ									
in	mm	in	mm	in	mm	in	mm	in	mm	in	mm	in	mm	in	mm	lb	Kg
1/2	15	0.51	13	8.50	216	8.50	216	8.50	216	4.41	112			7.09	180	22.05	10
3/4	20	0.75	19	9.02	229	9.02	229	9.02	229	4.25	120.5			10.43	265	28.66	13
1	25	0.98	25	10.00	254	10.00	254	10.00	254	6.24	158.5			11.81	300	33.07	15
1-1/2	40	1.50	38	12.01	305	12.01	305	12.01	305	7.49	190			15.75	400	105.82	48
2	50	2.01	51	14.49	368	14.49	368	14.61	371	11.42	290	15.75	400			158.73	72

Class 1500 Reduced bore (Floating)

口径		D		d		L						H		W		V		Weight	
						RF		BW		RTJ									
in	mm	in	mm	in	mm	in	mm	in	mm	in	mm	in	mm	in	mm	in	mm	lb	Kg
1/2*3/8	15*10	0.51	13	0.28	7	8.50	216	8.50	216	8.50	216	4.17	106			6.50	165	17.64	8
3/4*1/2	20*15	0.75	19	0.51	13	9.02	229	9.02	229	9.02	229	4.41	112			7.09	180	19.84	9
1*3/4	25*20	0.98	25	0.75	19	10.00	254	10.00	254	10.00	254	4.74	120.5			10.43	265	26.46	12
1-1/2*1	40*25	1.50	38	0.98	25	12.01	305	12.01	305	12.01	305	6.24	158.5			11.81	300	30.86	14
2*1-1/2	50*40	2.01	51	1.50	38	14.49	368	14.49	368	14.61	371	7.48	190			15.75	400	99.21	45

Class 2500 Full bore (Floating)

口径		D		L						H		W		V		Weight	
				RF		BW		RTJ									
in	mm	in	mm	in	mm	in	mm	in	mm	in	mm	in	mm	in	mm	lb	Kg
1/2	15	0.51	13	10.39	264	10.39	264	10.39	264	4.53	115			7.09	180	26.46	12
3/4	20	0.75	19	10.75	273	10.75	273	10.75	273	4.65	118			10.43	265	35.27	16
1	25	0.98	25	12.13	308	12.13	308	12.13	308	6.97	177			11.81	300	41.89	19
1-1/2	40	1.50	38	14.49	368	14.49	368	14.49	368	8.03	204			15.75	400	108.02	49
2	50	1.65	42	17.76	451	17.76	451	17.87	454	11.73	298	15.75	400			169.75	77

Class 2500 Reduced bore (Floating)

口径		D		d		L						H		W		V		Weight	
						RF		BW		RTJ									
in	mm	in	mm	in	mm	in	mm	in	mm	in	mm	in	mm	in	mm	in	mm	lb	Kg
1/2*3/8	15*10	0.51	13	0.28	7	10.39	264	10.39	264	10.39	264	3.70	94			6.30	160	19.84	9
3/4*1/2	20*15	0.75	19	0.51	13	10.75	273	10.75	273	10.75	273	4.53	115			7.09	180	26.46	12
1*3/4	25*20	0.98	25	0.75	19	12.13	308	12.13	308	12.13	308	4.65	118			10.43	265	34.17	15.5
1-1/2*1	40*25	1.50	38	0.98	25	14.49	368	14.49	368	14.49	368	6.97	177			11.81	300	92.59	42
2*1-1/2	50*40	1.65	42	1.50	38	17.76	451	17.76	451	17.87	454	8.03	204			15.75	400	152.12	69

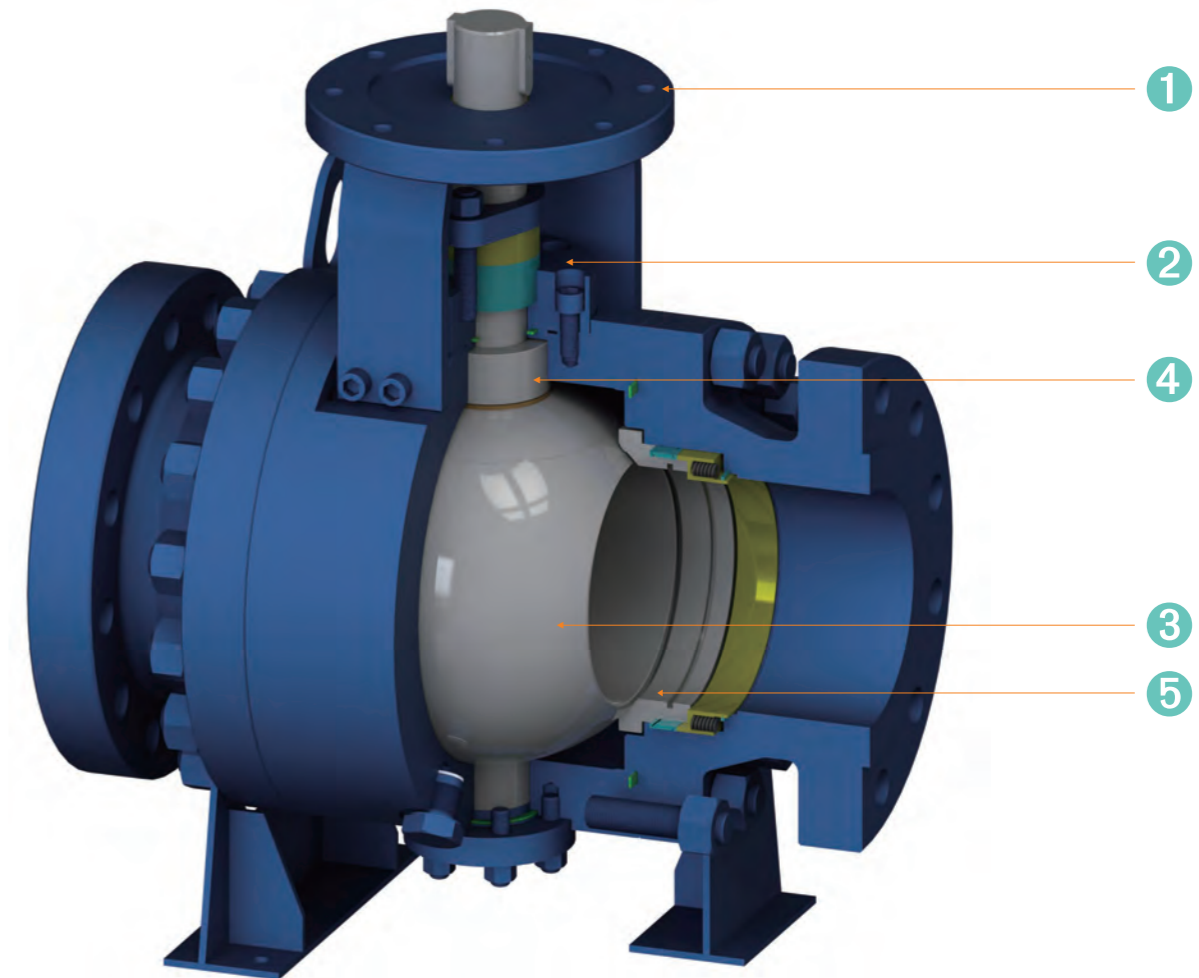

- 1 Top flange design as per ISO 5211, optional actuators of gearbox, electric actuator and pneumatic actuator are available.
- 2 Low emission graphite packing design.
- 3 Hard faced ball and the seat to satisfy the requirement of high hardness, high temperature resistance, wear resistance.
- 4 With the help of the pre-loaded spring, the seat is able to maintain seal even in low operating pressure.
- 5 Several designs of the seat to choose from, among which the dust proof seat design is available.

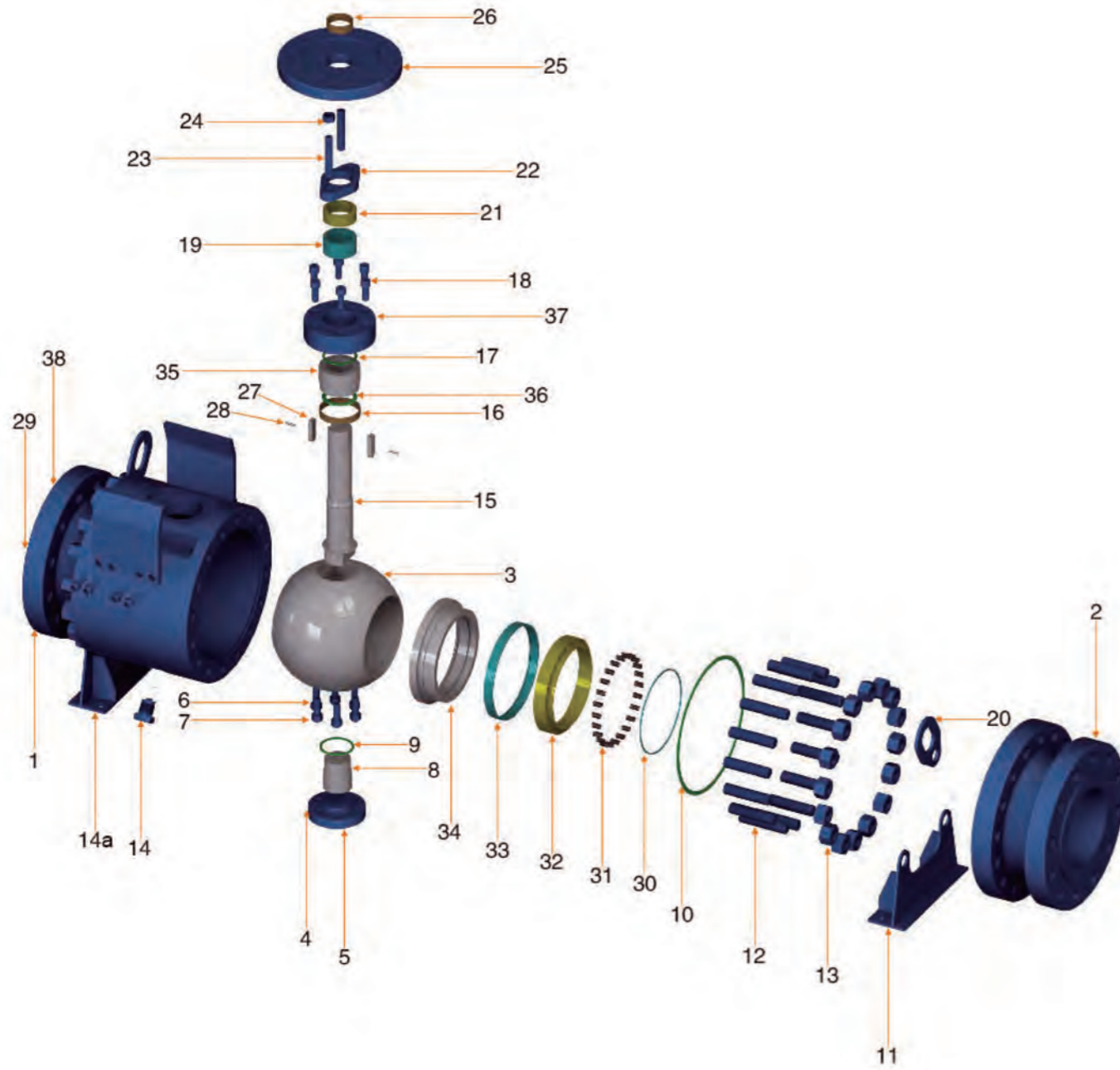

No.Parts Standard Material Sour Condition Stainless Steel Low Temperature Condition

序号	英文名称	标准材料	酸性环境	不锈钢	低温环境
1	BODY	ASTM A105N	ASTM A105N	ASTM A182 F316	ASTM A350 LF2
2	BONNET	ASTM A105N	ASTM A105N	ASTM A182 F316	ASTM A350 LF2
3	BALL	ASTM A182 F316+WC	ASTM A182 F316+WC	ASTM A182 F316+WC	ASTM A182 F316+WC
4	TRUNNION	ASTM A105N+CrC	ASTM A105N+CrC	17-4PH+CrC	ASTM A350 LF2+CrC
5	COVER	ASTM A105N	ASTM A105N	ASTM A182 F316	ASTM A350 LF2
6	STUD	ASTM A193 B7	ASTM A193 B7M	ASTM A193 B8	ASTM A320 L7M
7	NUT	ASTM A194 2H	ASTM A194 2HM	ASTM A194 8	ASTM A194 7M
8	BEARING	ASTM A182 F316L-N2	ASTM A182 F316L-N2	ASTM A182 F316L-N2	ASTM A182 F316L-N2
9	GASKET	316+GRAPHITE	316+GRAPHITE	316+GRAPHITE	316+GRAPHITE
10	GASKET	316+GRAPHITE	316+GRAPHITE	316+GRAPHITE	316+GRAPHITE
11	SUPPORT LEGS	ASTM A283 GRD	ASTM A283 GRD	ASTM A283 GRD	ASTM A283 GRD
12	STUD	ASTM A193 B7	ASTM A193 B7M	ASTM A193 B8	ASTM A320 L7M
13	NUT	ASTM A194 2H	ASTM A194 2HM	ASTM A194 8	ASTM A194 7M
14	PLUG	ASTM A182 F316L	ASTM A182 F316L	ASTM A182 F316L	ASTM A182 F316L
14a	GASKET	316+GRAPHITE	316+GRAPHITE	316+GRAPHITE	316+GRAPHITE
15	STEM	17-4PH	17-4PH	17-4PH	17-4PH
16	BEARING	ASTM A182 F316L-N2	ASTM A182 F316L-N2	ASTM A182 F316L-N2	ASTM A182 F316L-N2
17	GASKET	316+GRAPHITE	316+GRAPHITE	316+GRAPHITE	316+GRAPHITE
18	SCREW	ASTM A193 B7	ASTM A193 B7M	ASTM A193 B8	ASTM A320 L7M
19	PACKING	GRAPHITE	GRAPHITE	GRAPHITE	GRAPHITE
20	LIFTING LUGS	ASTM A283 GRD	ASTM A283 GRD	ASTM A283 GRD	ASTM A283 GRD
21	GLAND	ASTM A182 F304L	ASTM A182 F304L	ASTM A182 F304L	ASTM A182 F304L
22	GLAND FLANGE	ASTM A216-WCB	ASTM A216-WCB	ASTM A351-CF8	ASTM A352 LCB
23	STUD	ASTM A193 B7	ASTM A193 B7M	ASTM A193 B8	ASTM A320 L7M
24	NUT	ASTM A194 2H	ASTM A194 2HM	ASTM A194 8	ASTM A194 7M
25	TOP FLANGE	ASTM A105N	ASTM A105N	ASTM A105N	ASTM A350 LF2
26	BEARING	ASTM A240 316+PTFE	ASTM A240 316+PTFE	ASTM A240 316+PTFE	ASTM A240 316+PTFE
27	KEY	AISI 1045	AISI 1045	ASTM A276-420	ASTM A276 420
28	STEM PIN	ASTM A276 304	ASTM A276 304	ASTM A276 304	ASTM A276 304
29	SCREW	AISI 1035	AISI 1035	ASTM A276 304	ASTM A276 304
30	GRAPHITE RING	316+GRAPHITE	316+GRAPHITE	316+GRAPHITE	316+GRAPHITE
31	SPRING	INCONEL X-750	INCONEL X-750	INCONEL X-750	INCONEL X-750
32	SEAT GLAND	ASTM A182 F316	ASTM A182 F316	ASTM A182 F316	ASTM A182 F316
33	PACKING	GRAPHITE	GRAPHITE	GRAPHITE	GRAPHITE
34	SEAT	ASTM A182 F316+WC	ASTM A182 F316+WC	ASTM A182 F316+WC	ASTM A182 F316+WC
35	SLEVER	AISI 4140+CrC	AISI 4140+CrC	17-4PH+CrC	AISI 4140+CrC
36	THRUST PLATE	ASTM A182 F316L-N2	ASTM A182 F316L-N2	ASTM A182 F316L-N2	ASTM A182 F316L-N2
37	COVER FLANGE	ASTM A105N	ASTM A105N	ASTM A182 F316	ASTM A350 LF2
38	ARMOR PLATE	ASTM A283 GRD	ASTM A283 GRD	ASTM A283 GRD	ASTM A283 GRD

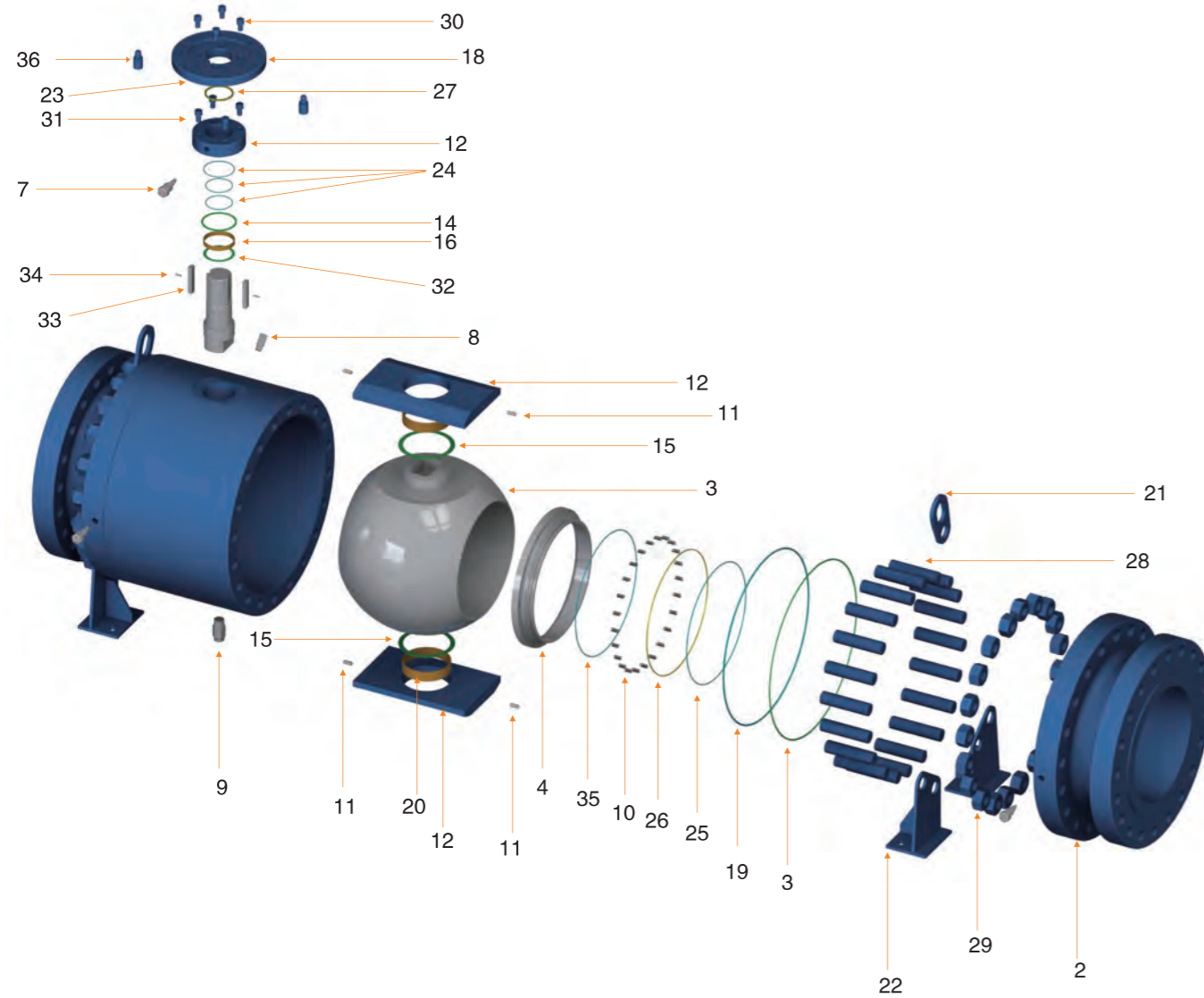

No.Parts Standard Material Sour Condition Stainless Steel Low Temperature Condition

序号	英文名称	标准材料	酸性环境	不锈钢	低温环境
1	BODY	ASTM A105N	ASTM A105N	ASTM A182 F316	ASTM A350 LF2
2	BONNET	ASTM A105N	ASTM A105N	ASTM A182 F316	ASTM A350 LF2
3	BALL	ASTM A105N/ENP	ASTM A105N/ENP	ASTM A182 F316	ASTM A350 LF2/ENP
4	SEAT	ASTM A182 F316+WC	ASTM A182 F316+WC	ASTM A182 F316+WC	ASTM A182 F316+WC
5	STEM	17-4PH	17-4PH	17-4PH	17-4PH
6	TRUNNION ALIGNMENT PIN	ASTM A276 304	ASTM A276 304	ASTM A182 F316L	ASTM A276 304
7	INJECTION	STAINLESS STEEL	STAINLESS STEEL	STAINLESS STEEL	STAINLESS STEEL
8	VENT VALVE	STAINLESS STEEL	STAINLESS STEEL	STAINLESS STEEL	STAINLESS STEEL
9	PLUG	ASTM A182 F316L	ASTM A182 F316L	ASTM A182 F316L	ASTM A182 F316L
10	SPRING	INCONEL X-750	INCONEL X-750	INCONEL X-750	INCONEL X-750
11	PIN	AISI 1035	AISI 1035	ASTM A276 304	AISI 1035
12	TRUNNION SUPPORT	ASTM A588B	ASTM A588B	ASTM A351-CF3	ASTM A351-CF3
13	GASKET	316+GRAPHITE	316+GRAPHITE	316+GRAPHITE	316+GRAPHITE
14	GASKET	316+GRAPHITE	316+GRAPHITE	316+GRAPHITE	316+GRAPHITE
15	THRUST WASHER	METAL BACKED PTFE	METAL BACKED PTFE	METAL BACKED PTFE	METAL BACKED PTFE
16	BEARING	316SS+PTFE+MoS2	316SS+PTFE+MoS2	316SS+PTFE+MoS2	316SS+PTFE+MoS2
17	COVER FLANGE	ASTM A105N	ASTM A105N	ASTM A182 F316	ASTM A350 LF2
18	TOP FLANGE	ASTM A105N	ASTM A105N	ASTM A182 F304	ASTM A350 LF2
19	O-RING	HNBR/VITON	HNBR/VITON	HNBR/VITON	HNBR/VITON
20	Bearing	316SS+PTFE+MoS2	316SS+PTFE+MoS2	316SS+PTFE+MoS2	316SS+PTFE+MoS2
21	LIFTING LUGS	ASTM A283 GRD	ASTM A283 GRD	ASTM A283 GRD	ASTM A283 GRD
22	SUPPORT LEGS	ASTM A283 GRD	ASTM A283 GRD	ASTM A283 GRD	ASTM A283 GRD
23	O-RING	NBR	NBR	NBR	NBR
24	O-RING	HNBR/VITON	HNBR/VITON	HNBR/VITON	HNBR/VITON
25	O-RING	HNBR/VITON	HNBR/VITON	HNBR/VITON	HNBR/VITON
26	O-RING	HNBR/VITON	HNBR/VITON	HNBR/VITON	HNBR/VITON
27	GRAPHITE RING	316+GRAPHITE	316+GRAPHITE	316+GRAPHITE	316+GRAPHITE
28	Body Stud	ASTM A193-B7	ASTM A193-B7M	ASTM A193-B8	ASTM A320-L7M
29	Body Nut	ASTM A194-2H	ASTM A194-2HM	ASTM A194-8	ASTM A194-7M
30	Screw	AISI 1035	AISI 1035	ASTM A276 304	ASTM A276 304
31	Screw	AISI 1035	AISI 1035	ASTM A276 304	ASTM A276 304
32	THRUST WASHER	METAL BACKED PTFE	METAL BACKED PTFE	METAL BACKED PTFE	METAL BACKED PTFE
33	KEY	AISI 1045	AISI 1045	ASTM A276-420	ASTM A276 420
34	PIN	ASTM A276 304	ASTM A276 304	ASTM A276 304	ASTM A276 304
35	GRAPHITE RING	GRAPHITE	GRAPHITE	GRAPHITE	GRAPHITE
36	PIN	ASTM A276 304	ASTM A276 304	ASTM A276 304	ASTM A276 304

Typical application

- 1. Coal chemical industry: coal-to-liquids, coal-to-methanol, coal gasification.
- 2. High sour gas field with abrasive solids.
- 3. Shipbuilding, offshore.
- 4. Oxygen service.
- 5. Photovoltaic industry: polysilicon
- 6. Other working condition in high temperature or with abrasive solids.

Design and production features

Sealing structure of the seat

Bi-directional sealing of the valve. The seat is able to block the media from both sides of the valve, thus eliminating the limit of installing direction.

Preloading of belleville spring or cylinder spring to ensure sealing in low pressure.

Dust proof structure of the spring.

Live loading packing

The Belleville spring is added on gland flange to minimize need of packing retightening.

Choosing of sealing material

For all the gaskets and packing in relate to the sealing parts, the purity of the graphite is strictly controlled to lower the ignition lost rate and ensure the sealing performance in high temperature.

Design and analysis software

All the designs are verified in accordance with 3D Finite Element Analysis.

Neway has rich application experience in design software such as CAD, Solidworks, NX, Ansys, Fesafe, Cfdesign.

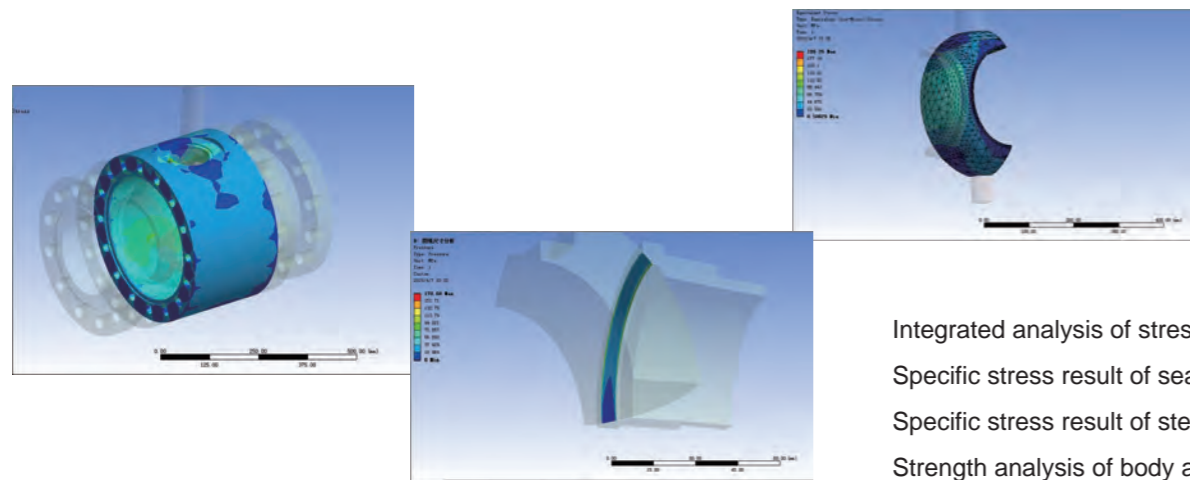

Integrated analysis of stress

Specific stress result of sealing face

Specific stress result of stem

Strength analysis of body and closure

Valve Types		ASME Class			End Connections			Operator	
Symbol	Valve Type	Code	Class(LB)	Pressure	Symbol	End		Lever	
BM	2-pcs Casting floating type	1	150	2.0Mpa	R	Raised face flanged end	G	Gear operator	
BBM	2-pcs forging floating type	3	300	5.0Mpa	J	RTJ flanged end	M	Electric actuator	
BSM	3-pcs forging trunnion mounted type	4	400	6.8Mpa	B	Butt-weld end	P	Pneumatic actuator	
		6	600	10.0Mpa	S	Socket weld end	BS	Bare shaft	
BSK	2-pcs forging trunnion mounted type(O-ring)	8	800	14.0Mpa	N	Screwed end	H	Hydraulic actuator	
		9	900	15.0Mpa	SN	Socket weld/Screwed end	L	Gas over oil actuator	
		15	1500	25.0Mpa			C	Gear operator(Operator forces350N)	
		25	2500	42.0Mpa					

BM/BBM

in	Class 150		Class 300		Class 600		Class 800		Class 900		Class 1500		Class 2500	
	N.m	Ft/Lbs	N.m	Ft/Lbs	N.m	Ft/Lbs	N.m	Ft/Lbs	N.m	Ft/Lbs	N.m	Ft/Lbs	N.m	Ft/Lbs
1/4	4.5	3	6	4	8.9	7	10.8	8	12	9	17.5	13	35.6	26
1/2	10	7	14	10	26	19	31	23	33	24	48	35	92	68
3/4	16	12	29	21	52	38	80	59	88	65	140	103	295	218
1	31	23	59	44	146	108	190	140	210	155	350	258	718	529
1-1/2	76	56	146	108	296	218	385	284	430	317	550	406		
2	145	107	273	201	550	406	750	553	830	612				
2-1/2	280	206	530	391	950	701								
3	370	273	680	501	1320	973								
4	720	531	1420	1047	3400	2507								

BSM

in	Class 150		Class 300		Class 600		Class 900		Class 1500		Class 2500	
	N.m	Ft/Lbs	N.m	Ft/Lbs	N.m	Ft/Lbs	N.m	Ft/Lbs	N.m	Ft/Lbs	N.m	Ft/Lbs
1-1/2	120	88	200	147	320	236	560	413	1360	1003	2400	1770
2	140	103	265	195	490	361	810	597	1450	1069	2800	2605
2-1/2	205	151	390	288	702	518	1200	885	2100	1549	4300	3171
3	290	214	530	391	980	723	1600	1180	2800	2065	5640	4159
4	450	332	1080	796	2113	1558	3100	2286	5600	4130	10000	7375
5	913	673	1830	1350	3383	2495	5800	4277	9800	7227	18600	13717
6	1450	1069	2950	2176	5510	4063	8700	6416	15800	11652	32000	23599
8	2880	2124	6000	4425	11320	8348	18000	13274	30000	22124	50000	36873
10	4500	3319	9300	6858	19000	14012	31600	23304	42300	31195	57000	42035
12	8400	6195	14600	10767	31700	23378	54200	39971				
14	9300	6858	18300	13496	37000	27286	61100	45059				
16	14000	10324	31000	22861	65000	47936	116000	85546				
18	17800	13127	36000	26549	73500	54204	128000	94395				
20	19550	14417	39000	28761	77000	56785	139500	102876				
22	23560	17375	46200	34071	86200	63569						
24	26250	19358	51704	38130	93400	68879						

BSK

in	Class 150		Class 300		Class 600		Class 900		Class 1500		Class 2500	
	N.m	Ft/Lbs	N.m	Ft/Lbs	N.m	Ft/Lbs	N.m	Ft/Lbs	N.m	Ft/Lbs	N.m	Ft/Lbs
1-1/2	81	60	134	99	215	159	376	277	912	637	1608	1186
2	94	69	178	131	329	243	543	400	972	717	1876	1383
2-1/2	138	102	262	193	471	347	804	593	1407	1038	2881	2125
3	195	144	356	263	657	485	1072	791	1876	1383	3779	2787
4	302	223	724	534	1416	1044	2077	1532	3752	2767	6700	4941
5	612	451	1227	905	2267	1672	3886	2866	6566	4842	12462	9190
6	972	717	1977	1458	3692	2723	5829	4299	10586	7807	21440	15811
8	1930	1423	4020	2965	7585	5594	12060	8894	20100	14823	33500	24705
10	3015	2223	6231	4595	12730	9388	21172	15614	28340	20900	38190	28164
12	5628	4150	9782	7214	21239	15663	36314	26780				
14	6321	4662	12261	9042	24790	18282	40937	30190				
16	9380	6917	20770	15317	43550	32117	77720	57316				
18	11926	8795	24120	17788	49245	36316	85760	63240				
20	13099	9660	26130	19270	51590	38046	93465	68927				
22	15785	11641	30954	22827	57754	42591						
24	17587	12970	34642	25547	62578	46149						

NOTE: 1.Torque is calculated based on 100°C.
 2.Torque may be changed according to different fluid and trim material.
 3.Torque shown in this table is to be used as a guide for actuator selection . A safety factor of 1.3-1.5 is recommended for actuator sizing.

NEWAY Head Office

Total area: 2,295sqm
Office area: 6,885sqm

Founded in 2014



Neway Manufacturing Base

Main products: Ball Valve, Gate Valve,
Globe Valve, Check Valve,
Forged Steel Valve, Butterfly Valve

Building area: 230,000 sqm
Work shop: 140,061 sqm

Expanded in 2013



NEWAY Foundry (Suzhou)

Main products: Sand Casting
Building area: 112,500 sqm
Work shop: 98000 sqm

Founded in 2008



NEWAY Foundry (Dafeng)

Main products: Lost wax investment casting
Building area: 46,000 sqm
Work shop: 12,000 sqm

Founded in 2004



NEWAY Foundry (Dafeng)

Main products: Lost wax investment casting
Building area: 40,000 sqm
Work shop: 20,000 sqm

Founded in 2008



Seller will replace without charge or refund the purchase price of products provided by Seller which prove to be defective in material or workmanship, provided in each case that the product is properly installed and is used in the service for which Seller recommends it and that written claim, specifying the alleged defect, is presented to the Seller within 18 months from the date of shipment or 12 months after installation, whichever occurs first. Seller shall in no event bear any labor, equipment, engineering or other costs incurred in connection with repair or replacement. The warranty stated in this paragraph is in lieu of all other warranties, either expressed or implied. With respect to warranties, this paragraph states Buyer's exclusive remedy and seller's exclusive liability.