

2-4. Tank Bottom Valves: Type-T

1 Features of Products

- Excellent agitation efficiency with direct welding on tank bottom
- No gland packing, stem, seat, gasket, etc., at contacting zone with liquid, and the open/close operation only by diaphragm will facilitate smooth discharge of tank contents with almost no residues. Extremely low contamination attributable to valve parts, and the washing and sterilization are easy and secure.
- A wide range of nominal size from DN15 to 100 (4S) facilitates the application from small container of 10 L to a medium size tank of 10,000 L.



Installation

2 Valve Specifications

Standard Specifications

Manufactured Main Bodies

Main Body Material	SUS316L
Nominal Size (DN)	15–100
Operation Type	Manual operation and pneumatic operation are applicable.
Option	Flange connection, Branch pipe, etc.

Other Specifications

- Main body surface finish classifications, diaphragm specifications, etc., are in accordance with the standard specifications. (Ref. page 10–11)
- Interchangeability with the units for standard main bodies allows the common use with the actuators for manually operated valves and pneumatically operated ON-OFF valves.

3 Major Dimensions (reference)

A typical example is shown with the combination of various actuators. Please contact us for combinations other than the table below.

Manually Operated Valve: B414 (T) N

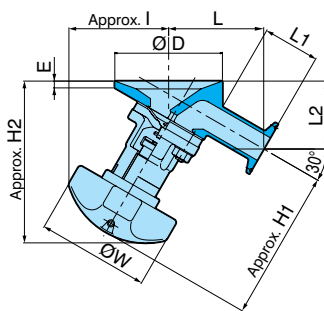

Pneumatically Operated ON-OFF Valve: BPO1414 (T) NB

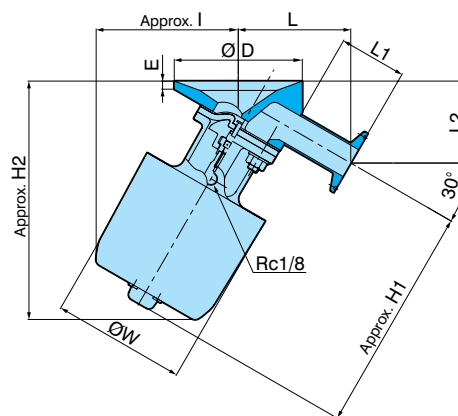

Unit: mm

Nominal Size DN (S)	L	L1	L2	D	E	Manually Operated Valve (B400N)					Pneumatically Operated ON-OFF Valve (BPO)					
						Approx. H1	Approx. H2	Approx. I	W	Mass (Approx. kg)	Actuator	Approx. H1	Approx. H2	Approx. I	W	Mass (Approx. kg)
15	73	50	59	69	14	96	112	63	70	1.5	07	148	156	84	87	1.5
20	76	50	60	80	12	100	113	67	70	2.0	09	166	173	103	102	2.3
25 (1S)	84	50	60	95	6	106	119	70	80	2.5	09	180	184	105	102	2.8
40 (1.5S)	103	50	68	139	6	137	149	86	70	4.5	12	203	214	126	138	5.6
50 (2S)	129	63	83	177	6	154	169	99	80	7.0	16	247	261	154	183	10.0
65 (2.5S)	140	63	90	204	12	182	212	107	100	11.0	16B*	299	300	166	194	16.0
											20B*	350	347	199	236	22.0
80 (3S)	152	63	105	254	12	200	243	131	70	17.0	20B*	369	370	209	236	27.2
											25B*	407	404	248	286	40.6
100 (4S)	179	63	153	301	12	263	325	193	80	22.0	20B*	387	407	242	236	36.4
											25B*	425	438	274	286	49.8

* BPO1400N