

G12 VALVE ASSEMBLY

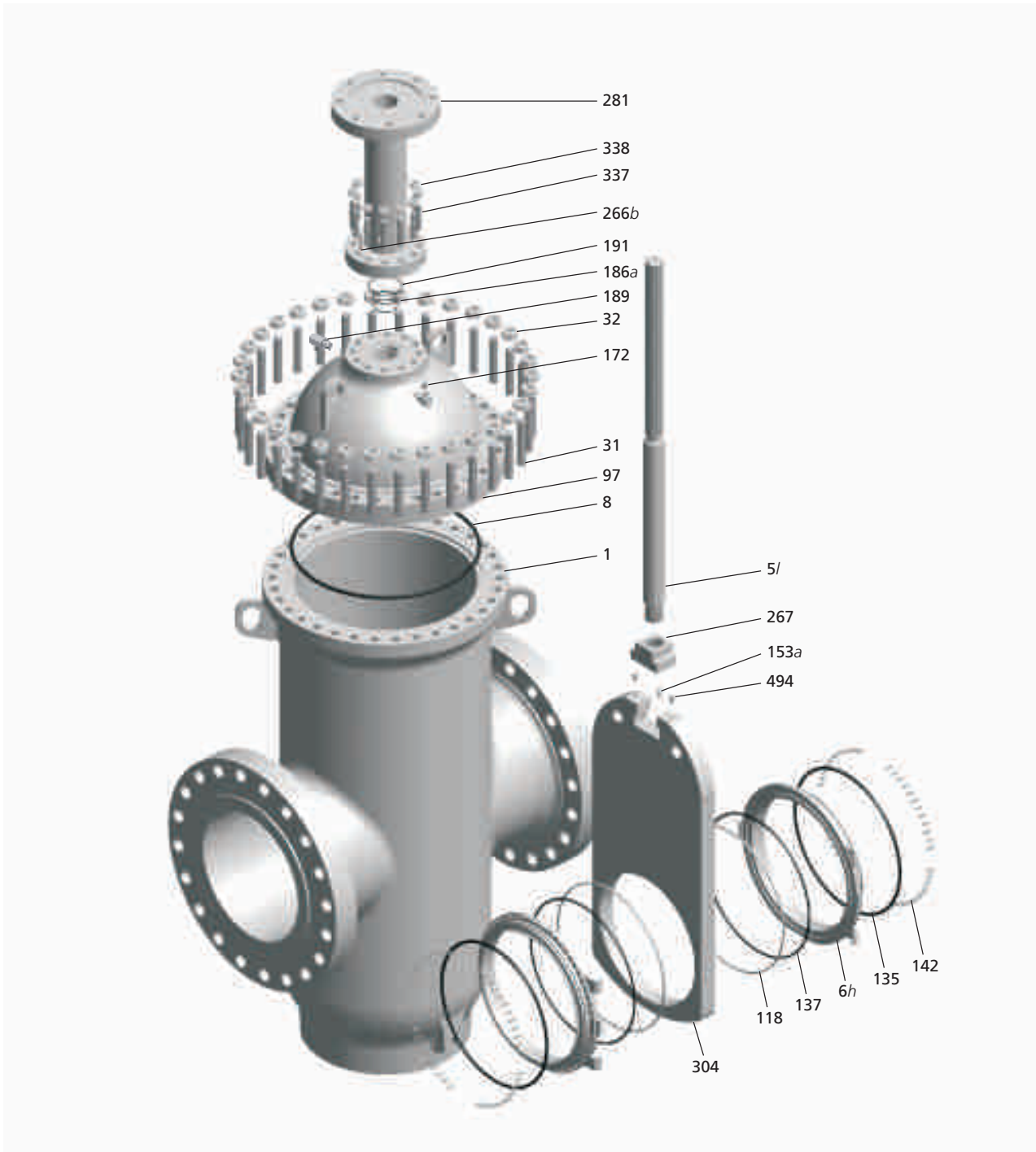

Item	Description	118	Seat Ring	191	Lower Extension O-Ring
1	Body	135	Seat Gasket O-Ring	266 <i>b</i>	Adapter Plate Stop Spring Pin
5/	Stem	137	Seal O-Ring	267	Stem Head
6 <i>h</i>	Seat	142	Cylindrical Spring	281	Yoke Unit
8	Body O-Ring	153 <i>a</i>	Driver Safety Pin	304	Gate
31	Body Stud	172	Vent Plug	337	Yoke Stud
32	Body Stud Nut	186 <i>a</i>	Stem Seal Gasket	338	Yoke Stud Nut
97	Bonnet	189	Stem Grease Fitting	494	Adjusting Screw

G12 ASME CLASS 600

Larger on request.
Reduced-bore valves
also available.

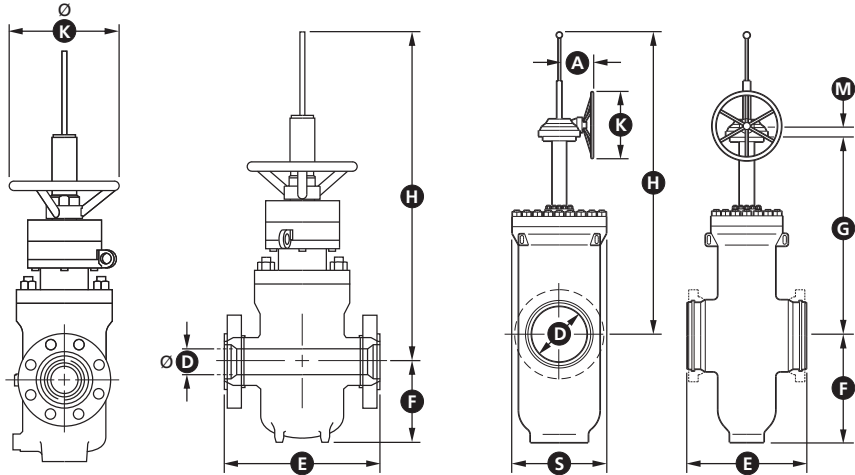

DIMENSIONS & WEIGHTS

FROM 2 in. (50 mm) TO 6 in. (150 mm)

FROM 8 in. (200 mm) AND ABOVE

SIZE in. (mm)	D	E			F	G	S	H	A	K	M	WEIGHT lb. (kg)	
		WE	RF	RTJ								WE	RF/RTJ
2 (50)	2 (51)	11 1/2 (292)	11 1/2 (292)	11 5/8 (295)	5 3/8 (137)	-	-	21 5/8 (550)	-	9 7/8 (250)	-	-	137 (62)
3 (80)	3 (76)	14 (356)	14 (356)	14 1/8 (359)	7 1/4 (184)	-	-	26 (660)	-	11 3/4 (300)	-	-	220 (100)
4 (100)	4 (102)	17 (432)	17 (432)	17 1/8 (435)	11 5/8 (295)	-	-	30 (760)	-	13 3/4 (350)	-	-	375 (170)
6 (150)	6 (152)	22 (559)	22 (559)	22 1/8 (562)	14 1/8 (359)	24 3/4 (630)	13 (330)	44 (1118)	7 7/8 (200)	11 3/4 (300)	2 1/4 (56)	566 (257)	679 (308)
8 (200)	8 (203)	26 (660)	26 (660)	26 1/8 (664)	16 5/8 (421)	31 3/4 (808)	15 3/8 (392)	55 3/8 (1406)	7 7/8 (200)	11 3/4 (300)	2 1/4 (56)	903 (410)	1067 (484)
10 (250)	10 (254)	31 (787)	31 (787)	31 1/8 (791)	20 3/8 (517)	38 1/4 (970)	17 7/8 (455)	65 7/8 (1672)	8 5/8 (220)	19 5/8 (500)	2 7/8 (74)	1321 (599)	1587 (720)
12 (300)	12 (305)	33 (838)	33 (838)	33 1/8 (841)	23 1/4 (590)	43 3/8 (1103)	20 1/8 (511)	76 (1929)	8 5/8 (220)	19 5/8 (500)	2 7/8 (74)	2196 (996)	2557 (1160)
14 (350)	13 1/4 (337)	35 (889)	35 (889)	35 1/8 (892)	29 1/8 (740)	47 3/4 (1214)	22 7/8 (580)	82 5/8 (2100)	9 1/2 (241)	19 5/8 (500)	3 5/8 (92)	3163 (1435)	3571 (1620)
16 (400)	15 1/4 (387)	39 (991)	39 (991)	39 1/8 (994)	31 1/2 (800)	53 (1345)	26 1/2 (674)	92 1/2 (2349)	12 5/8 (320)	19 5/8 (500)	4 (102)	3512 (1593)	3968 (1800)
18 (450)	17 1/4 (438)	43 (1092)	43 (1092)	43 1/8 (1095)	33 1/2 (850)	58 7/8 (1496)	29 3/8 (746)	102 7/8 (2613)	12 5/8 (320)	19 5/8 (500)	4 (102)	4806 (2180)	5379 (2440)
20 (500)	19 1/4 (489)	47 (1194)	47 (1194)	47 1/4 (1200)	37 3/8 (950)	65 3/4 (1671)	32 3/4 (832)	114 5/8 (2911)	12 5/8 (320)	19 5/8 (500)	4 (102)	5822 (2641)	6581 (2985)
22 (550)	21 1/4 (540)	51 (1295)	51 (1295)	51 3/8 (1305)	39 5/8 (1006)	72 (1830)	34 7/8 (885)	126 1/2 (3213)	16 1/8 (410)	31 1/2 (800)	4 1/2 (115)	7209 (3270)	8400 (3810)
24 (600)	23 1/4 (591)	55 (1397)	55 (1397)	55 3/8 (1407)	45 1/4 (1150)	79 1/2 (2020)	39 (990)	138 1/4 (3510)	16 1/8 (410)	31 1/2 (800)	4 1/2 (115)	9348 (4240)	10450 (4740)
26 (650)	25 (635)	57 (1448)	57 (1448)	57 1/2 (1461)	48 3/8 (1230)	86 1/4 (2190)	41 3/8 (1050)	146 1/8 (3710)	17 7/8 (453)	31 1/2 (800)	5 7/8 (150)	11001 (4990)	12346 (5600)
28 (700)	27 (686)	61 (1549)	61 (1549)	61 1/2 (1562)	51 5/8 (1310)	92 1/2 (2350)	44 1/2 (1130)	153 1/8 (3890)	17 7/8 (453)	31 1/2 (800)	5 7/8 (150)	13228 (6000)	14991 (6800)
30 (750)	29 (737)	65 (1651)	65 (1651)	65 1/2 (1664)	57 1/8 (1450)	97 7/8 (2487)	47 1/4 (1200)	169 1/4 (4298)	19 5/8 (500)	31 1/2 (800)	6 1/8 (155)	15851 (7190)	17549 (7960)
32 (800)	30 3/4 (781)	70 (1778)	70 (1778)	70 5/8 (1794)	59 (1500)	104 3/8 (2650)	50 3/8 (1280)	177 1/2 (4510)	19 5/8 (500)	31 1/2 (800)	6 1/8 (155)	18849 (8550)	20745 (9410)
34 (850)	32 3/4 (832)	76 (1930)	76 (1930)	76 5/8 (1946)	62 1/4 (1580)	110 1/4 (2800)	53 1/8 (1350)	189 (4800)	19 5/8 (500)	31 1/2 (800)	6 1/8 (155)	22707 (10300)	24692 (11200)
36 (900)	34 1/2 (876)	82 (2083)	82 (2083)	82 5/8 (2099)	65 1/2 (1663)	114 5/8 (2910)	55 1/8 (1401)	197 7/8 (5026)	26 (660)	31 1/2 (800)	8 1/2 (215)	26014 (11800)	28439 (12900)
38 (950)	36 1/2 (927)	* (*)	* (*)	* (*)	68 7/8 (1750)	122 (3100)	58 1/4 (1480)	207 7/8 (5280)	26 (660)	31 1/2 (800)	8 1/2 (215)	30864 (14000)	33069 (15000)
40 (1000)	38 1/2 (978)	* (*)	* (*)	* (*)	72 (1830)	128 3/8 (3260)	61 (1550)	216 1/2 (5500)	26 (660)	31 1/2 (800)	8 1/2 (215)	34612 (15700)	36596 (16600)
42 (1050)	40 1/4 (1022)	* (*)	* (*)	* (*)	75 5/8 (1920)	133 7/8 (3400)	63 3/4 (1620)	224 3/4 (5710)	- (-)	- (-)	- (-)	39683 (18000)	42328 (19200)
48 (1200)	46 (1168)	* (*)	* (*)	* (*)	85 3/8 (2170)	152 3/8 (3870)	72 1/2 (1840)	255 1/2 (6490)	- (-)	- (-)	- (-)	54674 (24800)	57981 (26300)
54 (1350)	51 3/4 (1314)	* (*)	* (*)	* (*)	96 1/2 (2450)	171 1/4 (4350)	80 3/4 (2050)	285 7/8 (7260)	- (-)	- (-)	- (-)	68343 (31000)	77161 (35000)
56 (1400)	53 3/4 (1365)	* (*)	* (*)	* (*)	99 1/4 (2520)	177 1/8 (4500)	83 1/2 (2120)	295 5/8 (7510)	- (-)	- (-)	- (-)	72752 (33000)	83775 (38000)
60 (1500)	57 1/2 (1461)	* (*)	* (*)	* (*)	106 1/4 (2700)	189 (4800)	89 (2260)	315 3/8 (8010)	- (-)	- (-)	- (-)	81570 (37000)	99207 (45000)

* Upon Request

Flanges up to 24 in. (600 mm) (except 22 in. (550 mm)) in accordance with ASME B16.5;
22 in. (550 mm) and above 24 in. (600 mm) in accordance with MSS-SP-44 if applicable.

Shaded Dimensions in accordance to ISO 14313
Butt Welding Ends according to ASME B16.25