

G12 VALVE ASSEMBLY

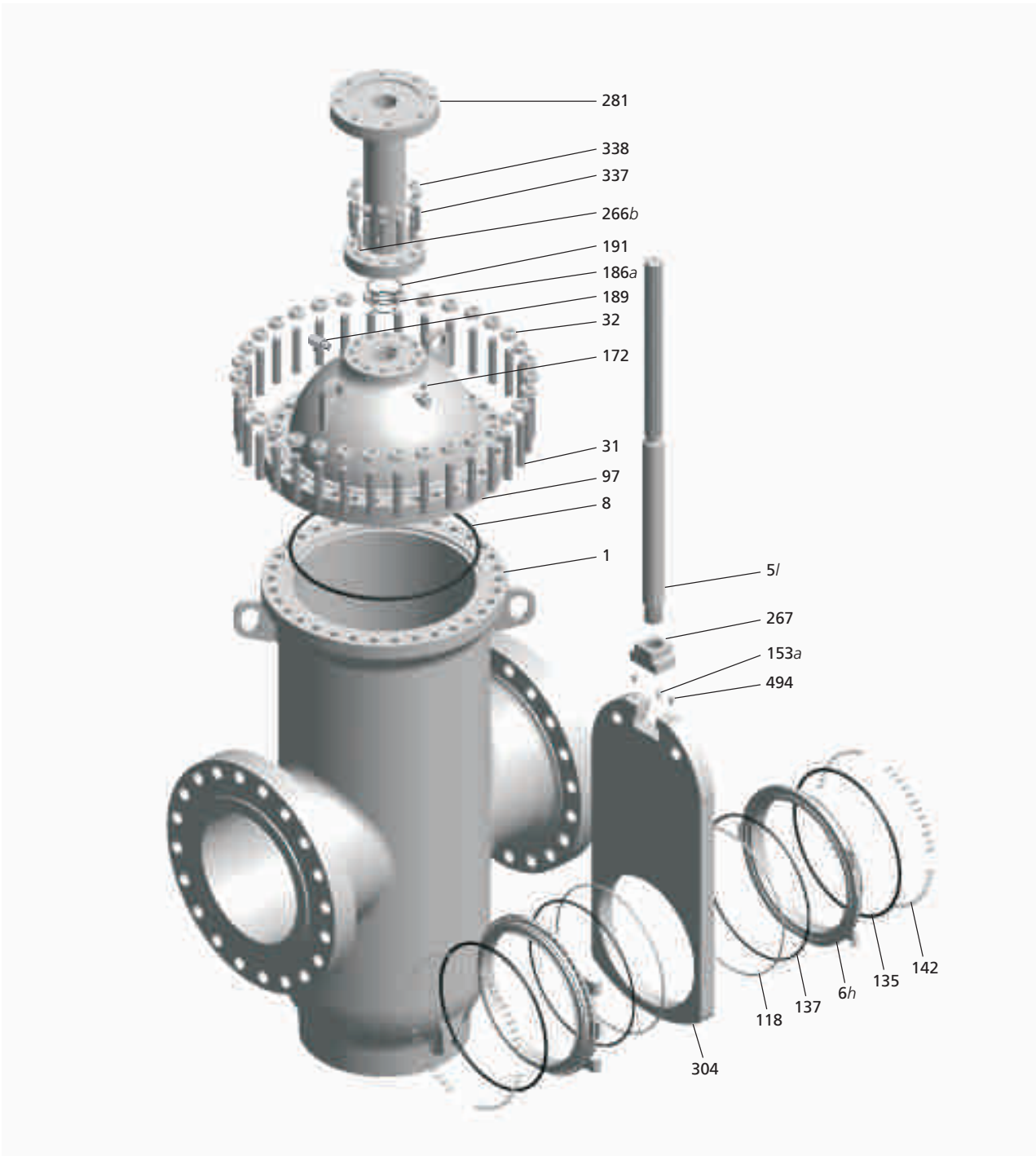

Item	Description	118	Seat Ring	191	Lower Extension O-Ring
1	Body	135	Seat Gasket O-Ring	266 <i>b</i>	Adapter Plate Stop Spring Pin
5/	Stem	137	Seal O-Ring	267	Stem Head
6 <i>h</i>	Seat	142	Cylindrical Spring	281	Yoke Unit
8	Body O-Ring	153 <i>a</i>	Driver Safety Pin	304	Gate
31	Body Stud	172	Vent Plug	337	Yoke Stud
32	Body Stud Nut	186 <i>a</i>	Stem Seal Gasket	338	Yoke Stud Nut
97	Bonnet	189	Stem Grease Fitting	494	Adjusting Screw

G12 ASME CLASS 300

Larger on request.
Reduced-bore valves
also available.

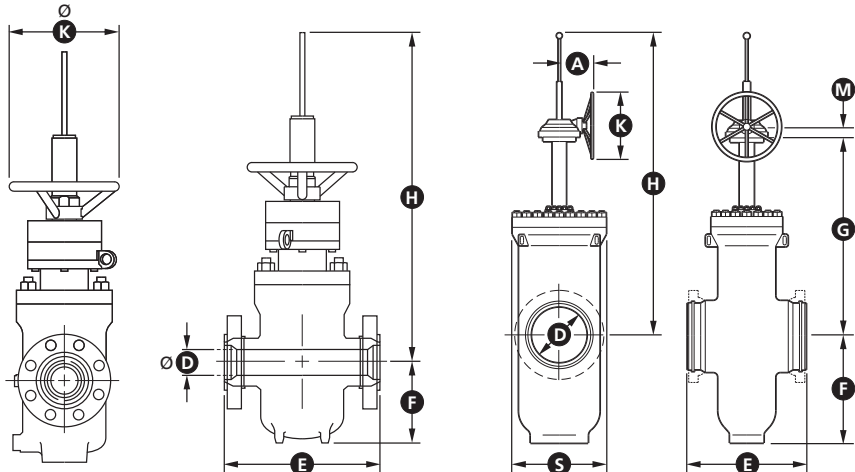

DIMENSIONS & WEIGHTS

FROM 2 in. (50 mm) TO 8 in. (200 mm)

FROM 10 in. (250 mm) AND ABOVE

SIZE in. (mm)	D	E			F	G	S	H	A	K	M	WEIGHT lb. (kg)	
		WE	RF	RTJ								WE	RF/RTJ
2 (50)	2 (51)	8 1/2 (216)	8 1/2 (216)	9 1/8 (232)	5 3/8 (137)	-	-	20 1/2 (520)	-	-	-	-	104 (47)
3 (80)	3 (76)	11 (283)	11 (283)	11 3/4 (298)	7 (180)	-	-	23 5/8 (600)	-	9 7/8 (250)	-	-	137 (62)
4 (100)	4 (102)	12 (305)	12 (305)	12 5/8 (321)	8 5/8 (220)	-	-	24 3/8 (620)	-	11 3/4 (300)	-	-	198 (90)
6 (150)	6 (152)	15 7/8 (403)	15 7/8 (403)	16 1/2 (419)	15 3/8 (392)	26 1/4 (666)	12 3/8 (314)	43 1/8 (1096)	7 7/8 (200)	11 3/4 (300)	2 1/4 (56)	351 (159)	397 (180)
8 (200)	8 (203)	16 1/2 (419)	16 1/2 (419)	17 1/8 (435)	16 7/8 (430)	31 3/4 (806)	15 1/8 (385)	54 (1372)	7 7/8 (200)	11 3/4 (300)	2 1/4 (56)	586 (266)	661 (300)
10 (250)	10 (254)	18 (457)	18 (457)	18 5/8 (473)	22 (559)	37 (941)	17 3/4 (451)	64 7/8 (1646)	7 7/8 (200)	11 3/4 (300)	2 1/4 (56)	918 (416)	1036 (470)
12 (300)	12 (305)	19 3/4 (502)	19 3/4 (502)	20 3/8 (518)	25 1/8 (637)	42 1/2 (1078)	20 1/2 (519)	73 3/4 (1872)	7 7/8 (200)	11 3/4 (300)	2 1/4 (56)	1269 (576)	1433 (650)
14 (350)	13 1/4 (337)	30 (762)	30 (762)	30 5/8 (778)	28 1/2 (725)	48 1/4 (1225)	22 3/8 (568)	83 (2107)	8 5/8 (220)	19 5/8 (500)	2 7/8 (74)	1962 (890)	2216 (1005)
16 (400)	15 1/4 (387)	33 (838)	33 (838)	33 5/8 (854)	30 7/8 (784)	54 (1372)	25 7/8 (657)	92 5/8 (2352)	8 5/8 (220)	19 5/8 (500)	2 7/8 (74)	2778 (1260)	3108 (1410)
18 (450)	17 1/4 (438)	36 (914)	36 (914)	36 5/8 (930)	33 5/8 (853)	59 3/4 (1519)	28 1/8 (715)	102 5/8 (2607)	9 1/2 (241)	19 5/8 (500)	3 5/8 (92)	3571 (1620)	3990 (1810)
20 (500)	19 1/4 (489)	39 (991)	39 (991)	39 3/4 (1010)	33 7/8 (860)	64 7/8 (1646)	32 1/8 (815)	111 7/8 (2842)	9 1/2 (241)	19 5/8 (500)	3 5/8 (92)	4652 (2110)	5137 (2330)
22 (550)	21 1/4 (540)	43 (1092)	43 (1092)	43 7/8 (1114)	40 1/8 (1019)	71 3/8 (1813)	33 5/8 (853)	121 7/8 (3097)	9 1/2 (241)	19 5/8 (500)	3 5/8 (92)	5997 (2720)	6592 (2990)
24 (600)	23 1/4 (591)	45 (1143)	45 (1143)	45 7/8 (1165)	43 1/4 (1098)	76 (1931)	36 1/4 (921)	131 1/8 (3332)	12 5/8 (320)	19 5/8 (500)	4 (102)	7518 (3410)	8267 (3750)
26 (650)	25 (635)	49 (1245)	49 (1245)	50 (1270)	46 1/4 (1176)	81 3/4 (2078)	38 5/8 (980)	140 7/8 (3577)	12 5/8 (320)	19 5/8 (500)	4 (102)	8752 (3970)	9656 (4380)
28 (700)	27 (686)	53 (1346)	53 (1346)	54 (1372)	48 5/8 (1235)	87 1/4 (2215)	42 7/8 (1088)	150 7/8 (3832)	16 1/8 (410)	31 1/2 (800)	4 1/2 (115)	10394 (4715)	11464 (5200)
30 (750)	29 (737)	55 (1397)	55 (1397)	56 (1422)	52 1/8 (1323)	92 5/8 (2352)	44 3/8 (1127)	160 1/8 (4067)	16 1/8 (410)	31 1/2 (800)	4 1/2 (115)	12213 (5540)	13470 (6110)
32 (800)	30 3/4 (781)	60 (1524)	60 (1524)	61 1/8 (1553)	55 (1397)	98 3/8 (2499)	45 3/4 (1161)	170 1/8 (4322)	16 1/8 (410)	31 1/2 (800)	4 1/2 (115)	14749 (6690)	16248 (7370)
34 (850)	32 3/4 (832)	64 (1626)	64 (1626)	65 1/8 (1654)	58 1/4 (1480)	104 1/8 (2646)	49 3/8 (1254)	181 3/8 (4606)	16 1/8 (410)	31 1/2 (800)	4 1/2 (115)	17703 (8030)	19356 (8780)
36 (900)	34 1/2 (876)	68 (1727)	68 (1727)	69 1/8 (1756)	61 3/4 (1568)	110 (2793)	52 1/8 (1323)	189 1/2 (4812)	17 7/8 (453)	31 1/2 (800)	5 7/8 (150)	20348 (9230)	22222 (10080)
38 (950)	36 1/2 (927)	* (*)	* (*)	* (*)	64 7/8 (1646)	115 3/4 (2940)	54 3/4 (1392)	200 1/4 (5086)	17 7/8 (453)	31 1/2 (800)	5 7/8 (150)	23083 (10470)	24251 (11000)
40 (1000)	38 1/2 (978)	* (*)	* (*)	* (*)	66 3/8 (1686)	121 1/8 (3077)	56 (1421)	208 (5282)	17 7/8 (453)	31 1/2 (800)	5 7/8 (150)	24846 (11270)	26102 (11840)
42 (1050)	40 1/4 (1022)	* (*)	* (*)	* (*)	70 5/8 (1793)	126 1/2 (3214)	60 1/4 (1529)	218 3/8 (5547)	17 7/8 (453)	31 1/2 (800)	5 7/8 (150)	30710 (13930)	32099 (14560)
48 (1200)	46 (1168)	* (*)	* (*)	* (*)	80 1/4 (2038)	143 1/2 (3646)	67 1/8 (1705)	248 1/8 (6301)	26 (660)	31 1/2 (800)	8 1/2 (215)	41160 (18670)	42902 (19460)
54 (1350)	51 3/4 (1314)	* (*)	* (*)	* (*)	89 1/8 (2264)	160 7/8 (4087)	76 (1931)	278 1/8 (7066)	26 (660)	31 1/2 (800)	8 1/2 (215)	50762 (23026)	52910 (24000)
56 (1400)	53 3/4 (1365)	* (*)	* (*)	* (*)	92 5/8 (2352)	165 7/8 (4214)	78 3/4 (1999)	285 1/8 (7242)	26 (660)	31 1/2 (800)	8 1/2 (215)	54993 (24945)	57320 (26000)
60 (1500)	57 1/2 (1461)	* (*)	* (*)	* (*)	98 3/8 (2499)	177 1/2 (4508)	84 1/8 (2136)	305 1/4 (7752)	-	-	-	63453 (28782)	66138 (30000)

* Upon Request

Flanges up to 24 in. (600 mm) (except 22 in. (550 mm)) in accordance with ASME B16.5;
22 in. (550 mm) and above 24 in. (600 mm) in accordance with MSS-SP-44 if applicable.

Shaded Dimensions in accordance to ISO 14313
Butt Welding Ends according to ASME B16.25