

G12 VALVE ASSEMBLY

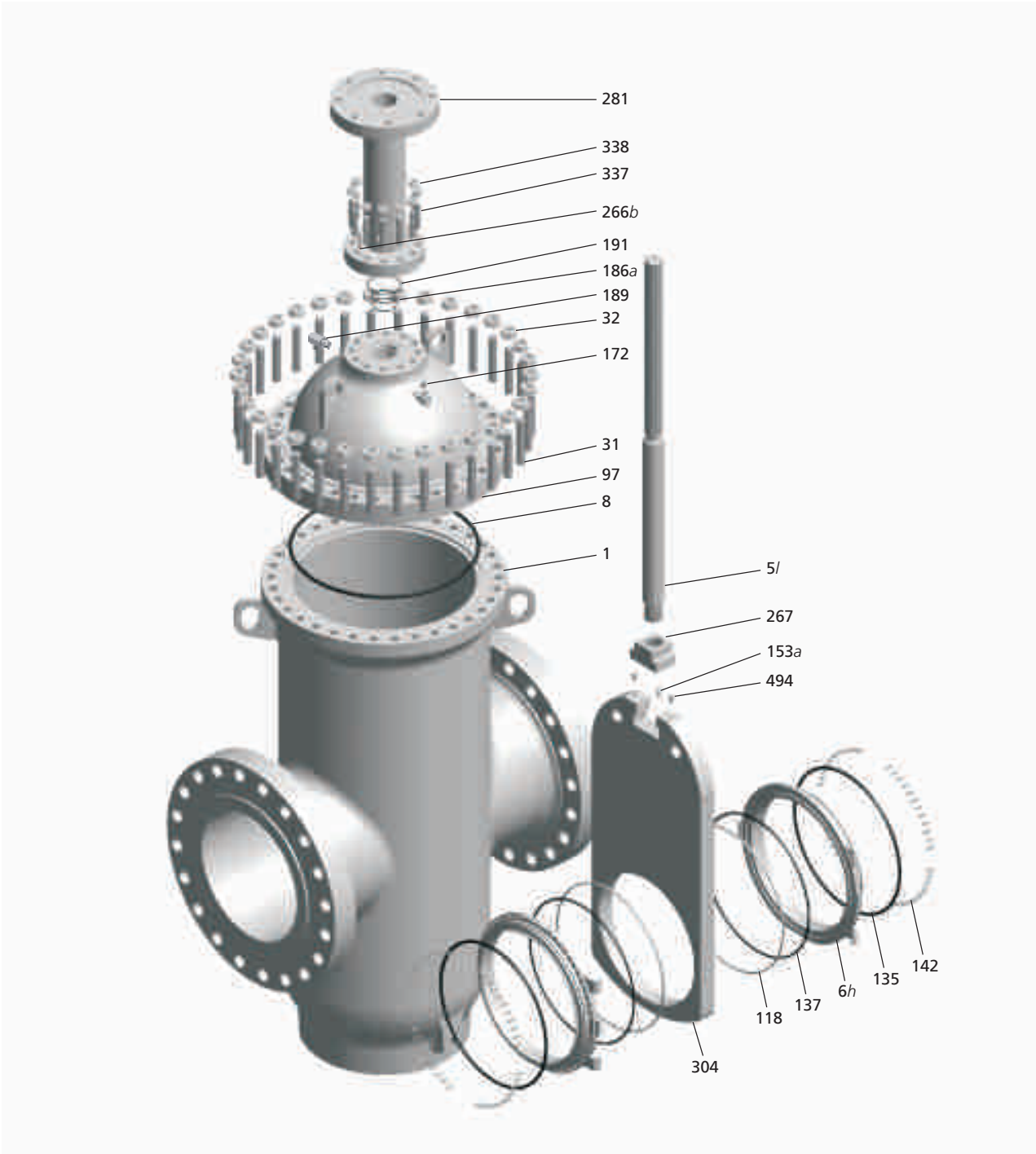

Item	Description	Item	Description	Item	Description
1	Body	118	Seat Ring	191	Lower Extension O-Ring
5/	Stem	135	Seat Gasket O-Ring	266 b	Adapter Plate Stop Spring Pin
6h	Seat	137	Seal O-Ring	267	Stem Head
8	Body O-Ring	142	Cylindrical Spring	281	Yoke Unit
31	Body Stud	153 a	Driver Safety Pin	304	Gate
32	Body Stud Nut	172	Vent Plug	337	Yoke Stud
97	Bonnet	186 a	Stem Seal Gasket	338	Yoke Stud Nut
		189	Stem Grease Fitting	494	Adjusting Screw

G12 ASME CLASS 2500

Larger on request.
Reduced-bore valves
also available.

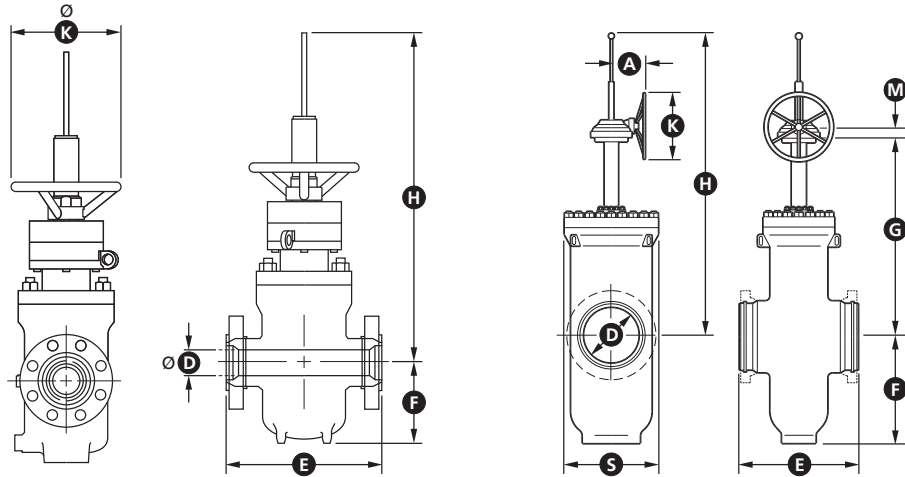

FROM 2 in. (50 mm) TO 3 in. (80 mm)

FROM 4 in. (100 mm) AND ABOVE

DIMENSIONS & WEIGHTS

SIZE in. (mm)	D	E			F	G	S	H	A	K	M	WEIGHT lb. (kg)	
		WE	RF	RTJ								WE	RF/RTJ
2 (50)	1 3/4 (44.5)	17 3/4 (451)	17 3/4 (451)	17 7/8 (454)	6 1/4 (160)	-	-	27 1/2 (700)	-	-	-	-	198 (90)
3 (80)	2 1/2 (64)	22 3/4 (578)	22 3/4 (578)	23 (584)	7 1/4 (184)	-	-	32 1/4 (820)	-	-	-	-	441 (200)
4 (100)	3 1/2 (89)	26 1/2 (673)	26 1/2 (673)	26 7/8 (683)	11 5/8 (295)	-	-	37 3/8 (950)	-	-	-	-	694 (315)
6 (150)	5 1/8 (131)	36 (914)	36 (914)	36 1/2 (927)	*	*	*	*	*	*	*	*	*
8 (200)	7 (179)	40 1/4 (1022)	40 1/4 (1022)	40 7/8 (1038)	*	*	*	*	*	*	*	*	*
10 (250)	8 3/4 (223)	50 (1270)	50 (1270)	50 7/8 (1292)	*	*	*	*	*	*	*	*	*
12 (300)	10 3/8 (265)	56 (1422)	56 (1422)	56 7/8 (1445)	*	*	*	*	*	*	*	*	*
14 (350)	11 1/2 (292)	*	*	*	*	*	*	*	*	*	*	*	*
16 (400)	13 1/8 (333)	*	*	*	*	*	*	*	*	*	*	*	*
18 (450)	14 3/4 (374)	*	*	*	*	*	*	*	*	*	*	*	*
20 (500)	16 1/2 (419)	*	*	*	*	*	*	*	*	*	*	*	*
22 (550)	*	*	*	*	*	*	*	*	*	*	*	*	*
24 (600)	*	*	*	*	*	*	*	*	*	*	*	*	*

* Upon Request
Flanges up to 24 in. (600 mm) (except 22 in. (550 mm)) in accordance with ASME B16.5;
22 in. (550 mm) and above 24 in. (600 mm) in accordance with MSS-SP-44 if applicable.

Shaded Dimensions in accordance to ISO 14313
Butt Welding Ends according to ASME B16.25