

G12 VALVE ASSEMBLY

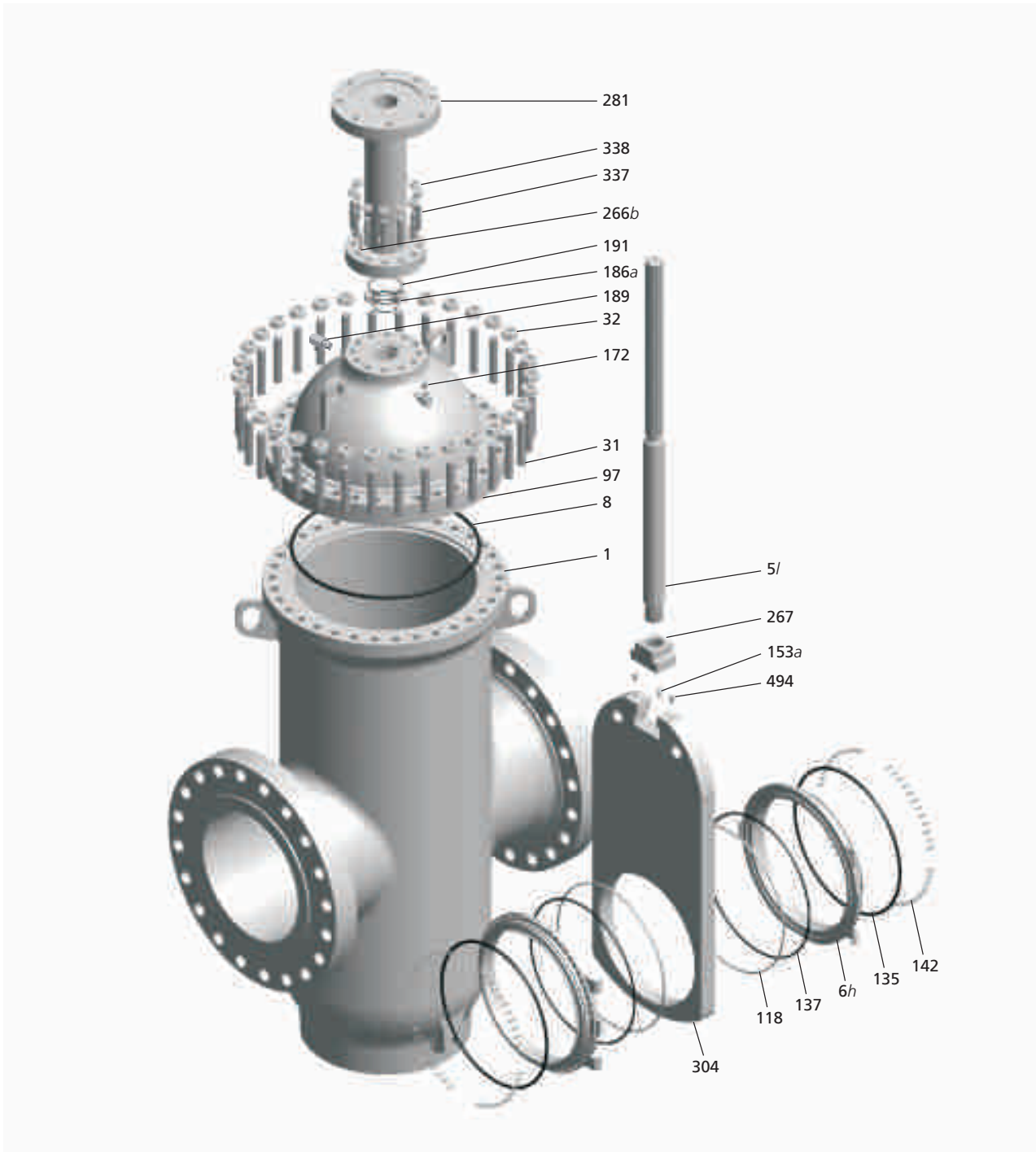

Item	Description	118	Seat Ring	191	Lower Extension O-Ring
1	Body	135	Seat Gasket O-Ring	266 <i>b</i>	Adapter Plate Stop Spring Pin
5/	Stem	137	Seal O-Ring	267	Stem Head
6 <i>h</i>	Seat	142	Cylindrical Spring	281	Yoke Unit
8	Body O-Ring	153 <i>a</i>	Driver Safety Pin	304	Gate
31	Body Stud	172	Vent Plug	337	Yoke Stud
32	Body Stud Nut	186 <i>a</i>	Stem Seal Gasket	338	Yoke Stud Nut
97	Bonnet	189	Stem Grease Fitting	494	Adjusting Screw

**G12
ASME CLASS 150**

Larger on request.
Reduced-bore valves
also available.

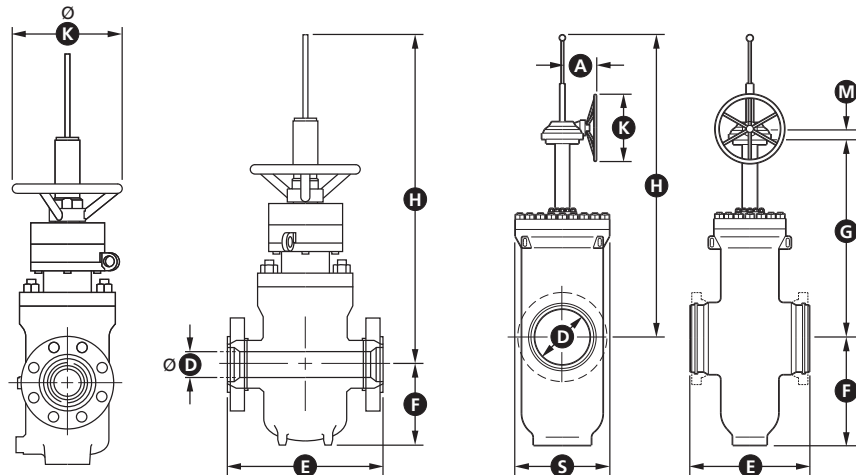

DIMENSIONS & WEIGHTS

FROM 2 in. (50 mm) TO 14 in. (350 mm)

FROM 16 in. (400 mm) AND ABOVE

SIZE in. (mm)	D	E			F	G	S	H	A	K	M	WEIGHT lb. (kg)	
		WE	RF	RTJ								WE	RF/RTJ
2 (50)	2 (51)	8 1/2 (216)	7 (178)	7 1/2 (191)	5 3/8 (137)	-	-	20 1/2 (520)	-	-	-	-	75 (34)
3 (80)	3 (76)	11 (283)	8 (203)	8 1/2 (216)	7 (180)	-	-	23 5/8 (600)	-	-	-	-	115 (52)
4 (100)	4 (102)	12 (305)	9 (229)	9 1/2 (241)	8 5/8 (220)	-	-	24 3/8 (620)	-	-	-	-	179 (81)
6 (150)	6 (152)	15 7/8 (403)	10 1/2 (267)	11 (279)	13 1/4 (338)	24 5/8 (626)	13 3/4 (348)	43 1/8 (1094)	7 7/8 (200)	11 3/4 (300)	2 1/4 (56)	349 (158)	397 (180)
8 (200)	8 (203)	16 1/2 (419)	11 1/2 (292)	12 (305)	16 1/4 (412)	31 1/4 (794)	15 3/8 (390)	55 1/2 (1409)	7 7/8 (200)	11 3/4 (300)	2 1/4 (56)	582 (264)	661 (300)
10 (250)	10 (254)	18 (457)	13 (330)	13 1/2 (343)	19 1/2 (495)	37 (941)	17 3/4 (451)	63 7/8 (1624)	7 7/8 (200)	11 3/4 (300)	2 1/4 (56)	638 (290)	725 (329)
12 (300)	12 (305)	19 3/4 (502)	14 (356)	14 1/2 (368)	22 1/2 (570)	42 1/4 (1073)	21 (533)	73 1/2 (1868)	7 7/8 (200)	11 3/4 (300)	2 1/4 (56)	883 (400)	1003 (455)
14 (350)	13 1/4 (337)	22 1/2 (572)	15 (381)	15 1/2 (394)	25 1/8 (638)	45 1/2 (1156)	22 (560)	79 1/8 (2010)	7 7/8 (200)	11 3/4 (300)	2 1/4 (56)	1365 (619)	1551 (704)
16 (400)	15 1/4 (387)	24 (610)	16 (406)	16 1/2 (419)	28 1/8 (715)	51 3/4 (1315)	23 7/8 (608)	90 3/8 (2297)	7 7/8 (200)	11 3/4 (300)	2 1/4 (56)	1915 (869)	2176 (987)
18 (450)	17 1/4 (438)	26 (660)	17 (432)	17 1/2 (445)	31 1/2 (800)	58 1/4 (1480)	26 3/4 (680)	101 5/8 (2580)	7 7/8 (200)	11 3/4 (300)	2 1/4 (56)	2458 (1115)	2793 (1267)
20 (500)	19 1/4 (489)	28 (711)	18 (457)	18 1/2 (470)	34 5/8 (880)	64 1/8 (1630)	29 1/8 (740)	111 (2820)	7 7/8 (200)	11 3/4 (300)	2 1/4 (56)	3164 (1435)	3596 (1631)
22 (550)	21 1/4 (540)	*	*	*	37 3/4 (960)	69 1/4 (1760)	31 1/2 (800)	120 1/2 (3060)	8 5/8 (220)	19 5/8 (500)	2 7/8 (74)	4061 (1842)	4614 (2093)
24 (600)	23 1/4 (591)	32 (813)	20 (508)	20 1/2 (521)	41 7/8 (1065)	73 1/2 (1867)	33 1/2 (852)	128 7/8 (3273)	8 5/8 (220)	19 5/8 (500)	2 7/8 (74)	5093 (2310)	5787 (2625)
26 (650)	25 (635)	34 (864)	22 (559)	*	43 3/4 (1110)	80 3/8 (2040)	36 1/4 (920)	139 3/8 (3540)	8 5/8 (220)	19 5/8 (500)	2 7/8 (74)	5948 (2698)	6759 (3066)
28 (700)	27 (686)	36 (914)	24 (610)	*	46 7/8 (1190)	85 7/8 (2180)	38 1/4 (970)	148 7/8 (3780)	9 1/2 (241)	19 5/8 (500)	3 5/8 (92)	7062 (3203)	8025 (3640)
30 (750)	29 (737)	36 (914)	26 (660)	*	49 5/8 (1260)	91 3/8 (2320)	40 1/2 (1030)	157 1/2 (4000)	9 1/2 (241)	19 5/8 (500)	3 5/8 (92)	8298 (3764)	9429 (4277)
32 (800)	30 3/4 (781)	38 (965)	28 (711)	*	52 3/4 (1340)	96 1/2 (2450)	42 1/2 (1080)	167 3/8 (4250)	12 5/8 (320)	19 5/8 (500)	4 (102)	10009 (4540)	11374 (5159)
34 (850)	32 3/4 (832)	40 (1016)	30 (762)	*	55 7/8 (1420)	102 3/8 (2600)	44 7/8 (1140)	177 1/8 (4500)	12 5/8 (320)	19 5/8 (500)	4 (102)	11924 (5408)	13549 (6146)
36 (900)	34 1/2 (876)	40 (1016)	32 (813)	*	58 5/8 (1490)	107 7/8 (2740)	47 1/4 (1200)	186 1/4 (4730)	12 5/8 (320)	19 5/8 (500)	4 (102)	13689 (6209)	15556 (7056)
38 (950)	36 1/2 (927)	*	*	*	61 3/4 (1570)	113 (2870)	49 5/8 (1260)	195 1/4 (4960)	12 5/8 (320)	19 5/8 (500)	4 (102)	14938 (6776)	16975 (7700)
40 (1000)	38 1/2 (978)	*	*	*	65 (1650)	118 7/8 (3020)	52 (1320)	204 3/4 (5200)	12 5/8 (320)	19 5/8 (500)	4 (102)	16079 (7293)	18272 (8288)
42 (1050)	40 1/4 (1022)	*	*	*	68 1/8 (1730)	124 3/8 (3160)	53 7/8 (1370)	214 5/8 (5450)	16 1/8 (410)	31 1/2 (800)	4 1/2 (115)	19773 (8969)	22469 (10192)
48 (1200)	46 (1168)	*	*	*	76 3/4 (1950)	141 (3580)	61 (1550)	242 7/8 (6170)	16 1/8 (410)	31 1/2 (800)	4 1/2 (115)	26427 (11987)	30031 (13622)
54 (1350)	51 3/4 (1314)	*	*	*	86 1/4 (2190)	157 1/2 (4000)	67 3/4 (1720)	270 7/8 (6880)	17 7/8 (453)	31 1/2 (800)	5 7/8 (150)	32593 (14784)	37037 (16800)
56 (1400)	53 3/4 (1365)	*	*	*	89 (2260)	163 3/8 (4150)	69 5/8 (1770)	280 3/4 (7130)	17 7/8 (453)	31 1/2 (800)	5 7/8 (150)	35309 (16016)	40124 (18200)
60 (1500)	57 1/2 (1461)	*	*	*	94 7/8 (2410)	173 1/4 (4400)	74 (1880)	299 1/4 (7600)	19 5/8 (500)	31 1/2 (800)	6 1/8 (155)	40741 (18480)	46297 (21000)

* Upon Request

Flanges up to 24 in. (600 mm) (except 22 in. (550 mm)) in accordance with ASME B16.5;
22 in. (550 mm) and above 24 in. (600 mm) in accordance with MSS-SP-44 if applicable.

Shaded Dimensions in accordance to ISO 14313
Butt Welding Ends according to ASME B16.25