

Grooved Butterfly Valve

FIG. 2902

Specification

- Meet or exceed the requirements of EN593, AS4795.1 and MSS SP-67.
- Rubber encapsulated ductile iron disc.
- 2 shafts design.
- Mounting flange in accordance with ISO 5211 or MSS SP-102.
- Grooved ends connection dimensions meet AWWA C606 standard or other IPS pipe.

Working Pressure and Temperature

- 16 bar / 250psi rated at -10°C to 120°C for EPDM encapsulated disc.
- 16 bar / 250psi rated at -10°C to 87°C for BUNA-N encapsulated disc.

Corrosion Protection

- Fusion bonded coating interior and exterior.

Options

- SS 304 / 316 stainless steel shaft.
- BUNA-N encapsulated disc.
- Gear operator or handle operated.
- Built-in temper switch of gear operator.

Material Specifications

Part	Material	EN Specification	ASTM Specification
Body	Ductile Iron	EN1563 EN-GJS-450-10	A536 65-45-12
Shaft	Stainless Steel	EN10088 X20Cr13	A276 Grade 420
Disc	EPDM Encapsulated Ductile Iron		
Bushing	Plastic	Commercial, PTFE	
Shaft Sealing	O-Ring	EN681, BUNA-N	D2000 NBR

Schematic

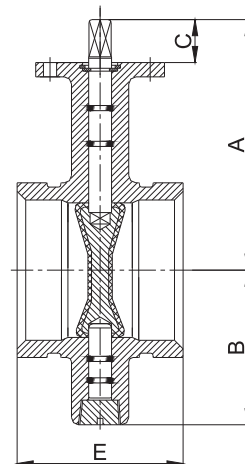

Dimensions(mm)

Size	DN50	DN65	DN80	DN100	DN125	DN150	DN200	DN250	DN300
A	125	140	150	180	205	215	245	295	320
B	80	85	90	110	120	145	180	230	260
E	84	97	97	116	148	148	133	159	165
Shaft Top Section	11×11			14×14		17×17		22×22	
Mounting Flange	F07						F10		
C	30								

Notes

- Designs, materials and specifications shown are subject to change without notice due to the continuous development of our products.