

- High pressure swing check valve ▪ 640 AB ▪ DRI 27
- Class 900-4500 ▪ (PN 100-720) ▪ NPS 2 1/2 - 24 ▪ (DN 65-600)

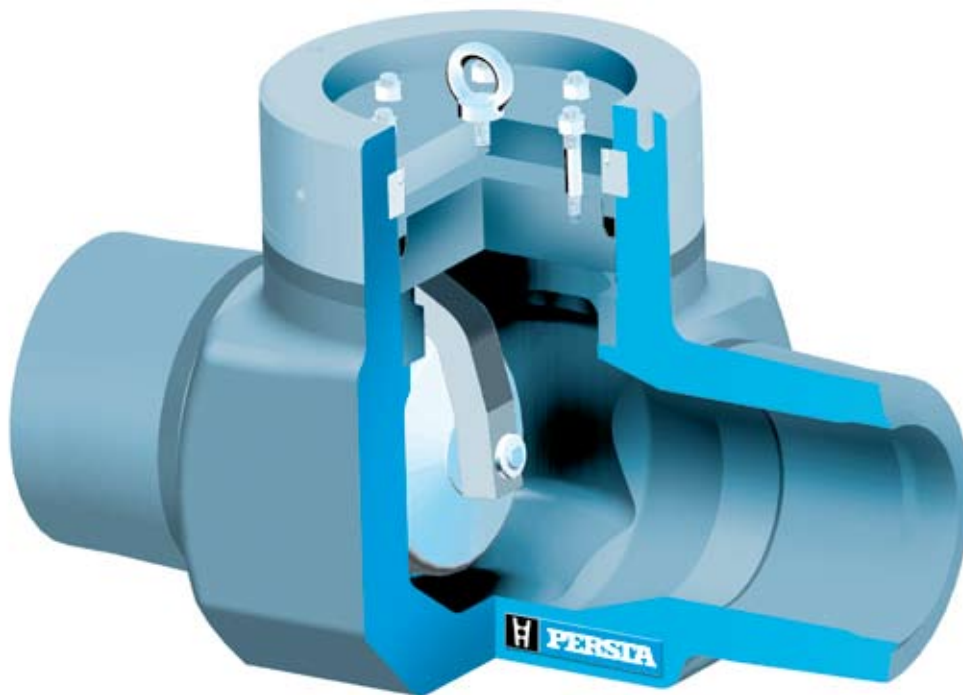

- **High pressure swing check valve** ▪ **640 AB** ▪ **DRI 27**
- **Class 900-4500** ▪ **(PN 100-720)** ▪ **NPS 2 1/2 - 24** ▪ **(DN 65-600)**

Standard features

- Valve body made of forged steel
- Swing check valve with internal hinge pin
- Lever rests in a separate support ring
- Welded seat ring
- Pressure sealing bonnet acc. VGB-guidelines

Pressure and temperature ratings

- Up to standard class or special class 4500

Materials

- A 105
- A 182 F12 Cl.2
- A 182 F22 Cl.3
- A 182 F91
- A 182 F92

Further materials on request.

Media

Depending on the material swing check valves are suitable for water, gas, oil and other non aggressive media

Fields of application

High temperature steam and water, refining (catalytic reformers and hydrocrackers), petrochemical and chemical industries

Design Highlights

- Valve body made of forged steel
- Seats faced with stellite
- Lever rests in a separate support ring
- Shut-off device with curved journal
- Pressure sealing bonnet

Benefits

- Free from porosity and shrink holes
- Extremely resistant to wear
- The setting of the disc can be examined before installing the bonnet cover
- Optimum alignment of the disc to the body seat
- Best possible sealing function

- High pressure swing check valve ▪ 640 AB ▪ DRI 27
- Class 900-4500 ▪ (PN 100-720) ▪ NPS 2 1/2 - 24 ▪ (DN 65-600)

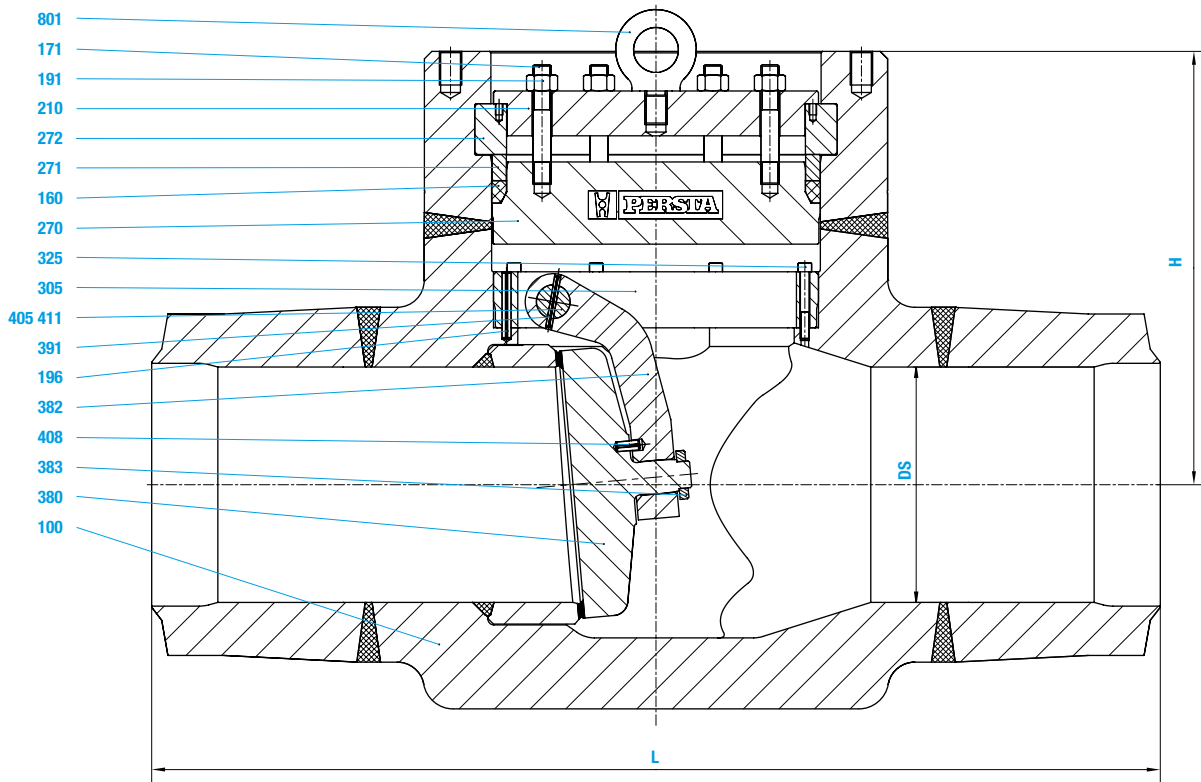

- High pressure swing check valve ▪ 640 AB ▪ DRI 27
- Class 900-4500 ▪ (PN 100-720) ▪ NPS 2 1/2 - 24 ▪ (DN 65-600)

Materials						
Pos.	Component	A 105 (B1)	A 182 F12 (D4)	A 182 F22 (D5)	A 182 F91 (F3)	A 182 F92 (F6)
100	Body	A 105	A 182 F12 Cl.2	A 182 F22 Cl.3	A 182 F91	A 182 F92
160	▶ Gasket	Graphite	Graphite	Graphite	Graphite	Graphite
171	Stud	A 182 B7	A 182 B7	A 182 B7	A 182 B7	A 182 B7
191	Hexagonal nut	A 194 2H	A 194 2H	A 194 2H	A 194 2H	A 194 2H
196	▶ Tension pin	1.4310	1.4310	1.4310	1.4310	1.4310
210	Bonnet	A 182 F22 Cl.3	A 182 F22 Cl.3	A 182 F22 Cl.3	A 182 F91	A 182 F91
270	Cover	A 105	A 182 F12 Cl.2	A 182 F22 Cl.3	A 182 F91	A 182 F92
271	Ring	A 105	A 182 F12 Cl.2	A 182 F22 Cl.3	A 182 F91	A 182 F92
272	Segmentring	A 105	A 182 F12 Cl.2	A 182 F22 Cl.3	A 182 F91	A 182 F92
305	▶ Supportring	A 105	A 182 F12 Cl.2	A 182 F22 Cl.3	A 182 F91	A 182 F92
325	Headcap screw	A4	A4	A4	A4	A4
380	▶ Disc	A 105	A 182 F12 Cl.2	A 182 F22 Cl.3	A 182 F91	A 182 F92
	welded on with	Stellite	Stellite	Stellite	Stellite	Stellite
382	▶ Hinge	A 105	A 182 F12 Cl.2	A 182 F22 Cl.3	A 182 F91	A 182 F91
383	▶ Washer	A 105	A 182 F12 Cl.2	A 182 F22 Cl.3	1.4923	1.4923
391	▶ Tension pin	1.4310	1.4310	1.4310	1.4310	1.4310
405	▶ Hinge pin	1.4923	1.4923	1.4923	1.4923	1.4923
408	▶ Tension pin	1.4310	1.4310	1.4310	1.4310	1.4310
411	▶ Guide bushing	5.3106	5.3106	5.3106	5.3106	5.3106
801	Lifting eye bolt	1.0401	1.0401	1.0401	1.0401	1.0401
	▶ Spare parts					

Dimensions								
Class 900 NPS			DN	DS	BW L	H	lb	Weight kg
14	350	315	47.3	1200.0	21.3	540.0	5060.0	2300.0
16	400	360	53.2	1350.0	23.6	600.0	7920.0	3600.0
18	450	405	59.0	1500.0	27.2	690.0	11880.0	5400.0
20	500	450	on request					
22	550	500	on request					
24	600	540	on request					
Black in inches, lb. Blue in mm, kg.								
Class 1500 NPS			DN	DS	BW L	H	lb	Weight kg
14	350	315	61.0	1550.0	22.8	580.0	5060.0	2300.0
16	400	360	68.9	1750.0	26.0	660.0	7920.0	3600.0
18	450	405	76.8	1950.0	29.5	750.0	11880.0	5400.0
20	500	450	on request					
22	550	500	on request					
24	600	540	on request					
Black in inches, lb. Blue in mm, kg.								

Class 2500 and above on request. Intermediate class on request. Larger sizes on request