

**Longer Life**

The strength of the vulcanised liner as well as its strong bonding with the body ensure that it doesn't get deformed and torn by the disc during valve operations. Further, friction during operations is minimised owing to the smooth liner surface. The strong seat and reduced friction greatly enhance service life of the valve.

**Tight Sealing, and Consistent Low Torque**

Bubble-tight sealing is obtained by the tight interference fit between liner and disc. The insitu moulded seat does not deform with age, and hence the operating torque stays low and consistent during the entire life cycle of the valve. High reliability and consistent torque make Aquaseal Plus the ideal valve for actuated systems.

**Assured Shaft Sealing**

The flat profiles on the top and bottom of Aquaseal Plus disc engage with matching profiles on the body liner, and the large area of contact prevents leakage to atmosphere. Integrally moulded O-Ring that compresses around the blowout-proof shaft provide a secondary seal. An additional O-Ring which provides tertiary sealing is an Aquaseal Plus hallmark.

**Actuator Mounting Platform**

The integral ISO 5211 platform facilitates direct mounting of actuators and gear units, thereby improving system reliability and efficiency.

**Enhanced Reliability**

The rugged body is designed to withstand pipeline stresses and vibrations. Further, enhanced liner thickness assures reliable performance over an extended service. Reinforcements are provided on Aquaseal Plus disc also.

**Lower Torque, Longer Life**

The Aquaseal Plus disc is profiled for smoother flow. Further the coating/ encapsulation of Nylon and EPDM on the disc helps to reduce torque and prevent disc damage.

**Reliable Drive**

In Aquaseal Plus a two-piece shaft is employed for closer control and smooth operation. The shaft is Xylan-coated to reduce friction and improve wear resistance. While the square shaft provides positive drive, the bottom shaft acts as a pivot for operational ease.



## Aquaseal Plus Integrally-moulded Butterfly Valve - Class 150 (Wafer & Lugged)

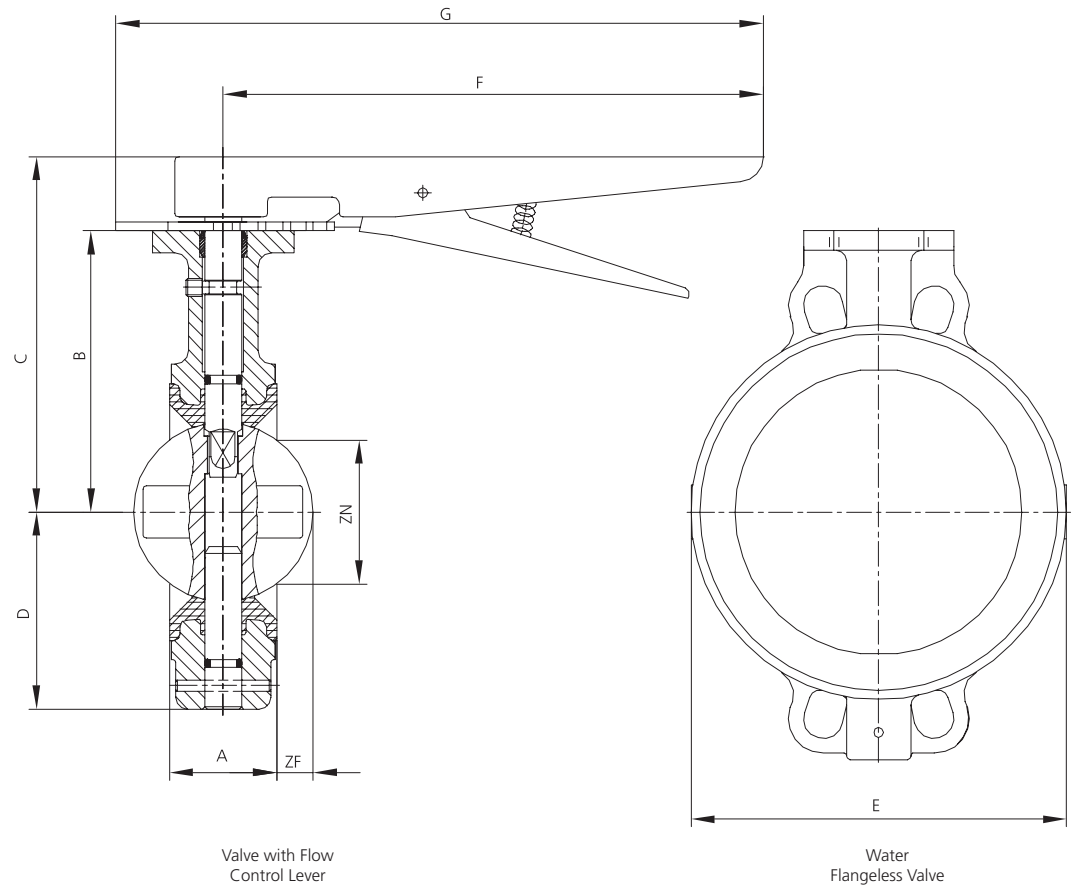

### Dimensions

Valve Size		A	B	C			D	E	
				Flow Control Lever	Standard Gear Unit	Heavy Duty Gear Unit		Wafer Flangeless	Wafer Lugged
NPS	DN								
2	50	43	99	129	277		65	102	158
2½	65	46	110	140	288		78	112	180
3	80	46	117	147	294		85	127	190
4	100	52	135	165	312		105	162	216
5	125	56	164	194	342		118	192	255
6	150	56	177	207	355		144	212	280
8	200	60	235	302	428	450	169	272	345
10	250	68	259	326	452	476	214	322	405
12	300	78	284	351	477	501	249	377	485
14	350	92	318		510	535	304	432	530
16	400	102	370			587	340	483	600
18	450	114	409			790	408	526	650
20	500	127	441			828	430	585	710
24	600	154	501			889	500	687	820

All dimensions in mm and weights in kg

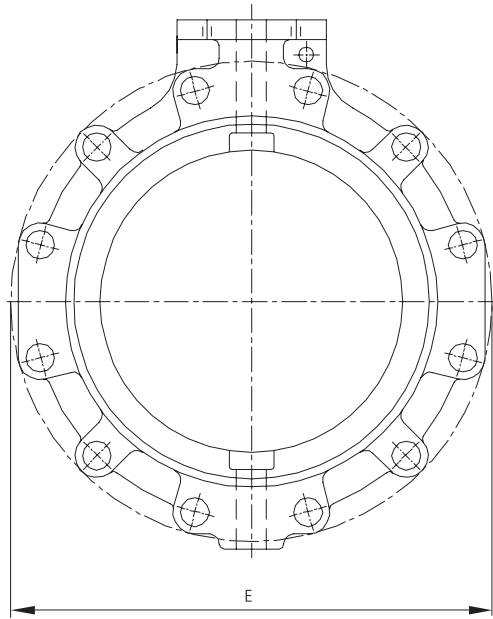

Water  
Lugged Valve

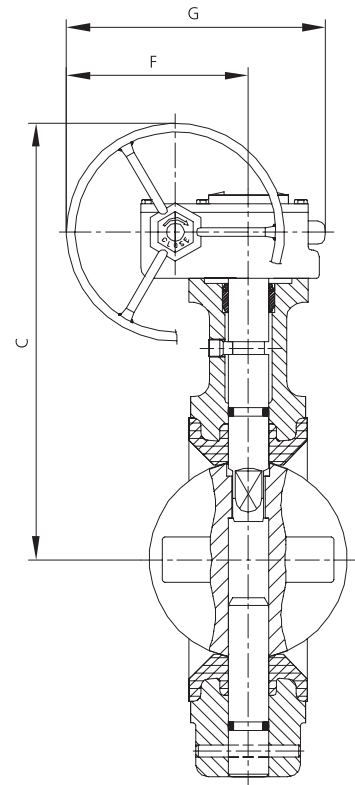

Valve with  
Gear Unit

Flow Control Lever	F		Flow Control Lever	G		ZN	ZF	Weight			
	Standard Gear Unit	Heavy Duty Gear Unit		Standard Gear Unit	Heavy Duty Gear Unit			Flow Control Lever		Standard Gear Unit	
								Wafer	Lugged	Wafer	Lugged
268	181		320	242		24	4	4	5	12	13
268	181		320	242		46	10	5	7	13	15
268	181		320	242		62	16	6	9	14	17
268	181		320	242		82	23	8	11	16	19
268	181		320	242		107	32	11	15	19	23
268	181		320	242		135	45	13	19	21	27
508	217	255	620	290	375	184	67	27	37	29	38
508	217	255	620	290	375	234	88	36	49	38	50
508	217	255	620	290	375	279	106	49	68	50	70
	217	255		290	375	324	123			95	120
		255			375	374	144			125	168
		437			552	423	163			160	215
		437			552	475	183			215	300
		437			552	573	220			320	410

## Aquaseal Plus Integrally-moulded Butterfly Valve - Class 150 (Flanged)

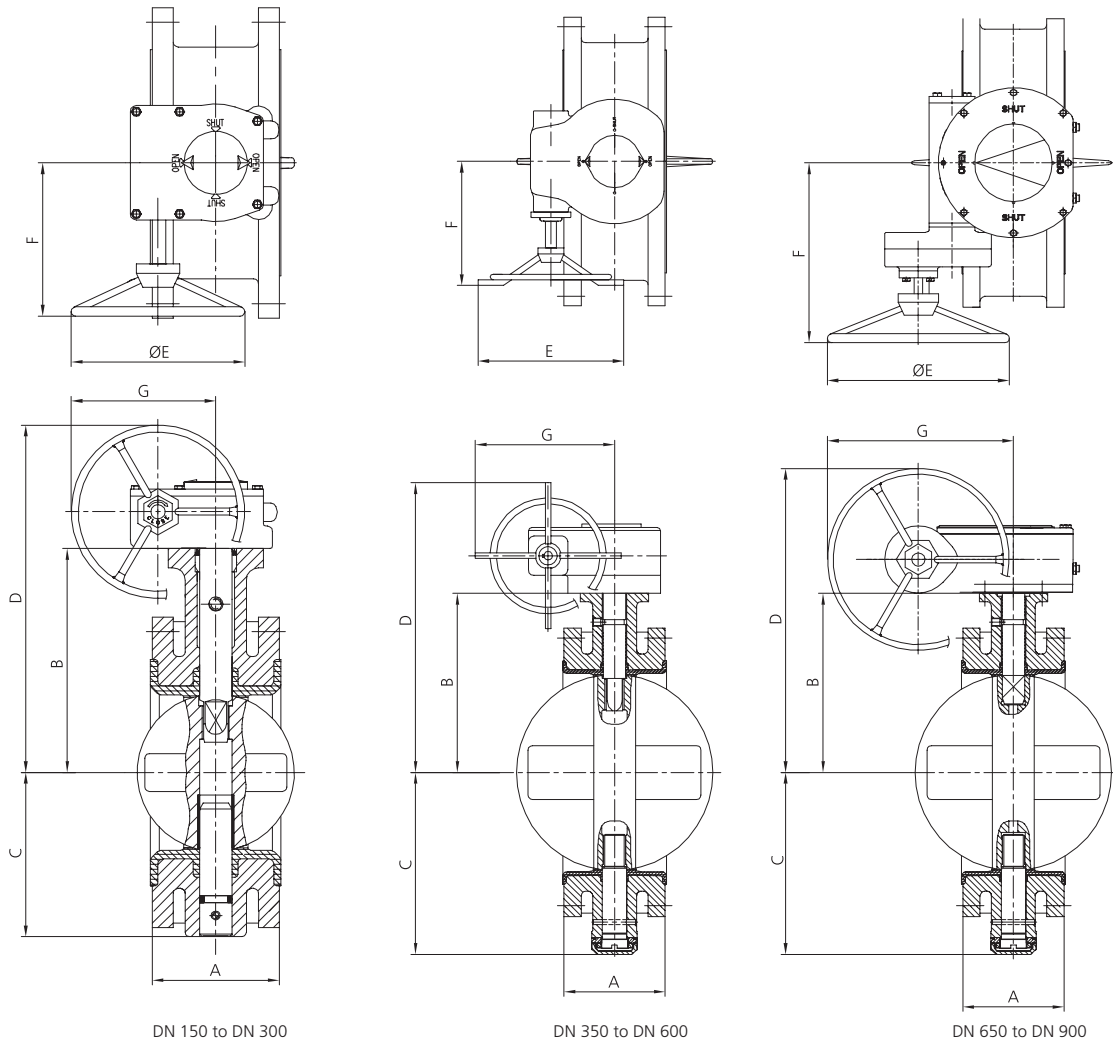

### Dimensions (ASME B16.5)



Valve Size		A	B	C	D	E	F	G	Weight
NPS	DN								
6	150	140	177	144	306	175	163	132	35
8	200	152	235	169	429	300	218	217	52
10	250	165	259	214	453	300	218	217	66
12	300	178	284	249	478	300	218	217	106
14	350	190	318	342	512	300	218	217	150
16	400	216	370	377	587	300	271	255	215
18	450	222	410	445	788	578	338	437	225
20	500	229	440	477	820	578	338	437	278
24	600	267	500	547	880	578	338	437	370

### Dimensions (B16.47 Series A & B or AWWA C207 Class E)

Valve Size		A	B	C	D	E	F	G	Weight <sup>1</sup>	Weight <sup>2</sup>
NPS	DN									
26	650	292	540	587	890	500	510	513	550	450
28	700	292	600	661	950	500	510	513	680	660
30	750	318	625	686	975	500	510	513	840	720
32	800	318	670	750	1120	700	510	613	965	800
36	900	330	720	785	1170	700	510	613	1180	1075

<sup>1</sup>ASME B16.47 Series 'A' & AWWA C207 Class E, <sup>2</sup>ASME B16.47 Series 'B'

All dimensions in mm and weights in kg