

Serial No.	H-V063-E-10
------------	-------------

Self Control Valves

Pressure Reducing Type (V182, V82)

Pressure Relief Type (V185)

Pressure Retaining Type (V186)

Contents

1. Be sure to read the following warranty clauses of our product	1
2. General operating instructions	2
3. General instructions for transportation, unpacking and storage	2
4. Name of parts	3
5. Product functions and specifications	5
6. Maximum working pressure vs. temperature	6
7. Valve flow characteristic	7
Pressure reducing type	7
Pressure relief & retaining type	8
8. Installation procedure	9
Flanged end	10
Threaded end	11
Socket end	12
9. Adjustment procedure for working pressure	13
10. Disassembling method for replacing parts	14
11. Inspection items	15
12. Troubleshooting	16
13. Handling of residual and waste materials	16

User's Manual



4. Name of parts

○ Pressure Reducing Type

V182 (15mm~40mm { 1/2" - 1 1/2" })

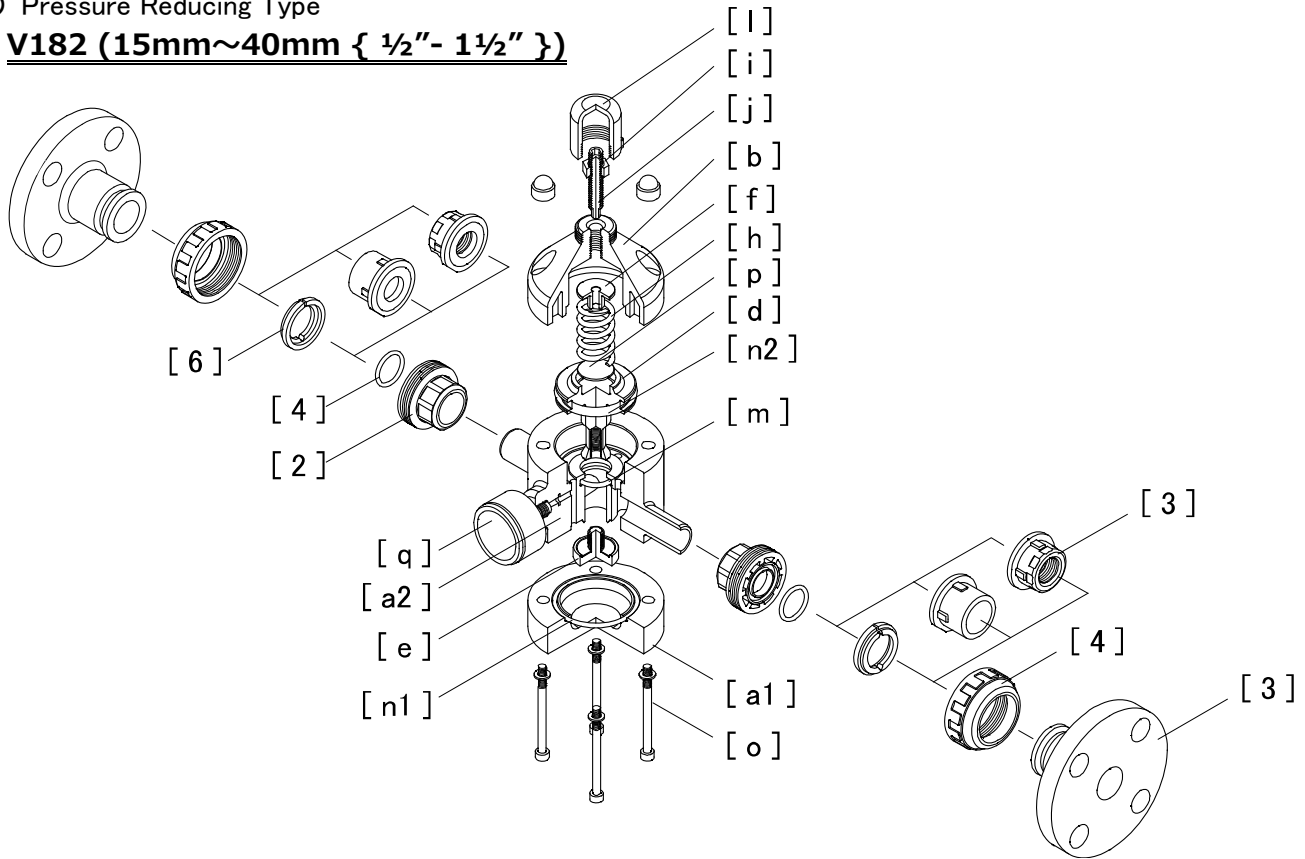

V82 (50mm {2"} ; PTFE spec only)

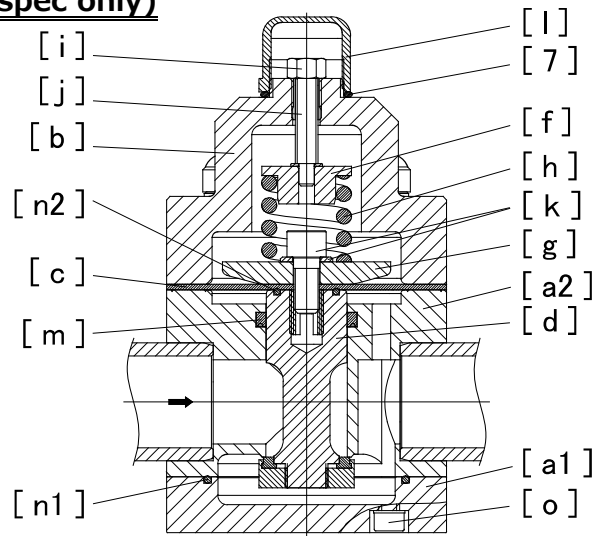

No.	Description	No.	Description	No.	Description	No.	Description
[a1]	Body (Bottom)	[g]	Compressor*1	[n1]	O-Ring (A)	[4]	Union nut
[a2]	Body (Top)	[h]	Compression spring	[n2]	O-Ring (B)	[5]	O-Ring (C)
[b]	Housing	[i]	Lock nut	[o]	Bolt, Nut, Washer	[6]	Stop ring*4
[c]	Diaphragm*1	[j]	Adjusting screw	[p]	Spring support plate*2	[7]	O-Ring (D)
[d]	Piston	[k]	Bolt, Washer*1	[q]	Pressure gauge		
[e]	Piston base*2	[l]	Cap	[2]	PJ-Body*3		
[f]	Spring plate	[m]	Ring seal	[3]	End connector		

*1; Used for V82

*2; Used for V182

*3; Part for self control valve

*4; Used for flange type

○ Pressure Relief Type

V185 (15mm~50mm { 1/2"-2" })

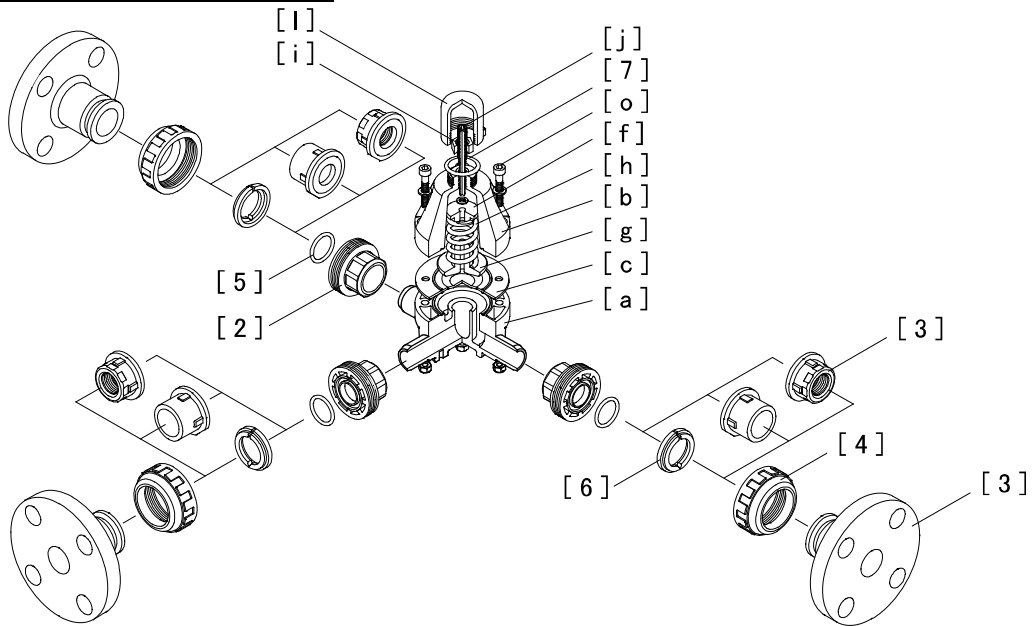

No.	Description	No.	Description	No.	Description	No.	Description
[a]	Body	[g]	Compressor	[i]	Cap	[4]	Union nut
[b]	Housing	[h]	Compression spring	[o]	Bolt, Nut, Washer	[5]	O-Ring (C)
[c]	Diaphragm	[i]	Lock nut	[2]	PJ-Body* ¹	[6]	Stop ring* ²
[f]	Spring plate	[j]	Adjusting screw	[3]	End connector	[7]	O-Ring (D)

*1; Part for self control valve *2; Used for flange type

○ Pressure Retaining Type

V186 (15mm~50mm { 1/2"-2" })

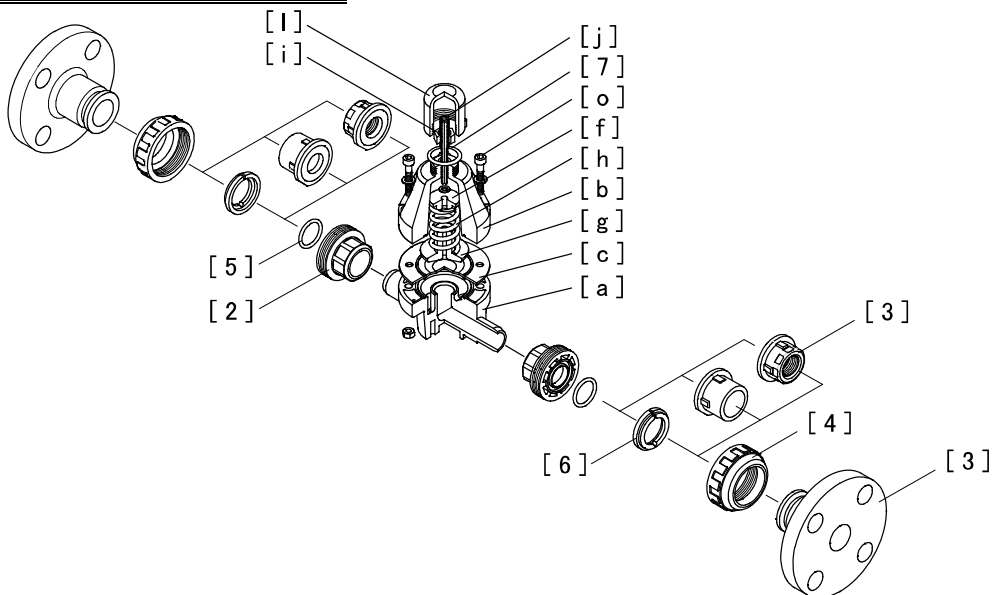

No.	Description	No.	Description	No.	Description	No.	Description
[a]	Body	[g]	Compressor	[i]	Cap	[4]	Union nut
[b]	Housing	[h]	Compression spring	[o]	Bolt, Nut, Washer	[5]	O-Ring (C)
[c]	Diaphragm	[i]	Lock nut	[2]	PJ-Body* ¹	[6]	Stop ring* ²
[f]	Spring plate	[j]	Adjusting screw	[3]	End connector	[7]	O-Ring (D)

*1; Part for self control valve *2; Used for flange type

6. Maximum working pressure vs. temperature

- Pressure Reducing Type (V182, V82), Pressure Relief Type (V185), Pressure Retaining Type (V186)

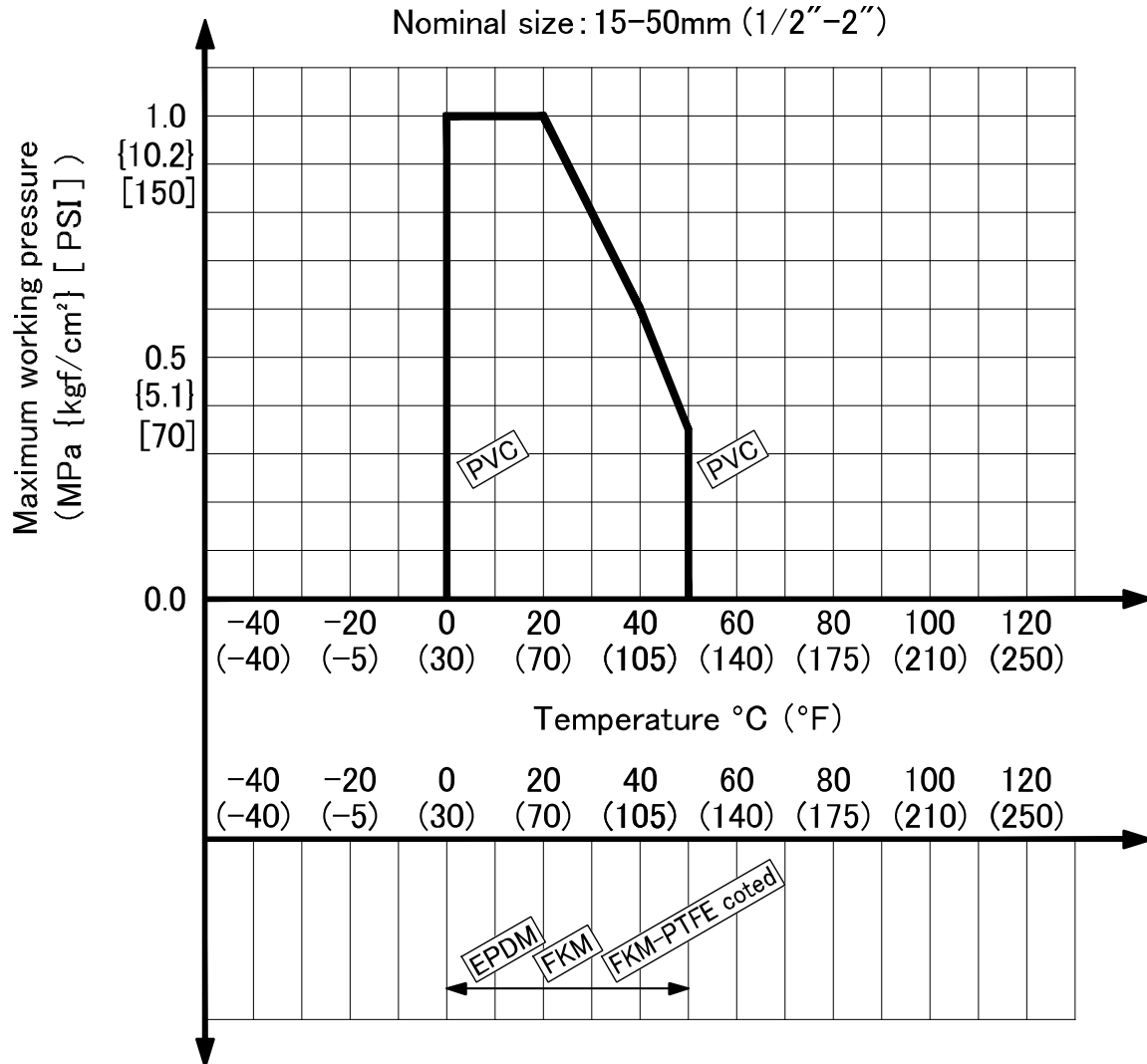

7. Valve flow characteristic

- Pressure Reducing Type (V182)

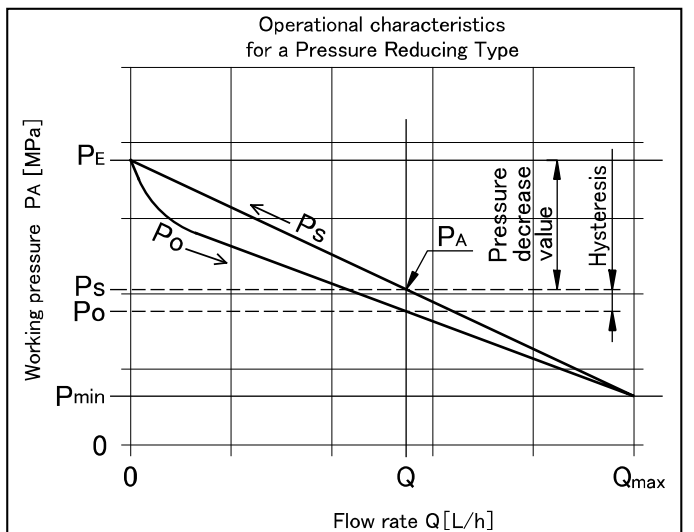
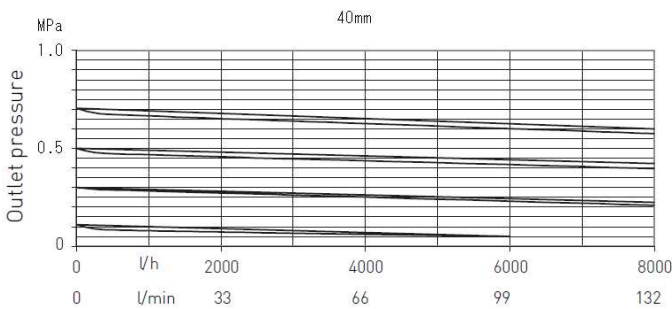
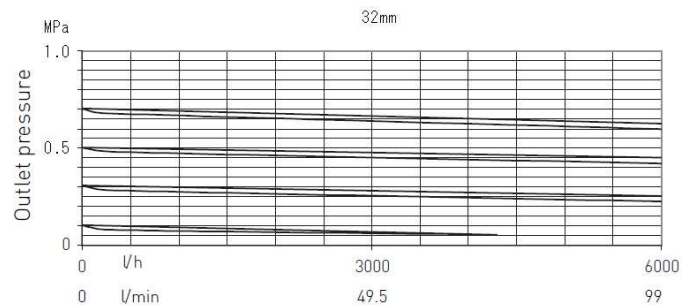
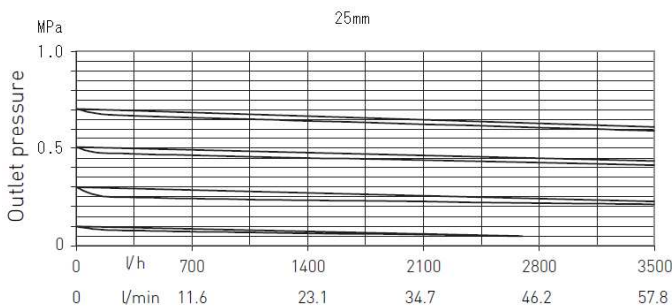
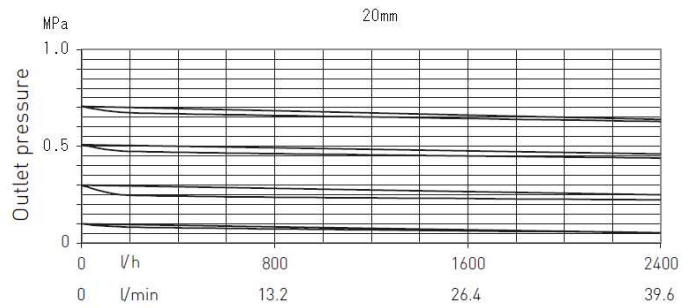
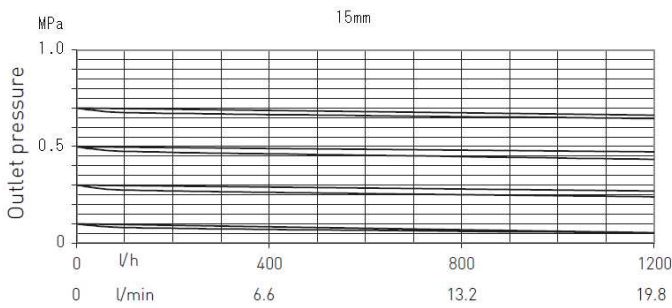

- Pressure Reducing Type (V82)

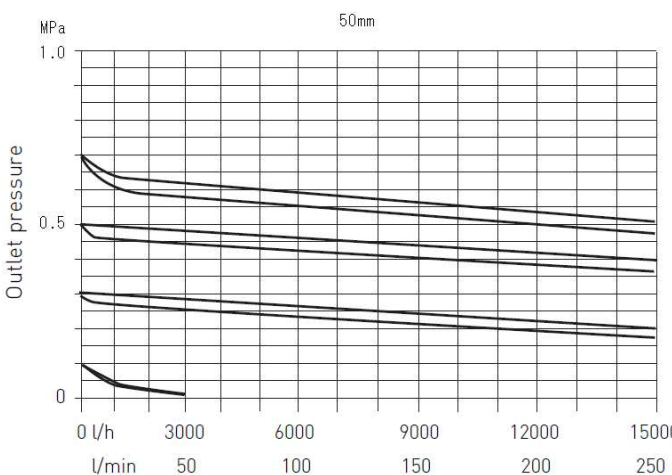

- The friction coefficient increases with the flow rate and the outlet pressure decreases.

- P_E : Set pressure (at a flow rate of 0 L/h)
- $P_E - P_{min}$: Max. pressure reduction value
 - The set pressure is set at P_E . If the flow rate is increased to Q , the outlet pressure will decrease to P_O .
- P_O line : Opening pressure characteristic. (Flow rate increasing)
- P_S line : Closing pressure characteristic. (Flow rate decreasing)
- Hysteresis : The flow rate is affected by the influence of the spring, piston and diaphragm in the valve. The working pressure is also a function of these parts, and will change depending on whether the flow rate is increasing or decreasing.

- Pressure Relief Type (V185), Pressure Retaining Type (V186)

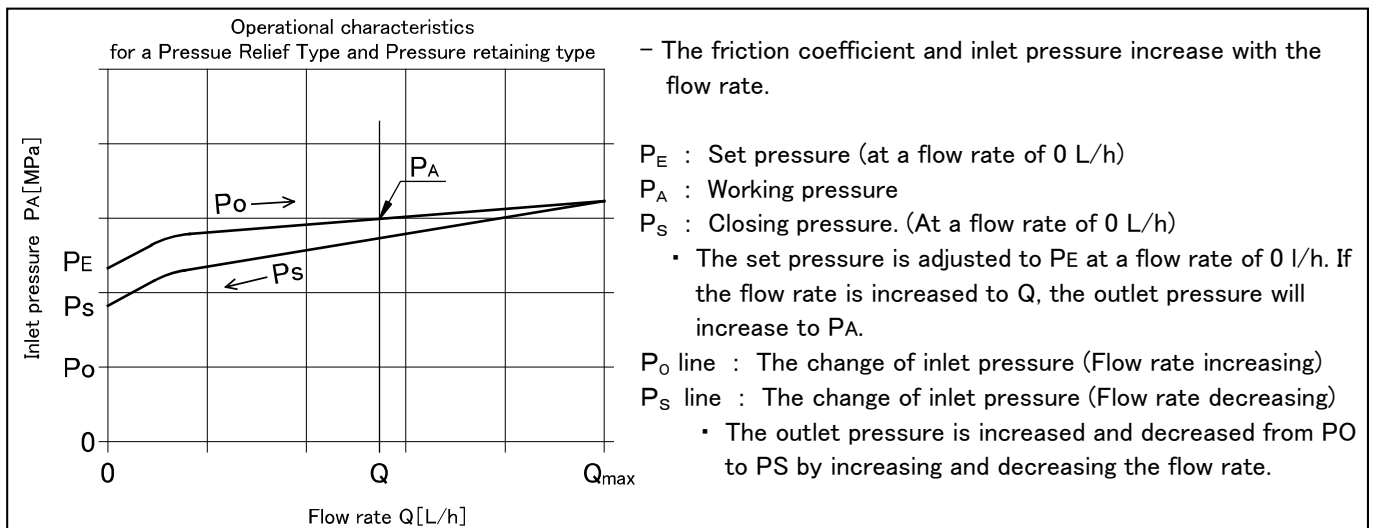
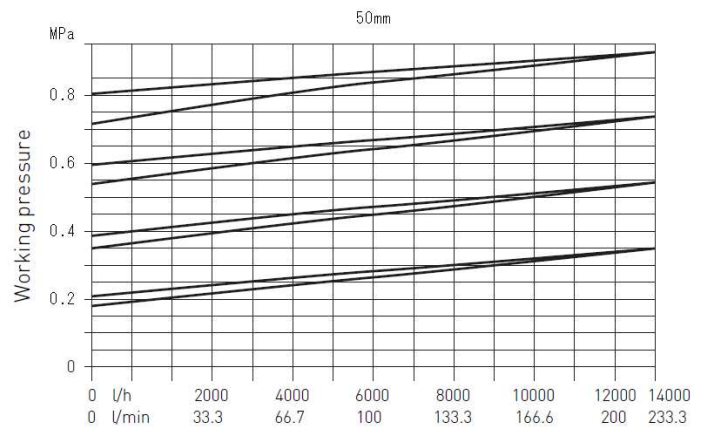
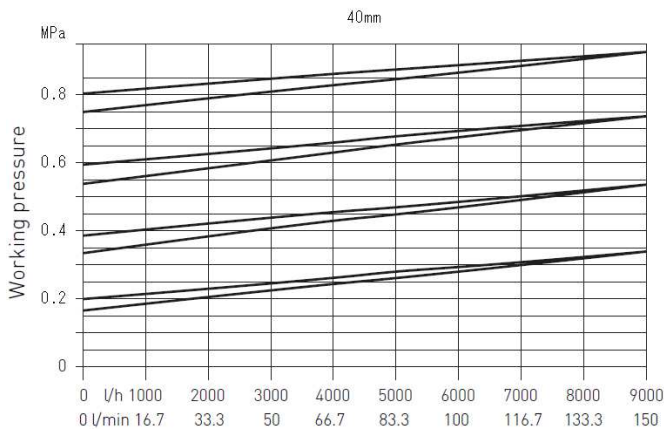
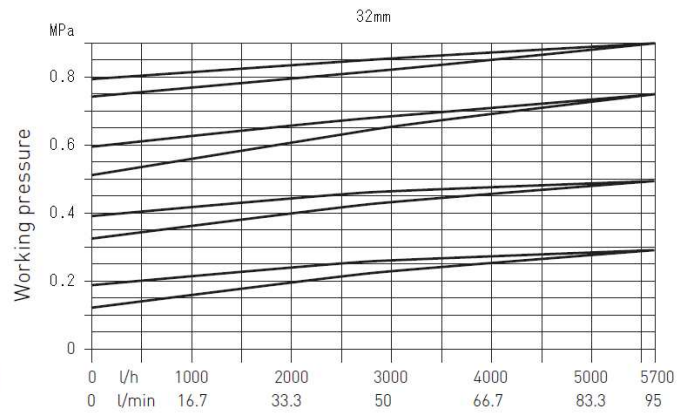
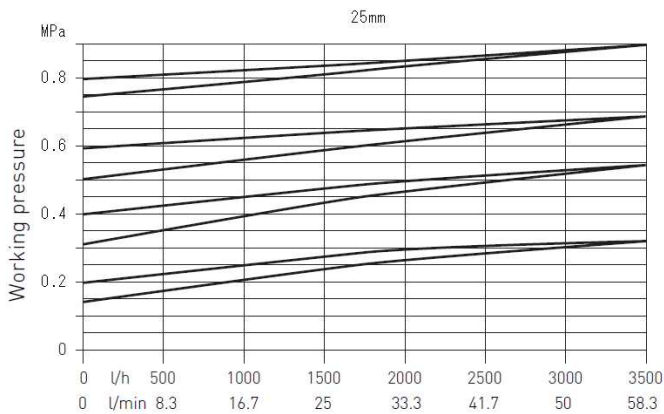
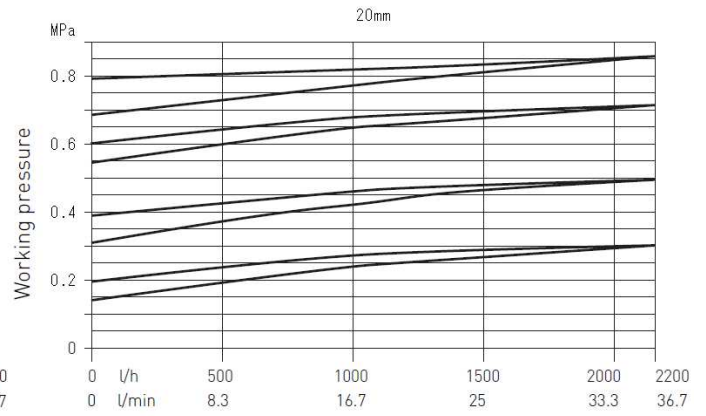
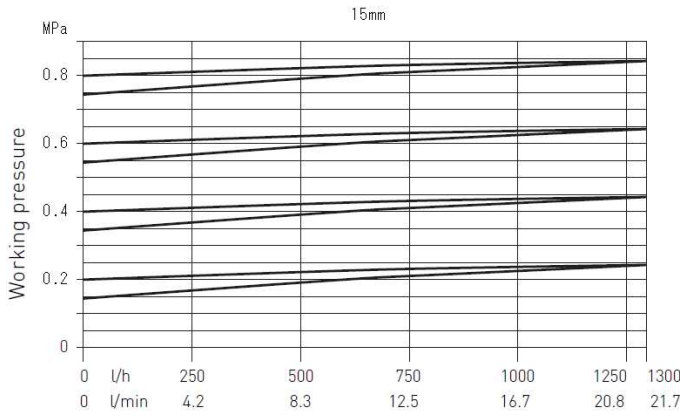

Self Control Valves

Pressure Reducing Type / Pressure Relief Type / Pressure Retaining Type

15-50mm (1/2"-2")

ASAHI YUKIZAI CORPORATIONDistributor<http://www.asahi-yukizai.co.jp/en/>