

Serial No.	H-V027-E-19
------------	-------------

Contents

Ball Valve Type 21・21a

Nominal size 15-100mm (1/2 - 4")

User's Manual



(1) Be sure to read the following warranty clauses of our product	1
(2) General operating instructions	2
(3) General instructions for transportation, unpacking and storage	3
(4) Name of parts	4
(5) Maximum working pressure vs. temperature	6
(6) Specification of valve body	8
(7) Specification of limit switch	8
(8) Installation procedure	9
(9) Connection of limit switch procedure	14
(10) Operating procedure	15
(11) Method of adjusting face pressure between ball and seat	15
(12) Disassembling method for replacing parts	16
(13) Mounting actuator, metal ensat and base (Panel) install the locking device	18
(14) Inspection items	20
(15) Troubleshooting	20
(16) Handling of residual and waste materials	20

(4) Name of parts

Nominal Size: 15-50mm (1/2"-2")

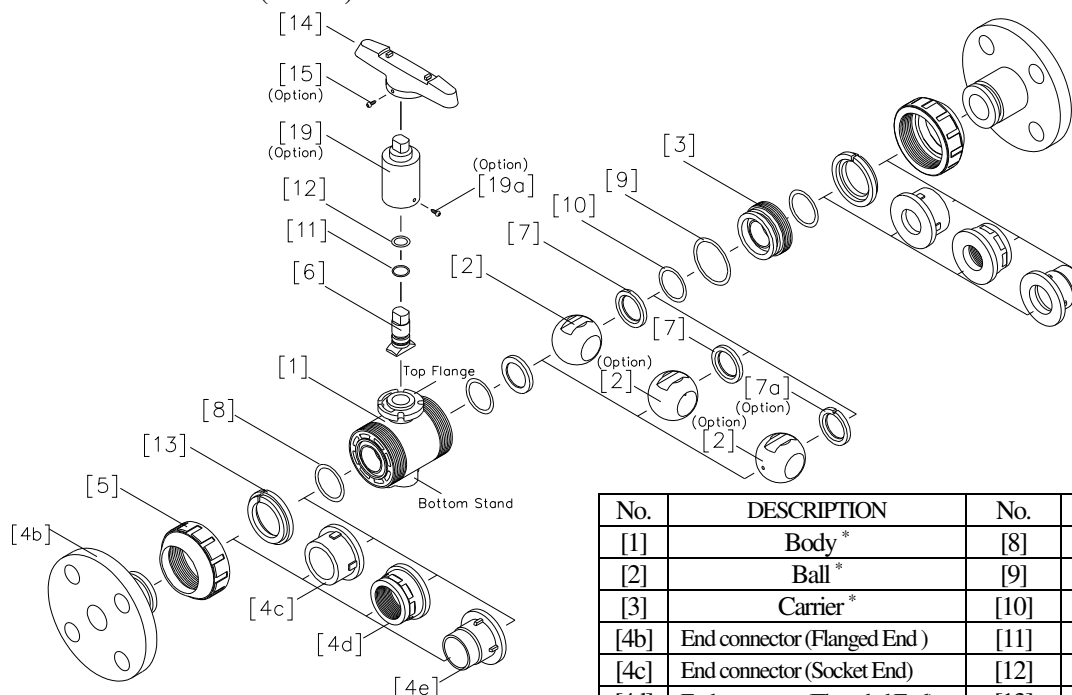

No.	DESCRIPTION	No.	DESCRIPTION
[1]	Body *	[8]	O-ring (A)
[2]	Ball *	[9]	O-ring (B) *
[3]	Carrier *	[10]	O-ring (C) *
[4b]	End connector (Flanged End)	[11]	O-ring (D)
[4c]	End connector (Socket End)	[12]	O-ring (E)
[4d]	End connector (Threaded End)	[13]	Stop ring
[4e]	End connector (Spigot End) *	[14]	Handle
[5]	Union nut	[15]	Tapping screw (A)
[6]	Stem *	[19]	Extension stem
[7]	Seat *	[19a]	Tapping screw (B)
[7a]	Seat (A) *		

*Type21 and 21α have not all same parts to make one complete.

As for details, please consult your nearest service station beforehand.

Nominal Size: 65-100mm (2 1/2"-4")

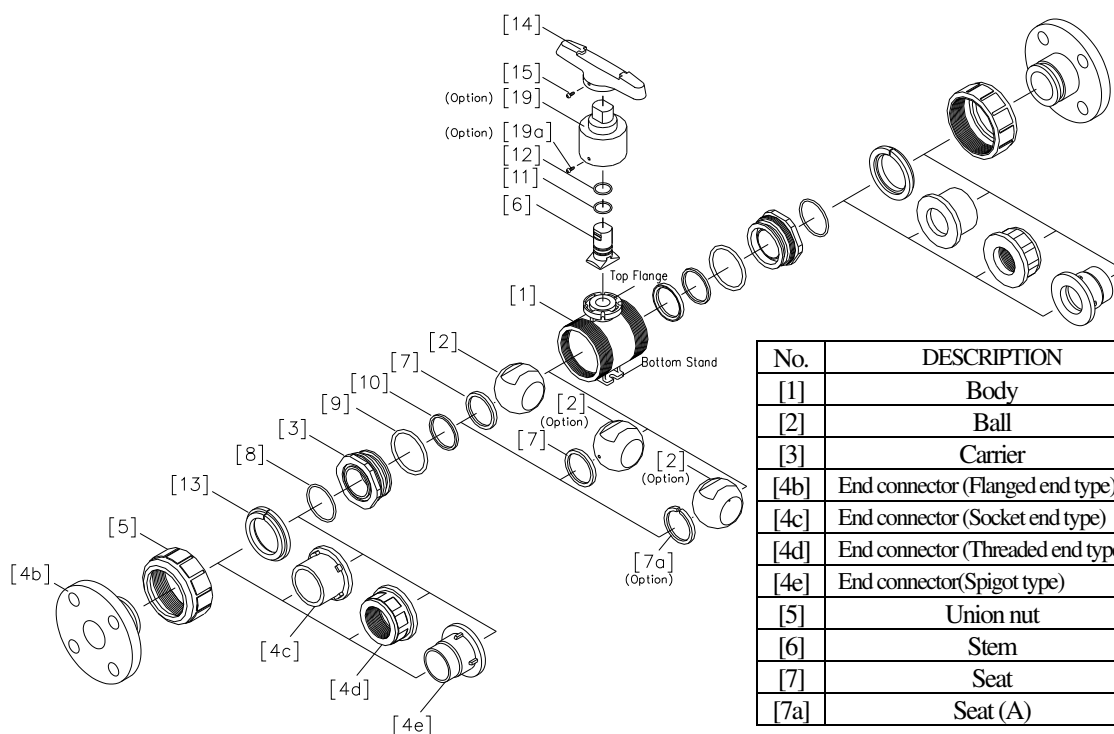

No.	DESCRIPTION	No.	DESCRIPTION
[1]	Body	[8]	O-ring (A)
[2]	Ball	[9]	O-ring (B)
[3]	Carrier	[10]	Cushion
[4b]	End connector (Flanged end type)	[11]	O-ring (C)
[4c]	End connector (Socket end type)	[12]	O-ring (D)
[4d]	End connector (Threaded end type)	[13]	Stop ring
[4e]	End connector (Spigot type)	[14]	Handle
[5]	Union nut	[15]	Tapping screw (A)
[6]	Stem	[19]	Extension stem
[7]	Seat	[19a]	Tapping screw (B)
[7a]	Seat (A)		

Nominal Size: 15-100mm (1/2"-4") with Limit Switch (Option)

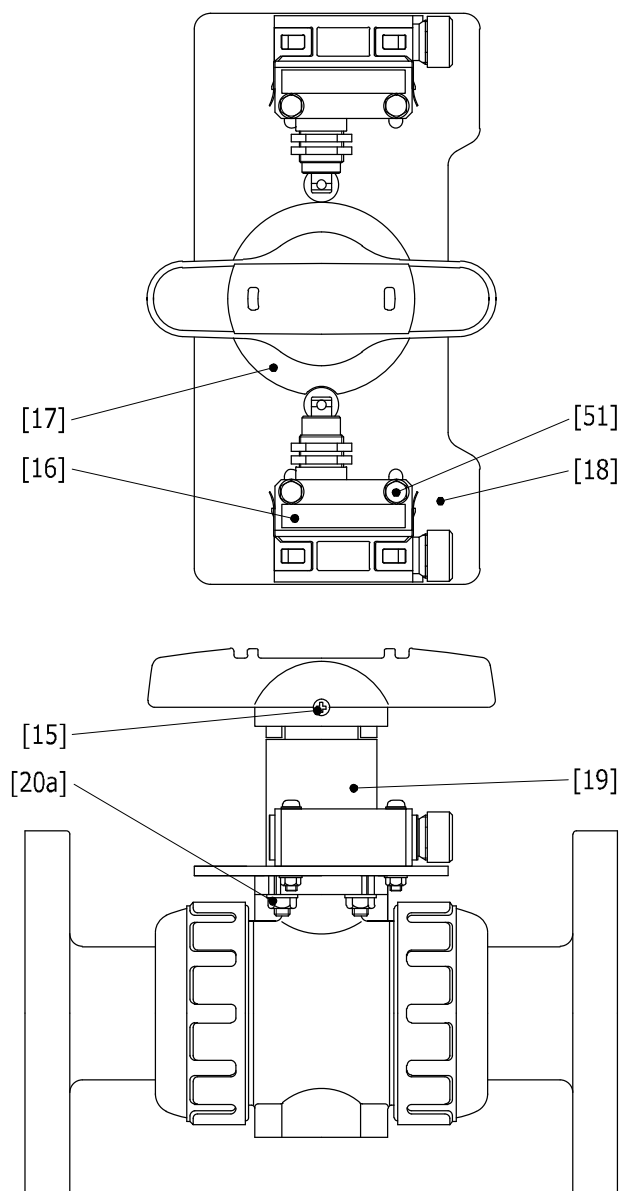

No.	DESCRIPTION	No.	DESCRIPTION
[15]	Tapping screw (A)	[19]	Extension stem
[16]	Limit switch	[20a]	Bolt • Nut(A)
[17]	Limit switch rod	[51]	Screw • Nut (F)
[18]	Bracket (A)		

(5) Maximum working pressure vs. temperature

[When the connection standard is JIS]

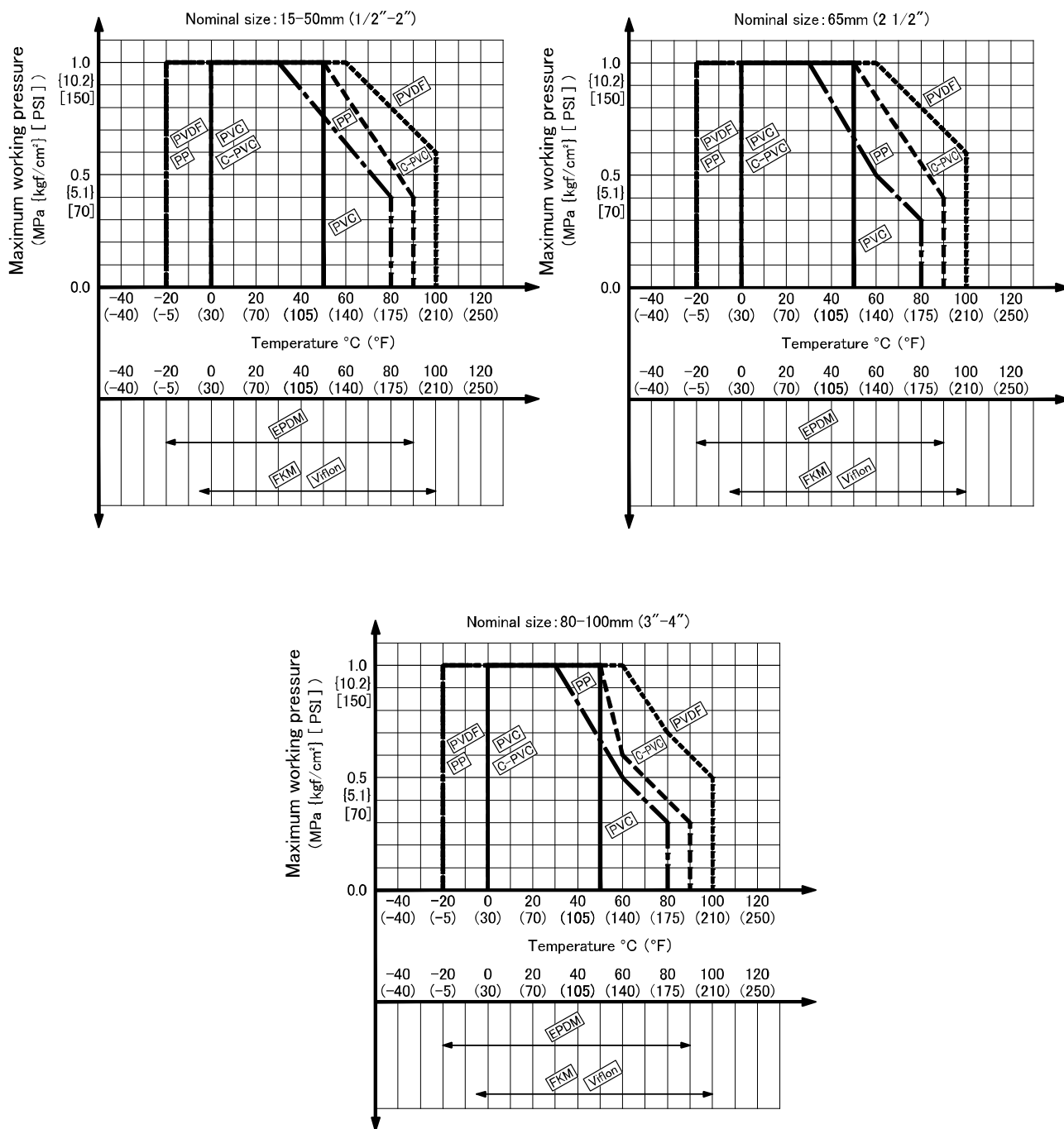

[When the connection standard is ANSI and DIN]

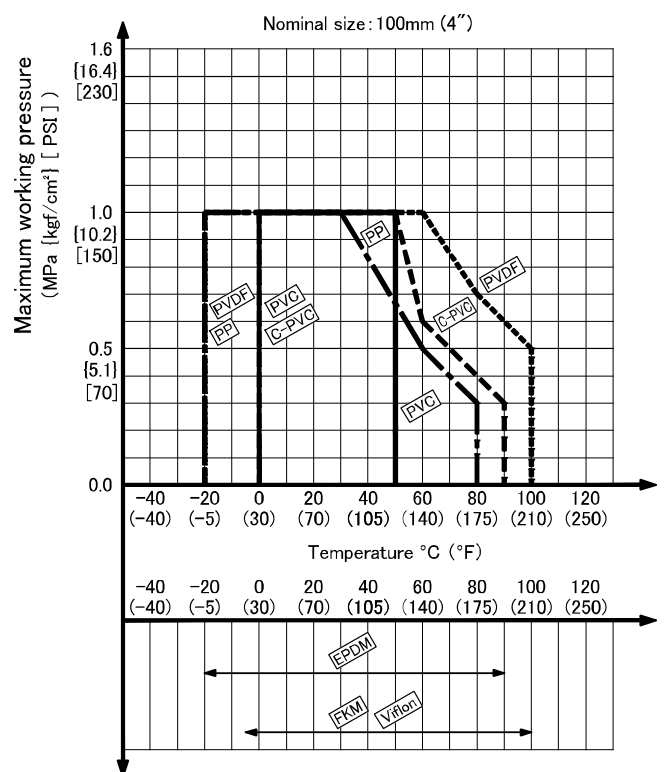
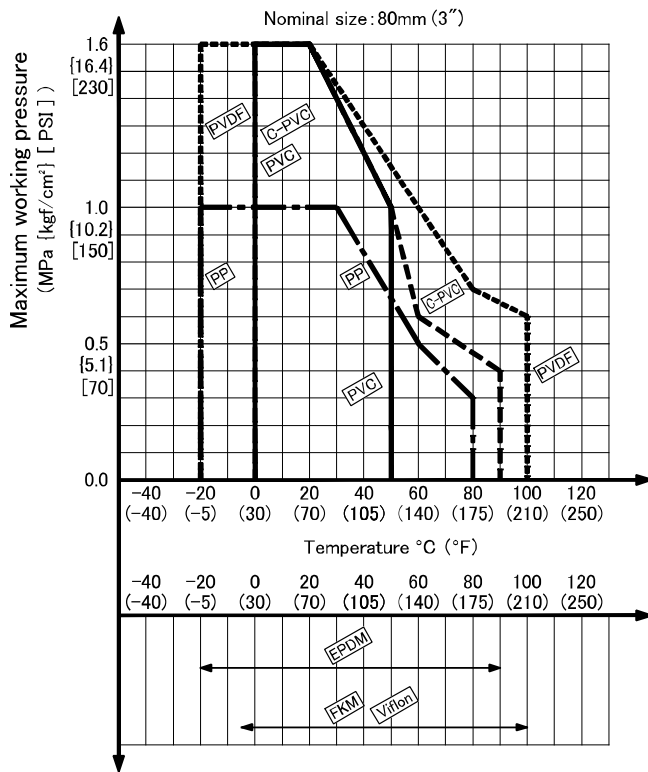
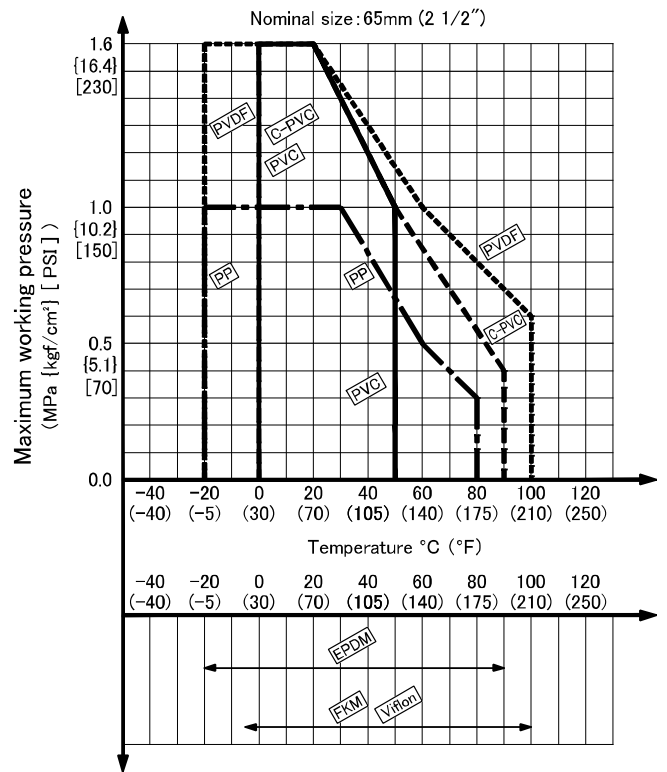
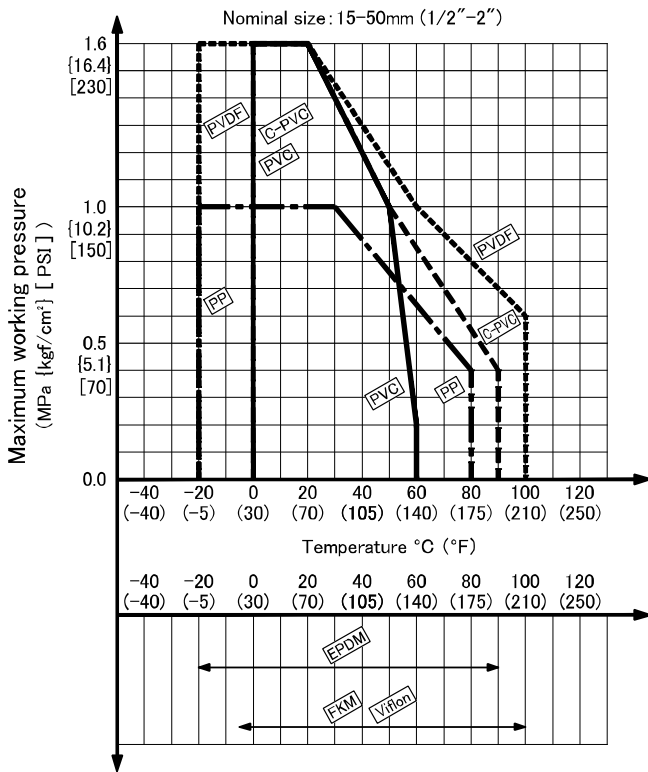

Ball Valve Type 21・21α**ASAHI YUKIZAI CORPORATION**



Distributor

<https://www.asahi-yukizai.co.jp/en/>

Information in this manual is subject to change without notice.

June 2020