

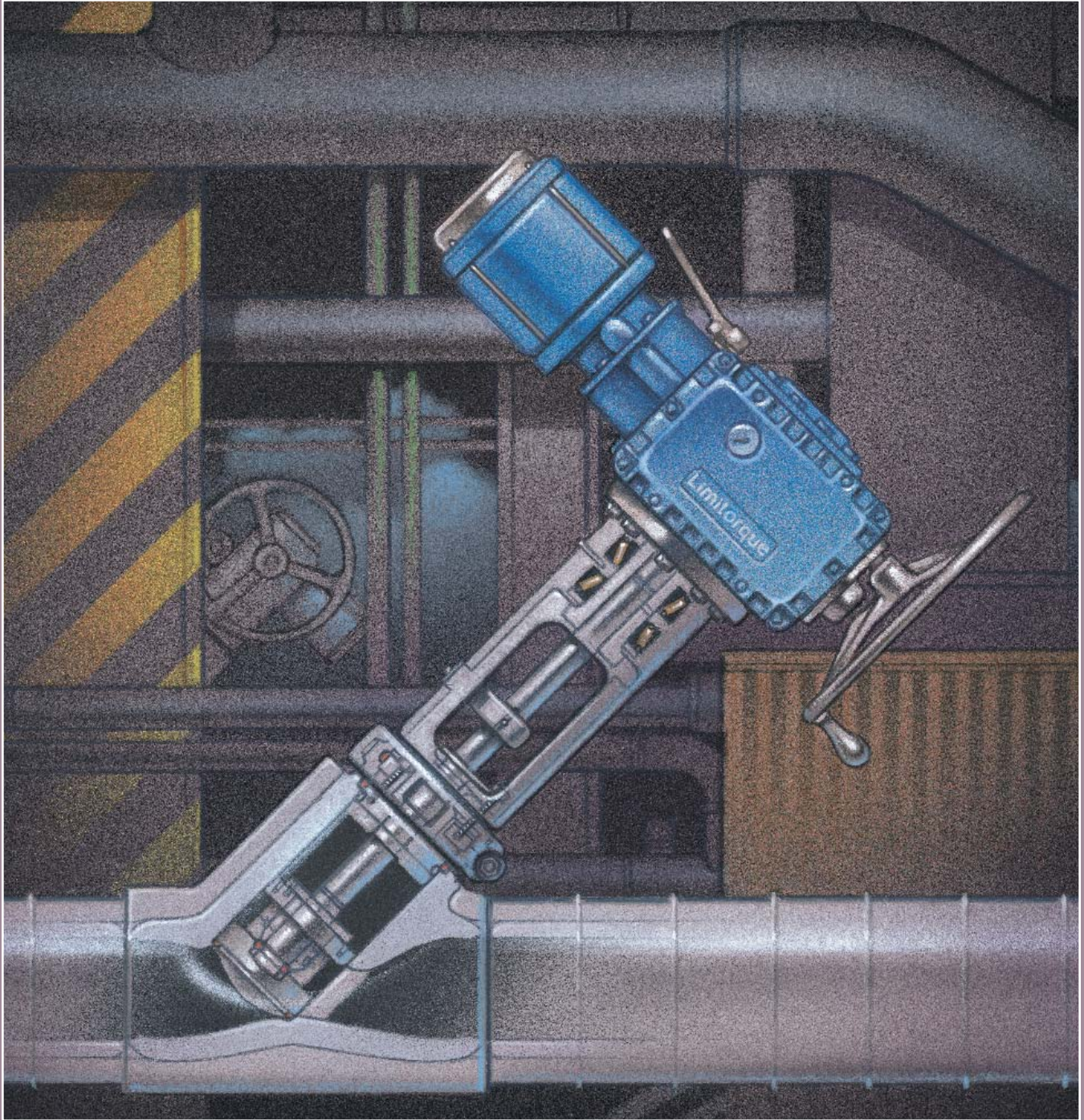

Edward Valves

EV100
5th Edition



Edward Valves *Catalog & Application Manual*

Univalve® Piston Check Valves Class 1690 4225 PSI @ 100°F (291.4 BAR @ 38°C)

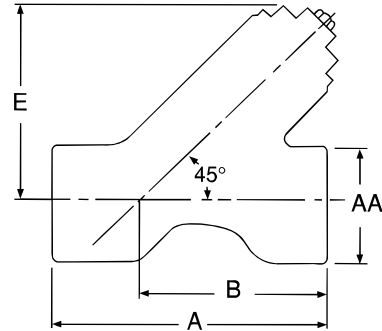
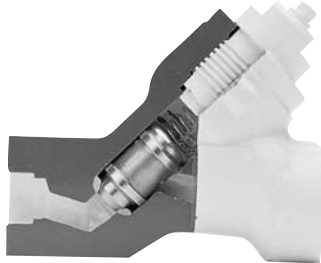

36174

Standard Features

- Available Body Materials
 - A105 carbon steel.
 - F22 alloy steel.
 - F91 alloy steel.
 - F316, F347 stainless steel.
 - Other material on application.
- Unwelded (graphitic seal) or welded cover.
- Y-Pattern.
- Body-guided investment cast Stellite disk.
- Integral Stellite seat.
- Stainless steel spring. (Optional without springs, see page G-14.)

Pressure Class 1690 (PN 290)

FIG. NO.		TYPE	ENDS	NPS (DN)
WELDED	UNWELD.			
36170	36270	Y-Pattern	Threaded	1/2 (15) thru 1 (25)
36174	36274	Y-Pattern	Socket Welding	1/2 (15) thru 2-1/2 (65)
36178	36278	Y-Pattern	Buttwelding	1/2 (15) thru 4 (100)

Dimensions - Globe

Bold face numerals are in inches and pounds.

Green numerals are in millimeters and kilograms.

Figure No. 36170, 36174, 36178, 36270, 36274, 36278	NPS DN	1/2	3/4	1	1-1/4	1-1/2	2	2-1/2	3	4
		15	20	25	32	40	50	65	80	100
A - End to End		6.0 152	6.0 152	6.0 152	6.7 170	6.7 170	8.2 208	10.7 272	10.7 272	12.8 325
AA - End Hub Diameter		2.30 58	2.30 58	2.30 58	3.20 81	3.20 81	3.64 92	4.00 102	4.00 102	4.80 122
B - Center to End		4.0 102	4.0 102	4.0 102	4.8 122	4.8 122	6.1 155	7.1 180	7.1 180	8.8 224
E - Center to Top		3.9 99	3.9 99	3.9 99	5.0 127	5.0 127	5.8 147	7.2 183	7.2 183	7.8 198
Weight		14 6	14 6	14 6	22 10	22 10	31 14	44 20	44 20	86 39

Univalve® Stop-Check Valves Class 2680 6700 PSI @ 100°F (462.1 BAR @ 38°C)

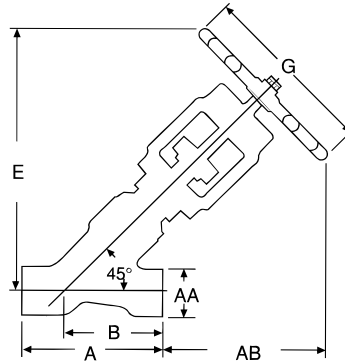

66164

Standard Features

- Available Body Material
 - A105 carbon steel.
 - F22 alloy steel.
 - F91 alloy steel.
 - F316, F347 stainless steel.
 - Other material on application
- Unwelded (graphitic seal) or welded bonnet.
- OS & Y.
- Y-Pattern.
- Body-guided investment cast Stellite disk.
- Integral Stellite seat.
- Integral backseat.
- Asbestos free graphitic packing.

Pressure Class 2680 (PN 460)

FIG. NO.		TYPE	ENDS	NPS (DN)
WELDED	UNWELD.			
66160	66260	Y-Pattern	Threaded*	1/2 (15) thru 1 (25)
66164	66264	Y-Pattern	Socket Welding	1/2 (15) thru 2-1/2 (65)
66168	66268	Y-Pattern	Buttwelding	1/2 (15) thru 4 (100)

*Threaded end valves are limited to Pressure Class 2500

Dimensions - Globe

Bold face numerals are in inches and pounds.

Green numerals are in millimeters and kilograms.

Figure No. 66160, 66164, 66168, 66260, 66264, 66268	NPS DN	1/2 15	3/4 20	1 25	1-1/4 32	1-1/2 40	2 50	2-1/2 65	3 80	4 100
A - End to End		6.0 152	6.0 152	6.0 152	6.7 170	6.7 170	10.7 272	12.8 325	12.8 325	12.8 325
AA - End Hub Diameter		2.30 58	2.30 58	2.30 58	3.20 81	3.20 81	4.00 102	4.80 122	4.80 122	4.80 122
AB - Handwheel Clearance, (Open)		7.5 191	7.5 191	7.5 191	9.8 249	9.8 249	11.6 295	11.2 284	11.2 284	11.2 284
B - Center to End		4.0 102	4.0 102	4.0 102	4.8 122	4.8 122	7.1 180	8.8 224	8.8 224	8.8 224
E - Center to Top, (Open)		11.5 292	11.5 292	11.5 292	14.6 371	14.6 371	18.6 472	20.0 508	20.0 508	20.0 508
G - Handwheel/Handle Diameter		8.5 216	8.5 216	8.5 216	11.0* 279*	11.0* 279*	14.3* 363*	16.0** 406**	16.0** 406**	16.0** 406**
Weight, Welded		19 9	19 9	19 9	34 16	34 16	79 36	142 65	142 65	142 65
Weight, Unwelded		20 9	20 9	20 9	36 17	36 17	83 38	146 66	146 66	146 66

* Impactor Handle

** Impactor Handwheel

Univalve® Piston Check Valves Class 2680 6700 PSI @ 100°F (462.1 BAR @ 38°C)

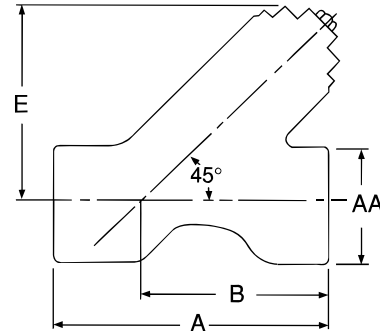
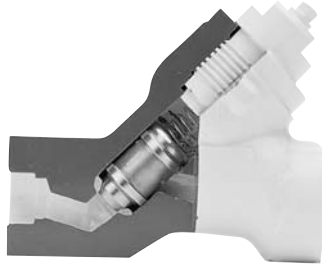

66174

Standard Features

- Available Body Material
 - A105 carbon steel.
 - F22 alloy steel.
 - F91 alloy steel.
 - F316, F347 stainless steel.
 - Other material on application.
- Unwelded (graphitic seal) or welded cover.
- Y-Pattern.
- Body-guided investment cast Stellite disk.
- Integral Stellite seat.
- Stainless steel spring.
(Optional without springs, see page G14.)

Pressure Class 2680 (PN 460)

FIG. NO.		TYPE	ENDS	NPS (DN)
WELDED	UNWELD.			
66170	66270	Y-Pattern	Threaded*	1/2 (15) thru 1 (25)
66174	66274	Y-Pattern	Socket Welding	1/2 (15) thru 2-1/2 (65)
66178	66278	Y-Pattern	Buttwelding	1/2 (15) thru 4 (100)

* Threaded end valves are limited to Pressure Class 2500.

Dimensions - Globe

Bold face numerals are in inches and pounds.

Green numerals are in millimeters and kilograms.

Figure No. 66170, 66174, 66178, 66270, 66274, 66278	NPS DN	1/2 15	3/4 20	1 25	1-1/4 32	1-1/2 40	2 50	2-1/2 65	3 80	4 100
A - End to End		6.0 152	6.0 152	6.0 152	6.7 170	6.7 170	10.7 272	12.8 325	12.8 325	12.8 325
AA - End Hub Diameter		2.30 58	2.30 58	2.30 58	3.20 81	3.20 81	4.00 102	4.80 122	4.80 122	4.80 122
B - Center to End		4.0 102	4.0 102	4.0 102	4.8 122	4.8 122	7.1 180	8.8 224	8.8 224	8.8 224
E - Center to Top, (Open)		3.9 99	3.9 99	3.9 99	5.0 127	5.0 127	7.0 178	7.8 198	7.8 198	7.8 198
Weight		14 6	14 6	14 6	22 10	22 10	52 24	86 39	86 39	86 39

Univalve® Stop Valves Class 4500 11,250 PSI @ 100°F (775.9 BAR @ 38°C)

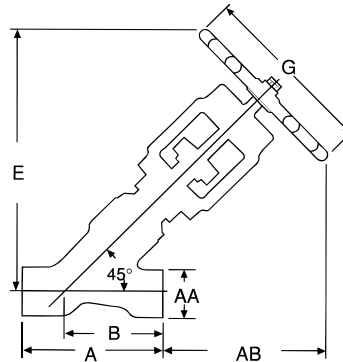

96124

Standard Features

- Available Body Material
 - A105 carbon steel.
 - F22 alloy steel.
 - F91 alloy steel.
 - F316, F347 stainless steel.
 - Other material on application.
- Unwelded (graphitic seal) or welded bonnet.
- OS & Y.
- Y-Pattern.
- Body-guided investment cast Stellite disk.
- Integral Stellite seat.
- Integral backseat.
- Asbestos free graphitic packing.

Pressure Class 4500 (PN 760)

FIG. NO.		TYPE	ENDS	NPS (DN)
WELDED	UNWELD.			
96124	96224	Y-Pattern	Socket Welding	1/2 (15) thru 2 (50)
96128	96228	Y-Pattern	Buttwelding	1/2 (15) thru 4 (100)

Dimensions - Globe

Bold face numerals are in inches and pounds.

Green numerals are in millimeters and kilograms.

Figure No. 96124, 96128 96224, 96228	NPS DN	1/2	3/4	1	1-1/4	1-1/2	2	2-1/2	3	4
A - End to End		8.2 208	8.2 208	8.2 208	8.2 208	8.2 208	12.8 325	12.8 325	12.8 325	12.8 325
AA - End Hub Diameter		3.64 92	3.64 92	3.64 92	3.64 92	3.64 92	4.80 122	4.80 122	4.80 122	4.80 122
AB - Handwheel Clearance, (Open)		7.3 185	7.3 185	7.3 185	7.3 185	7.3 185	11.2 284	11.2 284	11.2 284	11.2 284
B - Center to End		6.1 155	6.1 155	6.1 155	6.1 155	6.1 155	8.8 224	8.8 224	8.8 224	8.8 224
E - Center to Top, (Open)		13.4 340	13.4 340	13.4 340	13.4 340	13.4 340	20.0 508	20.0 508	20.0 508	20.0 508
G - Handwheel/Handle Diameter		8.5 216	8.5 216	8.5 216	8.5 216	8.5 216	16.0** 406**	16.0** 406**	16.0** 406**	16.0** 406**
Weight, Welded		43 20	43 20	43 20	43 20	43 20	158 72	158 72	158 72	158 72
Weight, Unwelded		45 21	45 21	45 21	45 21	45 21	162 74	162 74	162 74	162 74

** Impactor Handwheel



Univalve® Piston Check Valves Class 4500 11,250 PSI @ 100°F (775.9 BAR @ 38°C)

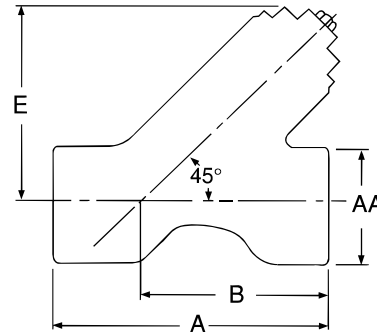
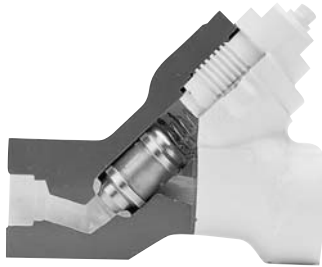

96174

Standard Features

- Available Body Material
 - A105 carbon steel.
 - F22 alloy steel.
 - F91 alloy steel.
 - F316, F347 stainless steel.
 - Other material on application.
- Unwelded (graphitic seal) or welded cover.
- Y-Pattern.
- Body-guided investment cast Stellite disk.
- Integral Stellite seat.
- Stainless steel spring.
(Optional without springs, see page G14.)

Pressure Class 4500 (PN 760)

FIG. NO.		TYPE	ENDS	NPS (DN)
WELDED	UNWELD.			
96174	96274	Y-Pattern	Socket Welding	1/2 (15) thru 2 (50)
96178	96278	Y-Pattern	Buttwelding	1/2 (15) thru 4 (100)

Dimensions - Globe

Bold face numerals are in inches and pounds.

Green numerals are in millimeters and kilograms.

Figure No. 96174, 96178, 96274, 96278	NPS DN	1/2 15	3/4 20	1 25	1-1/4 32	1-1/2 40	2 50	2-1/2 65	3 80	4 100
A - End to End		8.2 208	8.2 208	8.2 208	8.2 208	8.2 208	12.8 325	12.8 325	12.8 325	12.8 325
AA - End Hub Diameter		3.64 92	3.64 92	3.64 92	3.64 92	3.64 92	4.80 122	4.80 122	4.80 122	4.80 122
B - Center to End		6.1 155	6.1 155	6.1 155	6.1 155	6.1 155	8.8 224	8.8 224	8.8 224	8.8 224
E - Center to Top		5.4 137	5.4 137	5.4 137	5.4 137	5.4 137	7.9 201	7.9 201	7.9 201	7.9 201
Weight		35 16	35 16	35 16	35 16	35 16	92 42	92 42	92 42	92 42

Univalve® Angle Stop-Check Valves Class 1690 4225 PSI @ 100°F (291.4 BAR @ 38°C)

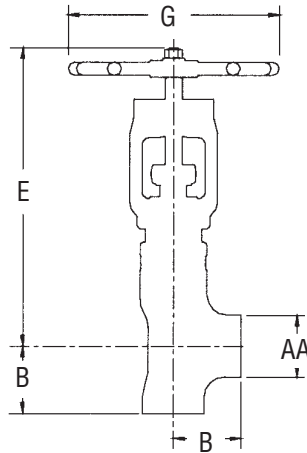

Standard Features

- Available Body Material
 - A105 carbon steel.
 - F22 alloy steel.
 - F91 alloy steel.
 - F316, F347 stainless steel.
 - Other material on application.
- Unwelded (graphitic seal) or Welded Bonnet.
- OS&Y.
- Angle Pattern.
- Body-guided investment cast Stellite disk.
- Integral Stellite seat.
- Integral Backseat.
- Asbestos free graphitic packing.

Pressure Class 1690 (PN 290)

FIG. NO.		TYPE	ENDS	NPS (DN)
WELDED	UNWELD.			
36165	36265	Angle	Socket Welding	1/2 (15) thru 2-1/2 (65)
36169	36269	Angle	Buttwelding	1/2 (15) thru 4 (100)

Dimensions - Angle

Bold face numerals are in inches and pounds.

Green numerals are in millimeters and kilograms.

Figure No. 36165, 36169, 36265, 36269	NPS DN	1/2	3/4	1	1-1/4	1-1/2	2	2-1/2	3	4
		15	20	25	32	40	50	65	80	100
AA - Hub Diameter		2.3 58	2.3 58	2.3 58	3.8 97	3.8 97	3.6 91	4.0 102	4.0 102	4.8 122
B - Center to End		2.5 64	2.5 64	2.5 64	3.6 91	3.6 91	4.1 104	4.5 114	4.5 114	5.3 135
E - Center to Top (Open)		11.7 297	11.7 297	11.7 297	14.9 378	14.9 378	17.3 439	19.1 485	19.1 485	19.7 500
G - Handwheel/Handle Diameter		8.5 216	8.5 216	8.5 216	14.3* 363	14.3* 363	14.3* 363	16.0** 406	16.0** 406	16.0** 406
Weight, Welded		18 8.2	18 8.2	18 8.2	40 18.1	40 18.1	60 27.2	103 46.7	103 46.7	139 63.0
Weight, Unwelded		19 8.6	19 8.6	19 8.6	42 19.1	42 19.1	62 28.1	107 48.5	107 48.5	143 64.9

* Impactor Handle

** Impactor Handwheel

Univalve® Angle Check Valves Class 1690 4225 PSI @ 100°F (291.4 BAR @ 38°C)

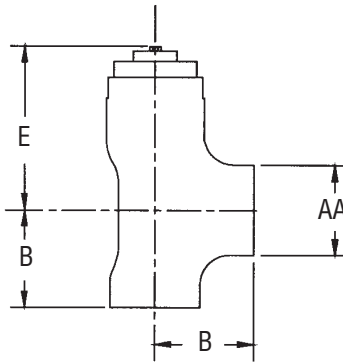

Standard Features

- Available Body Material
 - A105 carbon steel.
 - F22 alloy steel.
 - F91 alloy steel.
 - F316, F347 stainless steel.
 - Other material on application.
- Unwelded (graphitic seal) or Welded Cover.
- Angle Pattern.
- Body-guided investment cast Stellite disk.
- Integral Stellite seat.
- Stainless steel spring.
(Optional without spring, see page G14.)

Pressure Class 1690 (PN 290)

FIG. NO.		TYPE	ENDS	NPS (DN)
WELDED	UNWELD.			
36175	36275	Angle	Socket Welding	1/2 (15) thru 2-1/2 (65)
36179	36279	Angle	Buttwelding	1/2 (15) thru 4 (100)

Dimensions - Angle

Bold face numerals are in inches and pounds.

Green numerals are in millimeters and kilograms.

Figure No. 36175, 36179, 36275, 36279	NPS DN	1/2	3/4	1	1-1/4	1-1/2	2	2-1/2	3	4
		15	20	25	32	40	50	65	80	100
AA - Hub Diameter		2.3 58	2.3 58	2.3 58	3.8 97	3.8 97	3.6 91	4.0 102	4.0 102	4.8 122
B - Center to End		2.5 64	2.5 64	2.5 64	3.6 91	3.6 91	4.1 104	4.5 114	4.5 114	5.3 135
E - Center to Top		4.6 117	4.6 117	4.6 117	5.7 145	5.7 145	6.2 157	7.2 183	7.2 183	7.8 198
Weight		8 3.6	8 3.6	8 3.6	21 9.5	21 9.5	30 13.6	41 18.6	41 18.6	76 34.5

