

PKW OF EXPLOSION PROOF Series (EEx mII T4)

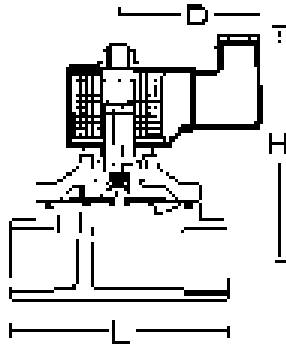

1. **PKW series** is direct multiplex-drive, pilot operated diaphragm, conductive, and normally closed.
(3/8"~1": direct multiplex-drive) (1.1/4"~2": multiplex-drive)
2. Valve body made of Brass.
3. **PKW** can be operated directly without pressure. (3/8"~1")
4. Standard Voltage: 110VAC / 220VAC / 24VDC. (50/60HZ)
5. Screwed end to BSPT. Option screwed: NPT, BSP Thread.
6. Normal working temperature: 80°C (NBR).
Others: Viton (130°C), Silicone (130°C) when requested.
7. AC Voltage tolerance: ± 10%
DC Voltage tolerance: ± 1%
8. **Not apply for fluid of**
 - Liquid status when heat, solid status when cool.
 - Viscosity over 20 cst.
 - Corrosive fluid.

Material

Model	PKW
Body	Brass
Coil	EEx mII T4
Core	ST. ST.
Tube	ST. ST.
Spring	ST. ST.
Plug	NBR, Viton, Silicone
Diaphragm	NBR, Viton, Silicone

Dimension

Model	Pipe Size	Cv	Orifice	Fluid					Dimension (mm)			Wt.		
				Temp °C	Air	Water	Light Oil	Gas	Vacuum	L	H	D	(kg)	
PKW-10	3/8"	2.4	15 mm	-5°C~80°C	0-7	0-5	0-5	0-5	0-5	0-760 Torr	70	100	54	1.05
PKW-15	1/2"	4.5	15 mm	-5°C~80°C	0-7	0-5	0-5	0-5	0-5	0-760 Torr	70	100	54	1.04
PKW-20	3/4"	8.6	20 mm	-5°C~80°C	0-7	0-5	0-5	0-5	0-5	0-760 Torr	73	108	54	1.16
PKW-25	1"	12	25 mm	-5°C~80°C	0-7	0-5	0-5	0-5	0-5	0-760 Torr	100	113	54	1.76
PKW-35	1.1/4"	24	35 mm	-5°C~80°C	0.5-8	0.5-8	0.5-8				130	145	54	3.39
PKW-40	1.1/2"	28	40 mm	-5°C~80°C	0.5-8	0.5-8	0.5-8				130	150	54	3.49
PKW-50	2"	48	50 mm	-5°C~80°C	0.5-8	0.5-8	0.5-8				165	158	54	5.08

SOLENOID VALVE

SKW OF EXPLOSION PROOF Series (EEx mII T4)

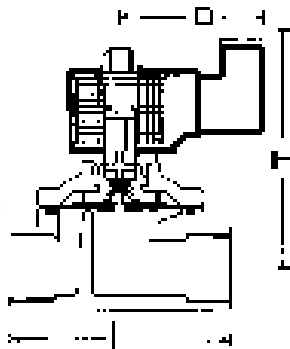

1. **SKW series** is direct multiplex-drive, connected diaphragm, conductive, and normally closed.
2. Valve body made of Investment Casting S/S 316.
3. SKW can be operated directly without pressure.
4. Standard Voltage: 110VAC / 220VAC / 24VDC. (50/60HZ)
5. Screwed end to BSPT. Option screwed: NPT, BSP Thread.
6. Normal working temperature: 80°C (NBR).
Others: Viton (130°C), Silicone (130°C) when requested.
7. AC Voltage tolerance: ± 10%
DC Voltage tolerance: ± 1%
8. **Not apply for fluid of**
 - Liquid status when heat, solid status when cool.
 - Viscosity over 20 cst.
 - Corrosive fluid.

Material

Model	SKW
Body	CF8M
Coil	EEx mII T4
Core	ST. ST.
Tube	ST. ST.
Spring	ST. ST.
Plug	NBR, Viton, Silicone
Diaphragm	NBR, Viton, Silicone

Dimension

Model	Pipe Size	Cv	Orifice	Fluid					Dimension (mm)			Wt.		
				Temp °C	Air	Water	Light Oil	Gas	Vacuum	L	H	D	(kg)	
SKW-15	1/2"	4.5	15 mm	-5°C~80°C	0-7	0-5	0-5	0-5	0-5	0-760 Torr	70	100	54	1.04
SKW-20	3/4"	8.6	20 mm	-5°C~80°C	0-7	0-5	0-5	0-5	0-5	0-760 Torr	76	107	54	1.12
SKW-25	1"	12	25 mm	-5°C~80°C	0-7	0-5	0-5	0-5	0-5	0-760 Torr	100	114	54	1.66