

TRUNNION MOUNTED BALL VALVE BOLTED BODY, CLASS 900 (LEVER OPERATED)

Design Features

- Side entry
- Blow out proof stem
- Soft & metal - metal seats
- Gear operated from 6" and up starting from Class 900 #
- Three piece forged body design
- Bleed valve
- Fire safe packing
- Lifting lugs
- Heavy wall thickness
- Secondary seat injection sealant
- Draining plug



Catalog Figure No.	Type of Ends
8912	Raised Face (RF)
8913	Ring Type Joint (RTJ)
8914	Buttweld (WE)

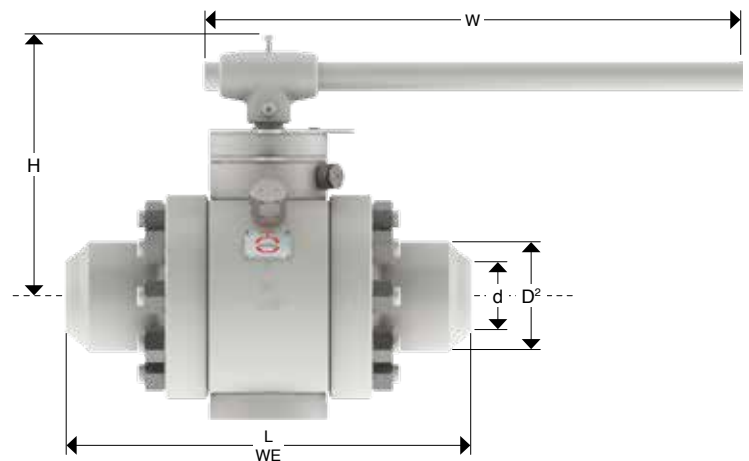
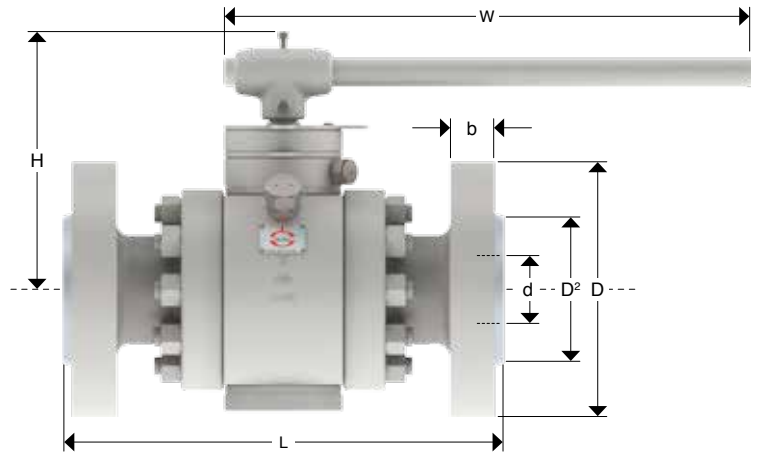

Dimensions and Weights

Nominal Diameter	mm	50	65	80	100
	in	2"	2 1/2"	3"	4"
d	mm	49	62	74	100
	in	1.93	2.44	2.91	3.94
D	mm	216	244	241	292
	in	8.50	9.61	8.27	11.50
D2	mm	92	105	127	157
	in	3.62	4.13	5	6.18
b	mm	38.5	41.5	38.5	44.5
	in	1.52	1.63	1.26	1.75
L	mm	368	419	381	457
	in	14.50	16.50	14.02	18
L (WE)	mm	368	419	381	457
	in	14.50	16.50	14.02	18
H	mm	213	220	220	275
	in	8.37	8.68	8.68	10.84
ØW	mm	700	800	800	POA
	in	27.56	23.62	27.56	
Weight (RF - RTJ)	kg	57	75	83	146
	Lb	126	165	183	322

Key Parameters

Code	Name
d	Bore diameter
D	Flange diameter
D2	Raised face diameter
b	Flange thickness
L	Raised face and ring type joint face to face
L (WE)	Welded end face to face
H	Height
ØW	Handwheel diameter
Weight	Weight