

API 602 BELLOW-SEAL GATE VALVES

FORGED CARBON, STAINLESS STEEL OR ALLOY STEEL

1/2" - 2" (13 - 50mm), ASME CLASS 800

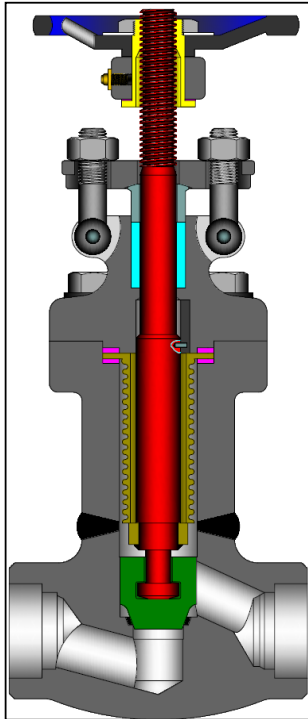

DESIGN FEATURES:

- Standard trim is API trim 12 with 316Ti bellows.
- Stems of hand wheel operated design are rotating / rising design.
- Each valve is shell, seat and backseat pressure tested per industry standard API 598.
- Other Bellows material options are available. Bellows are hydro-formed rather than welded.
- Other available options as follows:
 - » Alternate valve materials such as chrome and stainless steel alloys
 - » Alternate trim materials
 - » NACE service
 - » Special cleaning for applications such as oxygen or chlorine
 - » Other options available as specified

Class	Fig. No.
800	BL08

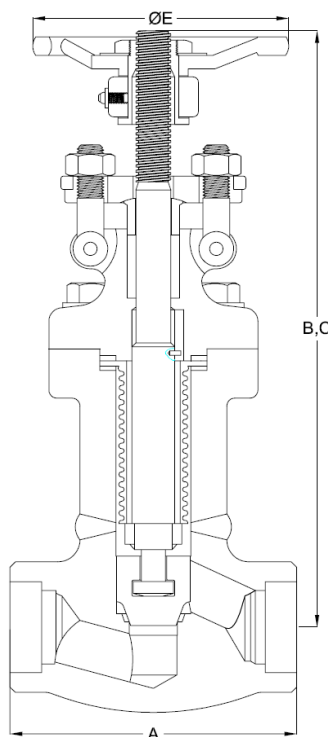

Design Specifications

Item	Applicable Specification
Wall thickness	API 602
Pressure - temperature ratings	ASME B16.34 & API 602
General valve design	API 602 & B16.34
End to End dimensions	ASME B16.10
Thread design	ASME B1.20.1
Socket Weld design	ASME B16.11
Materials	ASTM

THREADED AND CLASS 150-600
FLANGED ENDS AVAILABLE.

B = Center to top closed
C = Center to top open

STANDARD MATERIALS (Other materials available)

PART	MATERIALS	
Body	A105 + Stellite 6 Faced	A182 F316L + Stellite 6 Faced
Bonnet	A105	A182 F316
Disc	A182 F316	
Stem	A182 F316	
Bellows	316Ti	
Gland Flange	A105	A182 F316
Eye Bolt	A193 Gr. B7	A193 Gr. B8M
Eye Bolt Nut	A194 Gr. 2H	A194 Gr. 8M
Gland	Series 300 SST	
Packing	Graphite	
Gasket (2)	Spiral Wound SST with Graphite	
Hand Wheel	Malleable Iron or Steel	
Hand Wheel Nut	Malleable Iron or Steel	
Body / Bonnet Bolting (2)	A193 Gr. B7	A193 Gr. B8M
Identification Plate	Series 300 SST	

SIZE	ASME 800			
in	A	B	C	E
mm				
1/2	3.11	8.2	8.5	3.9
13	79	209	217	100
3/4	3.62	8.2	8.5	3.9
19	92	209	217	100
1	4.37	9.8	10.1	4.9
25	111	248	257	125
1 1/4	4.72	11.6	12.1	6.3
32	120	295	307	160
1 1/2	5.98	11.6	12.1	6.3
38	152	295	307	160
2	6.77	13.2	13.7	7.1
50	172	336	349	180

ADDITIONAL SIZES, MATERIALS AND CLASSES AVAILABLE UPON REQUEST.

2503 Spring Grove Avenue, Cincinnati, OH 45214 • 800.888.2583 • www.powellvalves.com