

# WALWORTH INDUSTRIAL BRONZE RS GATE VALVE CLASS 150 (300 WOG)

## DESIGN FEATURES

- Design in accordance with MSS SP-80
- Rising Stem
- Bronze construction
- Integral seat rings
- Screwed bonnet design
- Threaded ends as per ANSI B1.20.1
- Face to face dimensions as per WALWORTH design
- Handwheel operated

CATALOG FIGURE NO.	TYPE OF ENDS
W56	Threaded Ends

## REGULAR BILL OF MATERIALS

NO.	DESCRIPTION	MATERIALS
1	Body	Bronze B62
2	Bonnet	Bronze B62
3	Disc	Bronze B62
4	Stem Packing	Non Asbestos
5	Gland	Brass B16
6	Packing Nut	Bronze B62
7	Stem	Bronze B62
8	Handwheel	Ductile Iron A536
9	Handwheel nut	Galvanized Steel

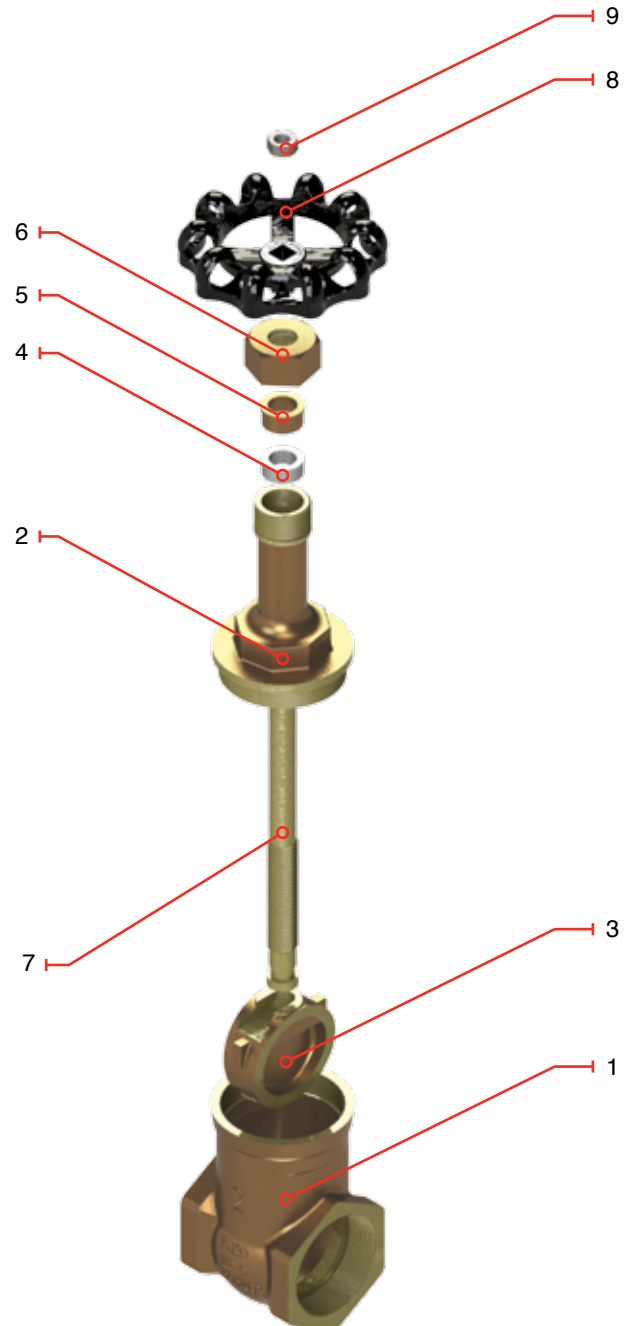

# **WALWORTH INDUSTRIAL BRONZE RS GATE VALVE** **CLASS 150 (300 WOG)**

## **DESIGN FEATURES**

- Design in accordance with MSS SP-80
- Rising Stem
- Bronze construction
- Integral seat rings
- Screwed bonnet design
- Threaded ends as per ANSI B1.20.1
- Face to face dimensions as per WALWORTH design
- Handwheel operated

CATALOG FIGURE NO.	TYPE OF ENDS
W56	Threaded Ends

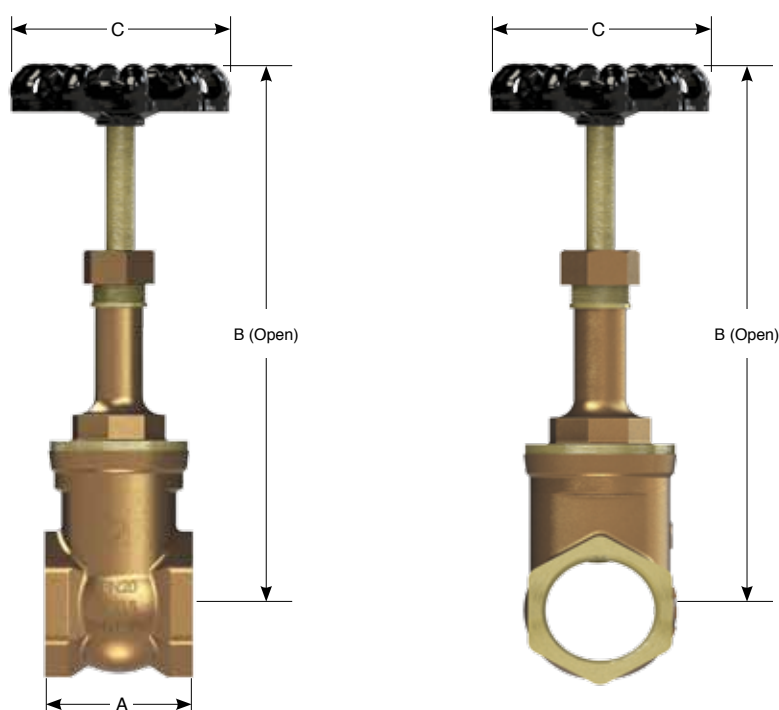

## **DIMENSIONS AND WEIGHTS**

D NOMINAL DIAMETER	mm	13	19	25	30	40	50
	in	1/2"	3/4"	1"	1 1/4"	1 1/2"	2"
A	mm	48	51.81	59.18	64	68.32	73.66
	in	1.89	2.04	2.33	2.52	2.69	2.9
B	mm	118.11	140.97	169.67	200.02	225.93	276.86
	in	4.65	5.55	6.68	7.87	8.89	10.9
C	mm	50.8	63.5	66.54	76.2	82.55	91.94
	in	2	2.5	2.62	3	3.25	3.62
Weight W56	kg	0.38	0.60	0.82	1.14	1.46	2.50
	in	0.83	1.32	1.80	2.5	3.21	5.5
Cv	Flow coefficient	16.08	37.6	69.7	111.36	164.13	306.76