

# WALWORTH INDUSTRIAL BRONZE RS GATE VALVE UNION BONNET, CLASS 200 (400 WOG)

## DESIGN FEATURES

- Design in accordance with MSS SP-80
- Rising Stem
- Bronze construction
- Integral seat rings
- Union Bonnet Design
- Threaded ends as per ANSI B1.20.1
- Face to face dimensions as per WALWORTH design
- Handwheel operated

CATALOG FIGURE NO.	TYPE OF ENDS
W36	Threaded Ends

## REGULAR BILL OF MATERIALS

NO.	DESCRIPTION	MATERIALS
1	Body	Bronze B61
2	Bonnet	Bronze B61
3	Disc	Bronze B61
4	Union Ring	Bronze B62
5	Stem Packing	Non Asbestos
6	Gland	Brass B16
7	Packing Nut	Bronze B61
8	Stem	Bronze B584
9	Handwheel	Ductile Iron A536
10	Handwheel nut	Galvanized Steel

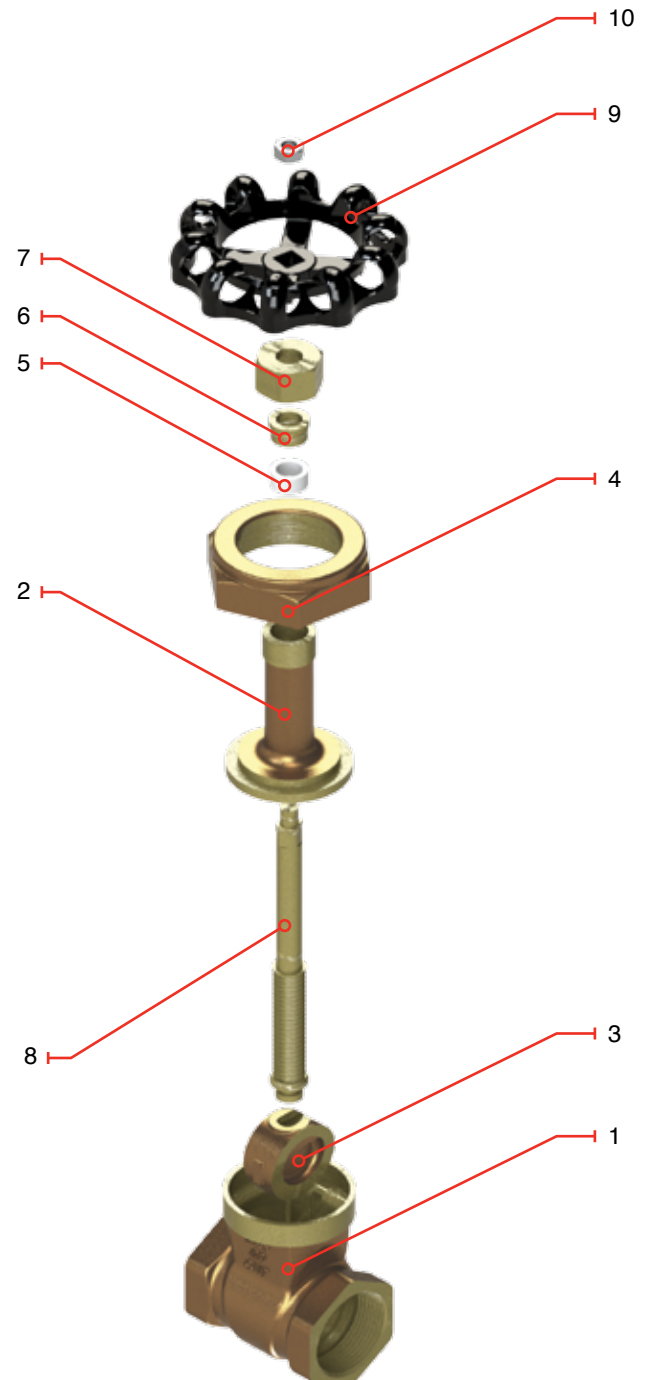

# **WALWORTH INDUSTRIAL BRONZE RS GATE VALVE** **UNION BONNET, CLASS 200 (400 WOG)**

## **DESIGN FEATURES**

- Design in accordance with MSS SP-80
- Rising Stem
- Bronze construction
- Integral seat rings
- Union Bonnet Design
- Threaded ends as per ANSI B1.20.1
- Face to face dimensions as per WALWORTH design
- Handwheel operated

CATALOG FIGURE NO.	TYPE OF ENDS
W36	Threaded Ends

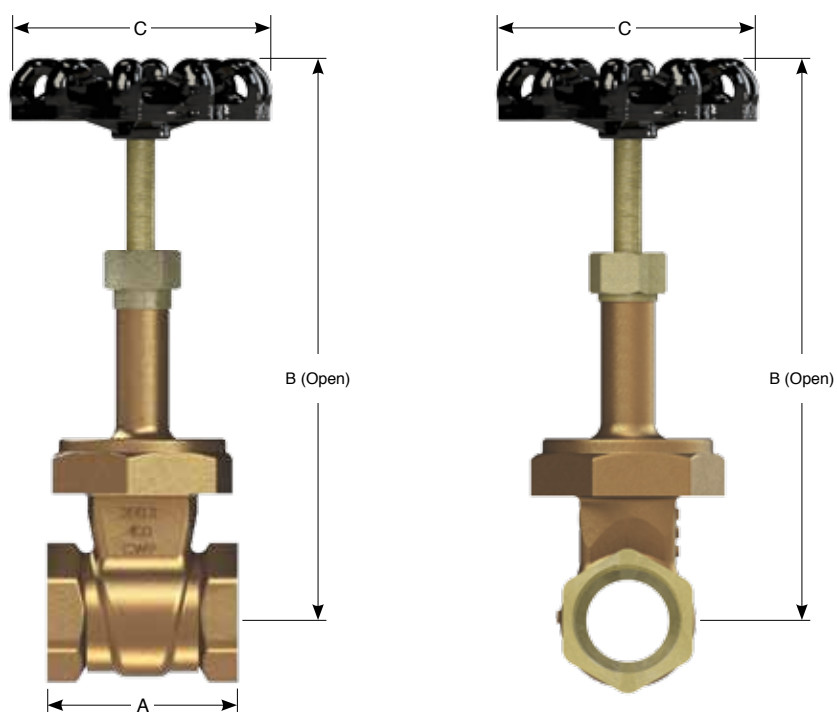

## **DIMENSIONS AND WEIGHTS**

D NOMINAL DIAMETER	mm	13	19	25	30	40	50
	in	1/2"	3/4"	1"	1 1/4"	1 1/2"	2"
A	mm	60.9	57.78	65.40	76.2	83.82	86.86
	in	2.4	2.27	2.57	3	3.3	3.42
B	mm	134.62	159.06	183.51	219.07	244.47	298.45
	in	5.3	6.26	7.22	8.62	9.62	11.75
C	mm	50.8	63.5	66.54	76.2	82.55	91.94
	in	2.25	2.5	2.75	3.25	3.62	4
Weight W36	kg	1,40	2,10	2,60	4,00	6,20	9,60
	lb	3.08	4.62	5.72	8.8	13.64	21.12
Cv	Flow coefficient	16.08	37.6	69.7	111.36	164.13	306.76