

FLUSH BOTTOM VALVES

SERIES 9000 & 9100



FOREWORD

Dembla manufactures **Series 9100 Flush Bottom Valves** for processed material discharging applications. These valves are mounted on the bottom most portion or at the outlet of vessels, tanks, etc.

These valves are more popular in batch industries or pharmaceutical industries.

Valve sizes are designated by two numerals, First number stands for size of inlet flange connection that is fixed to the tank or vessel bottom pad, Second number stands for port size as well as outlet pipe and its flange size. Inlet flanges are always one size larger in size than the outlet flanges.

The outlet flange is inclined 45° to the axis of the valve.

CONSTRUCTION

Valves are available in two types of constructions.

While opening

- Plug protrudes into vessel.
- Plug retracts into body.

FEATURES

Body internal construction provides resistance free flow path.

The plug and guide bush have been designed to avoid accumulation of flowing material at the guide bush area in all conditions of plug movement.

Whenever fluids that tend to solidify at lower temperature are to be discharged in hot conditions to avoid their solidification within the valve, the bodies are provided with **OIL / HOT WATER / STEAM JACKETING** arrangements.

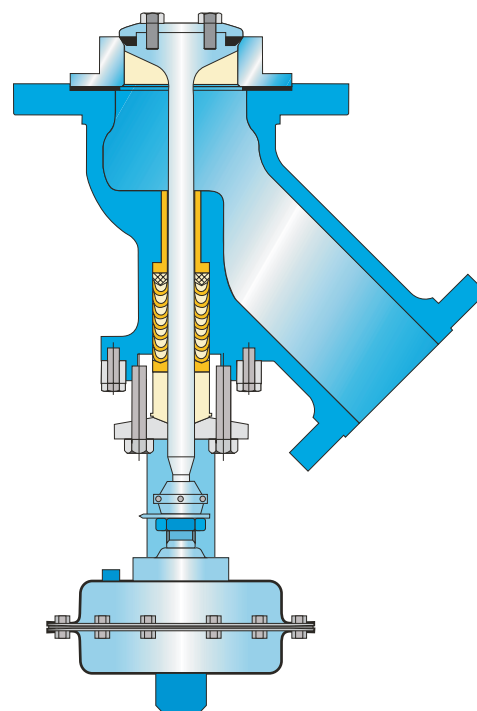

PLUG PROTRUDES
INTO VESSEL

SERIES 9000

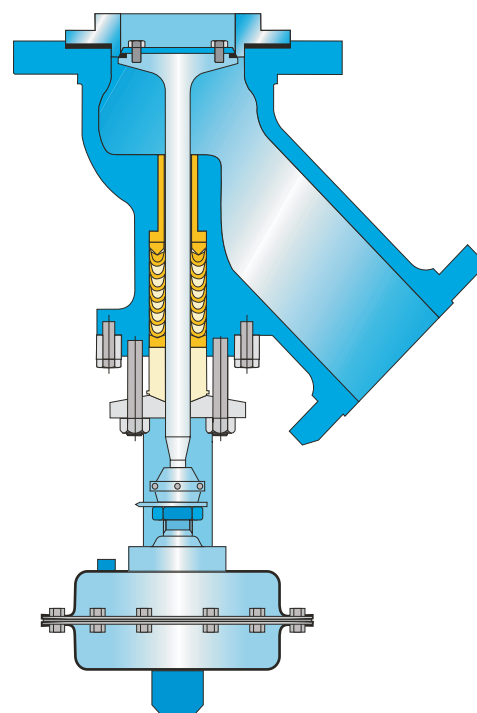

PLUG RETRACTS
INTO BODY

SERIES 9100

SPECIFICATIONS

Sizes (Inch) (mm)	:	1 ½ x 1 40 x 25	2 x 1 ½ 50 x 40	2 ½ x 2 65 x 50	3 x 2 ½ 80 x 65	4 x 3 100 x 80	6 x 4 150 x 100	8 x 6 200 x 150
Ratings	:	ANSI 150#, Equivalent in BS and DIN ANSI 300# available on request						
End Connection	:	Flanged with Raised face with facing 125-250 AARH smooth						
Valve Body MOC	:	Carbon Steel ASTM A 216 Gr. WCB Stainless Steel ASTM A 351 Gr. CF8M All Other Grades available on request						
Trim MOC	:	SS 316 + P.T.F.E. as Standard All Other Materials available on request						
Gland Packing	:	V-Teflon - 150 to +200°C Grafoil - 150 to +600°C						
Leakage Rate	:	As per ANSI / FCI 70-2 Class VI (with Soft Facing) Tight Shutoff Class V (With Metal to Metal Seating)						
Flow Characteristics	:	On-Off (Regulating Duty available on request)						
Plug Construction	:	Disc Type						
Temperature Range	:	-150 to +600° C						
Actuators	:	Diaphragm Pneumatic Type as Standard Single Acting / Double Acting Cylinder available on request						
Manual Overrides	:	Top Mounted Version						
Accessories	:	Air Filter Regulators, Solenoid Valves, Limit/Proximity Switches, Air Lock Relays, Volume Boosters & Quick Exhaust Valves etc.						

VALVE BODY SET

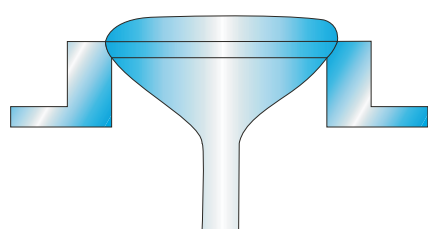

METAL TO METAL SEATING

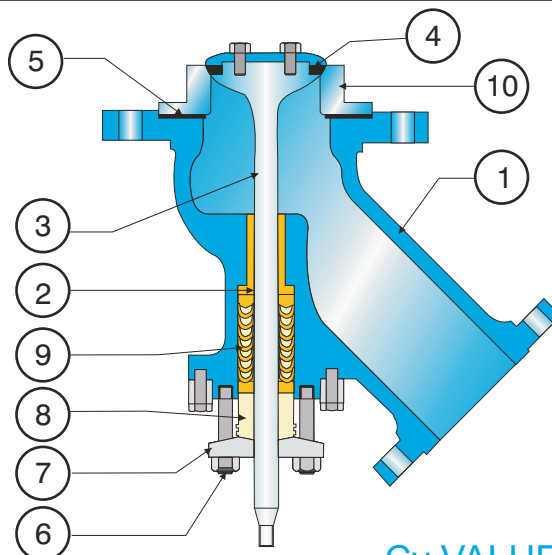

MATERIAL OF CONSTRUCTION

SR. NO.	PART	MATERIAL OF CONSTRUCTION	
1	Valve Body	A216 Gr. WCB	A351 Gr. CF8M
2	Guide Bush	SS 410 Heat Treated	SS 316 Hard Chrome Plated
3	Plug cum Valve Stem	SS 316	
4	Soft Facing	P.T.F.E.	
5	Gasket : Body to Seat Ring	P.T.F.E. / Graphite	
6	Packing Stud Nuts	SS 304	
7	Gland Flange	SS 316	
8	Gland Bush	SS 316	
9	Gland Packing	V - Teflon / Grafoil	
10	Seat Ring	SS 316	

Cv VALUES

VALVE SIZES		Cv USGPM
INCH	MM	
1 ½ x 1	40 x 25	13
2 x 1 ½	50 x 40	30
2 ½ x 2	65 x 50	50
3 x 2 ½	80 x 65	80
4 x 3	100 x 80	110
6 x 4	150 x 100	200
8 x 6	200 x 150	400

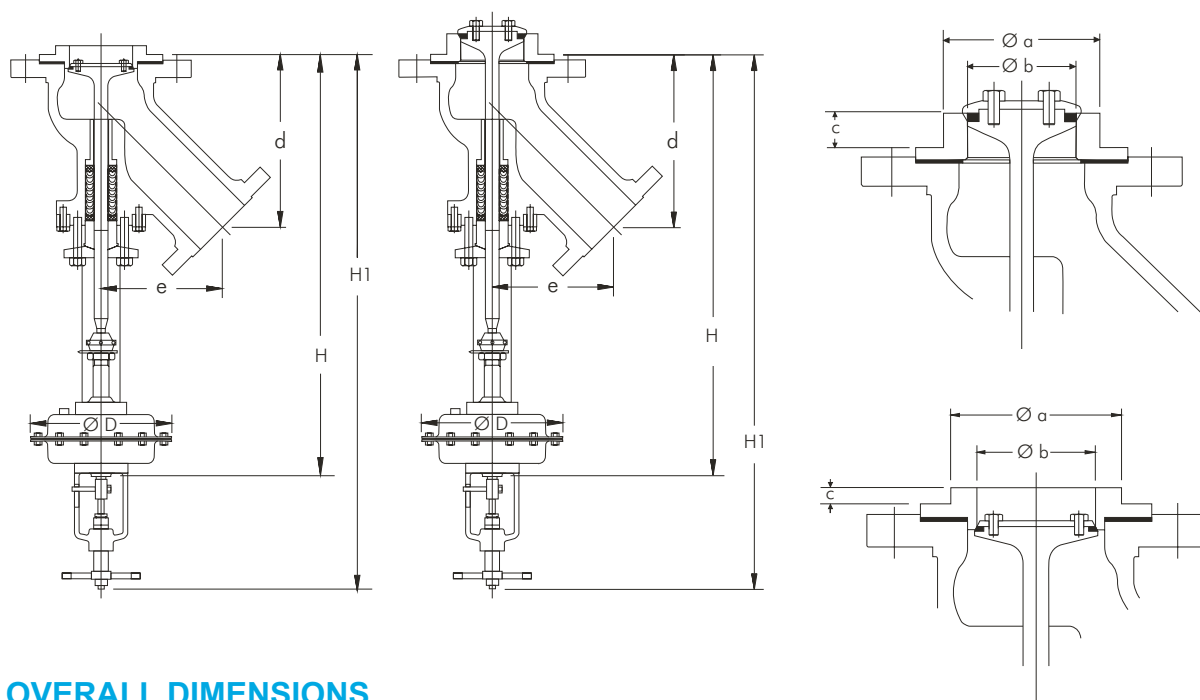

OVERALL DIMENSIONS

VALVE SIZES		ACTUATOR MODEL	Øa	Øb	c	d	e	H WITHOUT HANDWHEEL	H1 WITH TMH	ØD
INCH	MM									
1 ½ x 1	40 x 25	DM-00	39	25	40	117.5	84	451	672	240
2 x 1 ½	50 x 40	DM-00	49	40	40	154.5	117	486	707	240
		DM-01	49	40	40	154.5	117	500	722	290
2 ½ x 2	65 x 50	DM-00	64	50	40	179.5	124	511	732	240
		DM-01	64	50	40	179.5	124	525	747	290
3 x 2 ½	80 x 65	DM-11	79	65	40	197.5	140	543	765	290
		DM-12	79	65	40	197.5	140	605	880	380
4 x 3	100 x 80	DM-11	99	80	40	214.5	145	570	794	290
		DM-12	99	80	40	214.5	145	622	909	380
6 x 4	150 x 100	DM-11	149	100	45	207.5	159	563	787	290
		DM-12	149	100	45	207.5	159	615	902	380
8 x 6	200 x 150	DM-11	199	150	45	252.5	183	608	832	290
		DM-12	199	150	45	252.5	183	660	947	380



Dembla

SALES (INTERNATIONAL) OFFICE ADDRESS :

M/S Dembla Valves Ltd (Unit 2)
C-30, Jai Matadi Compound, Kalher Village
Thane-Bhiwandi-Agra Road-421302, Maharashtra, India.
Tel : 912522 275132 / 275184 / 275104 / 241700
Fax: 912522 275132 / 275184 / 275104
E-Mail: expo@dembla.com

SALES (DOMESTIC) HEAD OFFICE & CORRESPONDENCE ADDRESS

M/S Dembla Valves Ltd.
1-Adarsha Industrial Estate Pokhran Road No.1,
Upvan, Thane – 400 606 (Maharashtra), India.
Tel (O): 022 - 25858234/25853957/25853899
Fax: 022 - 25853429
E-Mail: info@dembla.com

REG. OFFICE & WORKS :

Unit 1 : Purna Village Thane - Bhiwandi - Agra Road, Dist : Thane - 421 302, Maharashtra, India
Unit 2 : C-30, Jai Matadi Compound, Kalher Village, Thane-Bhiwandi-Agra Road - 421302, Maharashtra, India